



9 Whittle Court,  
Knowlhill, Milton Keynes, MK5 8FT

Tel: 01908 231 551



mail@elevationstateagents.com



**163 High Street, Stony Stratford, Milton  
Keynes, Buckinghamshire, MK11 1AT**

**£249,995 Freehold**

- Two bedroom
- Mid terrace house
- Victorian character property
- Highly sought after market town of Stony Stratford
- Downstairs bathroom
- Enclosed rear garden
- Good transport links
- Ideal buy to let or first time purchase
- Chain Free
- EPC Rating



See our full selection of properties online at [www.elevationstateagents.com](http://www.elevationstateagents.com)



## **GROUND FLOOR**

### **Entrance Hall**

Doors leading to:

### **Lounge Diner**

### **Kitchen**

### **Family Bathroom**

Fitted to comprise three piece suite

## **FIRST FLOOR**

### **Landing**

Doors leading to:

### **Bedroom One**

### **Bedroom Two**

## **EXTERIOR**

### **Rear Garden**

### **Disclaimer**

Whilst we have endeavoured to prepare our sales particulars accurately none of the services, appliances or equipment have been tested. A buyer should satisfy themselves on such matters prior to purchase. Any measurements or distances mentioned in these particulars are for guide reference only. If such particulars are fundamental to a purchase, buyers should rely on their own enquiries. All enquiries should be directed to Elevation Estate Agents in the first instance.



## Ground Floor



## First Floor

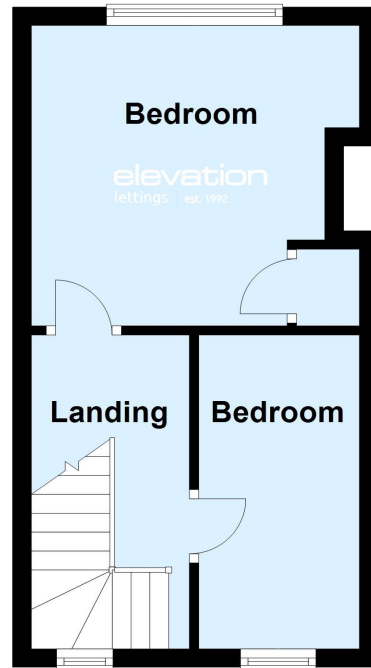

Floor plans are for layout purposes only. Measurements are approximate and subject to inaccuracies  
Plan produced using PlanUp.