

Milburys

SALES LETTING MANAGEMENT



Bylanes, Sandy Lane, Aust, South Gloucestershire, BS35 4AU

£465,000

Ground Floor

Approx. 94.8 sq. metres (1020.8 sq. feet)



Double Garage

Approx. 37.8 sq. metres (406.9 sq. feet)

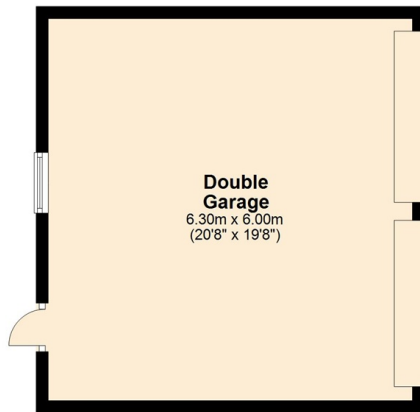

First Floor

Approx. 37.8 sq. metres (407.1 sq. feet)

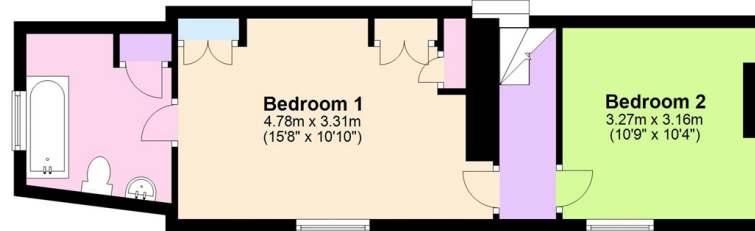

Total area: approx. 170.5 sq. metres (1834.8 sq. feet)

For Illustrative Purposes Only. Not to Scale.
Plan produced using PlanUp.



Bylanes, Sandy Lane, Aust, South Gloucestershire BS35 4AU

What a charming and unexpectedly spacious home! Bylanes is a substantial detached cottage enjoying a beautifully tended garden complete with a summer-house, plus a double garage and off-street parking at the far end. Stepping inside you will find a dual-aspect lounge with a feature fireplace, the sitting room/ground floor bedroom 3 which has a wood-burning stove, a separate dining room, the kitchen/breakfast room with plenty of space for a table, chairs and a stable door to the garden, plus a smart ground-floor shower room. Upstairs there are two generous double bedrooms, one with an en-suite bathroom! Everything is spick and span and a credit to the current owner. The windows are double-glazed and heating is oil-fired. If you are looking for something a little bit different with a versatile layout, then this could be just the place for you!

Situation

The village of Aust lies to the south of the M48 & the Severn Bridge, with a convenient motorway junction right on the doorstep connecting to the M4 & M5 at Almondsbury. Historically the lane through the village led to the ferry across the River Severn, immortalised in the famous picture of Bob Dylan waiting for the "Severn Princess" in 1966. The village has a fine old pub, The Boar's Head and an ancient church. The neighbouring village of Olveston has a range of shops and a popular primary school. The nearest secondary school is Marlwood at Alveston - www.marlwood.co.uk - 4 miles to the east, in the direction of the market town of Thornbury.

Property Highlights, Accommodation & Services

- Delightful Character Cottage
- Detached - Village Location
- Good Access To M48 And A403 To Bristol
- Generous Cottage Gardens - Double Garage With One Electric Roller-Door And One Up-And-Over
- Off-Street Parking - Covered Work Area/Car-Port
- Entrance Hall - Dual-Aspect Lounge With Feature Fireplace - Sitting Room/Bedroom 3 With Period Fireplace
- Fitted Kitchen/Breakfast Room With Stable Door And Window Overlooking Garden
- Ground Floor Shower Room - Two Double Bedrooms - En-Suite Bathroom
- Oil Central Heating - Double-Glazing

Directions

From the roundabout at Aust Services take the A403 southwards. The first turning left is into Aust Village. Follow the lane into the village turning left at the chapel. Bylanes is the first property on the left. Drive past the cottage and parking is at the far end of the garden.

Local Authority & Council Tax - South Gloucestershire Council - Tax Band E

Additional Information - South Gloucestershire Council, Civic Centre, High Street, Kingswood BS15 9TR Tel: 01454 868009 - www.southglos.gov.uk

Contact & Viewing - Email: thornbury@milburys.co.uk Tel: 01454 417336

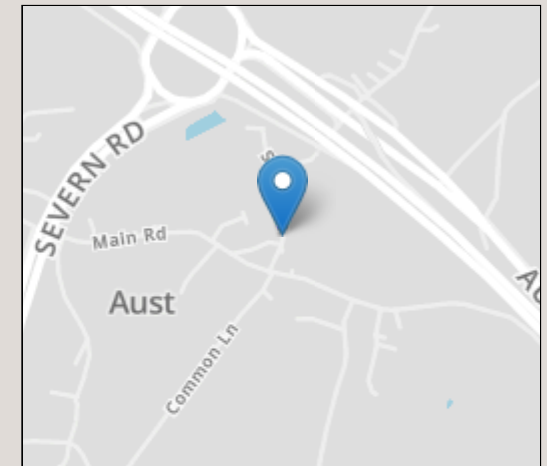
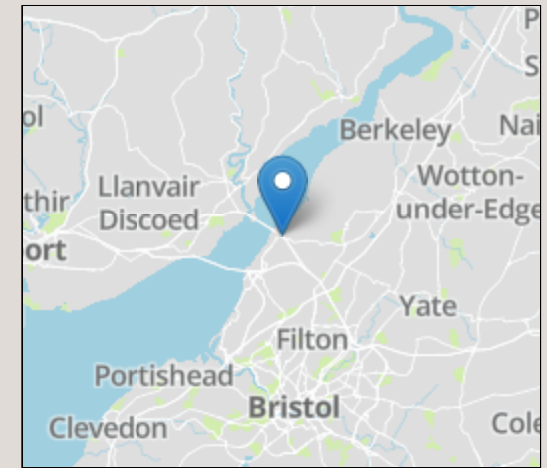

Energy Efficiency Rating		Current	Potential
Very energy efficient - lower running costs			
(92+)	A		
(81-91)	B		
(69-80)	C		77
(55-68)	D		
(39-54)	E	52	
(21-38)	F		
(1-20)	G		
Not energy efficient - higher running costs			
England, Scotland & Wales		EU Directive 2002/91/EC	

IMPORTANT NOTICE Milburys Estate Agents Ltd, their clients and any joint agents give notice that they have not tested any apparatus, equipment, fixtures, fittings, heating systems, drains or services and so cannot verify they are in working order or fit for their purpose. Interested parties are advised to obtain verification from their surveyor or relevant contractor. Statements pertaining to tenure are also given in good faith and should be verified by your legal representative. Digital images may, on occasion, include the use of a wide angle lens. Please ask if you have any queries about any of the images shown, prior to viewing. Where provided, floor plans are shown purely as an indication of layout. They are not scale drawings and should not be treated as such. Complete listings and full details of all our properties (both for sale and to let) are available at www.milburys.co.uk



