

## Coneybear Point, Peartree Way, London. £525,000 SE10 0JW.

Stunning and very spacious two bedroom, two bath apartment in the highly sought after new build situated in Greenwich Millennium Village. Comprising a sleek gloss kitchen with superb quality integrated appliances, luxury tiled and oak flooring and chic contemporary décor. Every aspect of this interior has been carefully selected to create stylish, elegant spaces inspired by modern living.

The development is located a short walk from North Greenwich tube station (Jubilee Line), the Emirates Cable Cars and the O2 with the many attractions within, including bars and restaurants. It is also within walking distance to Sainsburys, Aldi, Asda and Ikea. The development is also home to an excellent primary school, nursery and Eco park. Further benefits include concierge services, excellent transport links and located moments from the O2 Arena.

Viewing by appointment with 1st avenue.

**Call: 020 8293 8600**

1st avenue, 128 Metcalfe Court, West Parkside, London SE10 0EL  
email: [info@1stavenue.co.uk](mailto:info@1stavenue.co.uk)

# Flat 20, 10 Coneybear Point, Peartree Way, London, . SE10 0JW.

£525,000

**1stavenue**  
Real Estate Services

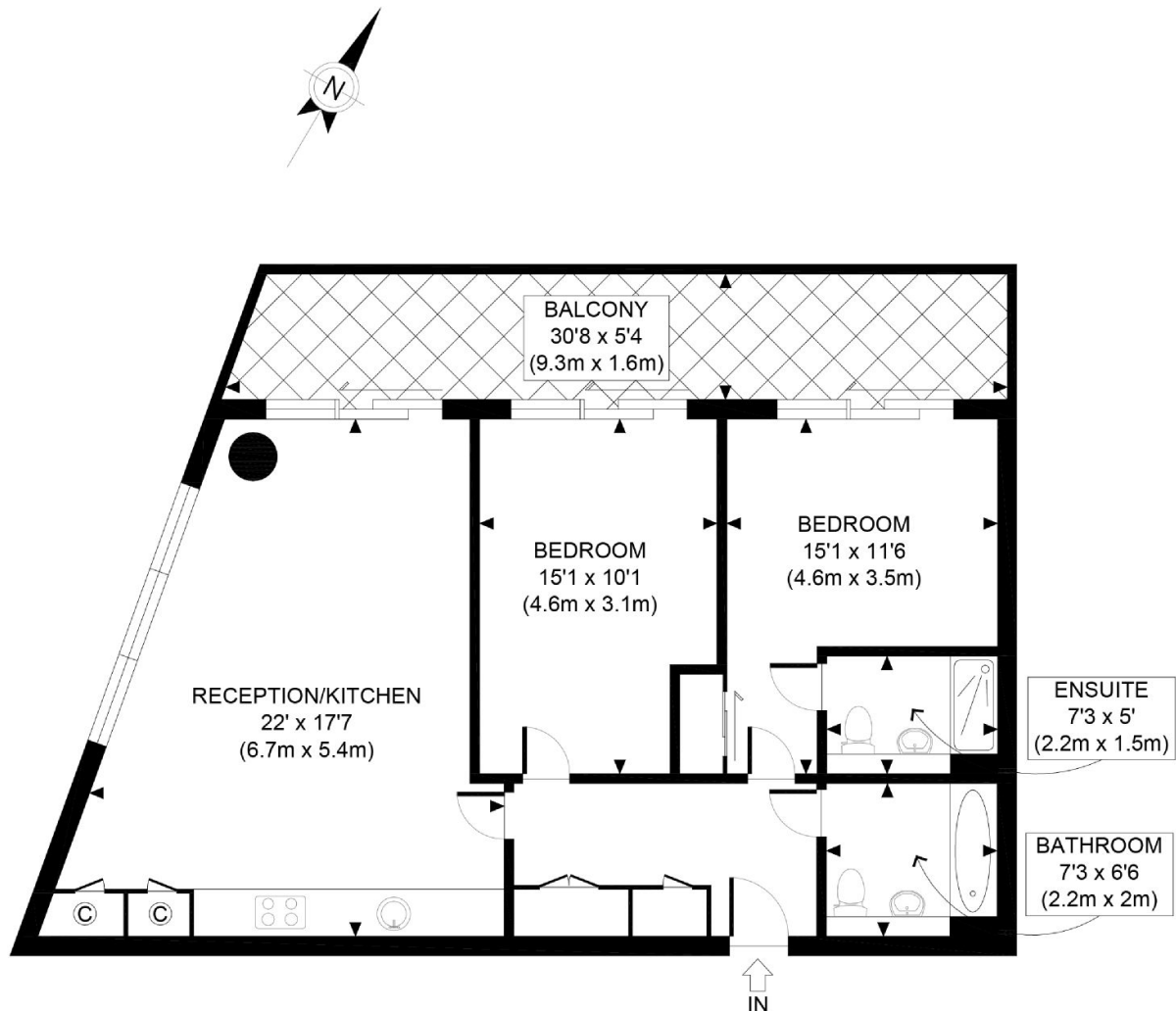

SEVENTH FLOOR  
GROSS INTERNAL  
FLOOR AREA 808 SQ FT

APPROX. GROSS INTERNAL FLOOR AREA 808 SQ FT / 75 SQM

Ref:

Copyright **photoplan** 

Disclaimer: Floor plan measurements are approximate and are for illustrative purposes only. While we do not doubt the floor plan accuracy and completeness, you or your advisors should conduct a careful, independent investigation of the property in respect of monetary valuation

Viewing by appointment with 1st avenue.

**Call: 020 8293 8600**

1st avenue, 128 Metcalfe Court, West Parkside, London SE10 0EL  
email: [info@1stavenue.co.uk](mailto:info@1stavenue.co.uk)

**1stavenue**  
Real Estate Services