



Weston Way, Baldock, Hertfordshire. SG7 6JG





2 Bedroom Apartment £270,000 Leasehold

Built in 2009 is this stunning first floor two double bedroom apartment. Situated in this ideal location, the property boasts comfortable and modern living. Inside are two double bedrooms, a stylish kitchen and bathroom. Outside is allocated parking for one car. The property is offered on a chain free basis.

- Two bedrooms
- Modern apartment
- Chain free
- Allocated parking
- First floor
- Rarely available
- Ideal location
- EPC rating B. Council tax band C

General Description

Entrance:

Via communal front door. Stairs to first floor.

Front Door:

Leading to:

Hallway:

Fitted carpet. Doors to:

Living Room:

Abt. 16' 0" x 11' 3" (4.88m x 3.43m) Double glazed window to side aspect. Fitted carpet. Radiator. Opens to kitchen.

Kitchen:

Abt. 7' 9" x 7' 0" (2.36m x 2.13m) Range of fitted wall and base units. Over head extractor fan. Plumbing for washing machine. Stainless steel sink and drainer. Lino flooring. Double glazed window to front aspect.

Bedroom One:

Abt. 12' 0" x 11' 0" (3.66m x 3.35m) Double glazed window to rear aspect. Fitted carpet. Radiator. Built in wardrobe.

Bedroom Two:

Abt. 11' 3" x 9' 0" (3.43m x 2.74m) Double glazed window to front aspect. Fitted carpet. Radiator.

Bathroom:

Abt. 8' 0" x 7' 0" (2.44m x 2.13m) Suite comprising panelled bath, low level wc and pedestal wash hand basin. Towel rail. Lino flooring.

External Outside:

Allocated parking for one car.



These particulars are a guide only and do not constitute an offer or a contract. The floor plan is for identification purposes only and not to scale. All measurements are approximate and should not be relied upon if ordering furniture, white goods and flooring etc. We have presented the property as we feel fairly describes it but before arranging a viewing or deciding to buy, should there be anything specific you would like to know about the property please enquire. Satchells have not tested any of the appliances or carried out any form of survey and advise you to carry out your own investigations on the state, condition, structure, services, title, tenure, and council tax band of the property. Some images may have been enhanced and the contents shown may not be included in the sale. Satchells routinely refer to 3rd party services for which we receive an income from their fee. If you would like us to refer you to one of these services please ask one of our staff who will pass your details on. We advise you check the availability of the property on the day of your viewing.

First Floor

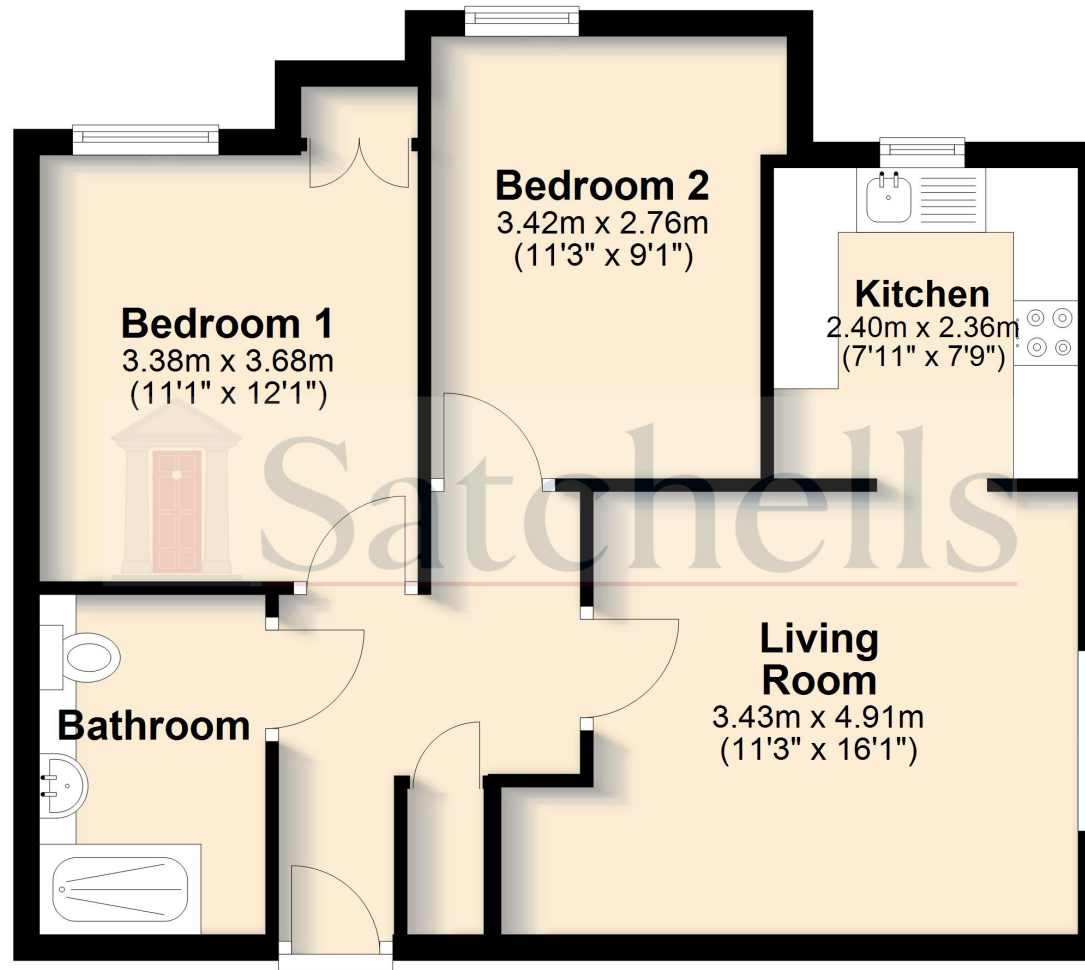

For illustrative purposes only - NOT TO SCALE - Measurements shown are approximate. The size and position of doors, windows, appliances and other features are approximate.
Plan produced using PlanUp.