

FOR SALE

£400,000 Freehold



**47 Prospect Road, Cheshunt,
Hertfordshire. EN8 9RA**

ABOUT THE PROPERTY

Woodhouse are pleased to offer this family home situated in an ever-desirable neighbourhood of Cheshunt. Offered with a CLOSED onward chain, meaning you can move in as soon as your solicitor allows! The current family have loved living in here but they are ready to move into their next home.

Upon entrance you are greeted with a bright Through-Lounge, and to the rear there is the Kitchen & the Family Bathroom. You have access to the Garden from both the kitchen as well as the French doors from the dining area. To the 1st floor there are the 3 x Bedrooms, with the main bedroom overlooking the garden.

Externally to the rear there is the large and secluded Garden offering plenty of flowers and greenery, as well as being virtually South-facing - therefore plenty of natural daylight incoming.

Prospect Road is popular with families due to its ideal location. There are desirable schools nearby (including the highly-regarded Burleigh School which is just a stone's throw away). The shops & eateries of the High Street and the Old Pond are at hand, and within walking distance there is also Cheshunt Station which takes you straight into Liverpool St in 20 minutes. Further transport links include the A10 and M25, both within minutes' drive. And finally Brookfield Centre's shops / eateries are in walking distance, as is Lea Valley Nature Reserve for walks and bike rides.

Contact Woodhouse today to discuss further and arrange a viewing to see for yourself what this home has to offer you and your family! Viewings available 7 days a week.

FEATURES

- CLOSED onward chain
- 3 Bedrooms
- Through-Lounge
- Downstairs Bathroom
- Large South-facing Garden
- Ideal for any First-Time Buyer / young family
- Highly desirable neighbourhood
- Amenities of Old Pond & Brookfield at hand
- Stone's throw from great schooling
- Walking distance to Cheshunt Station
- Viewings 7 days a week



ROOM DESCRIPTIONS



FLOORPLAN

GROUND FLOOR

1ST FLOOR

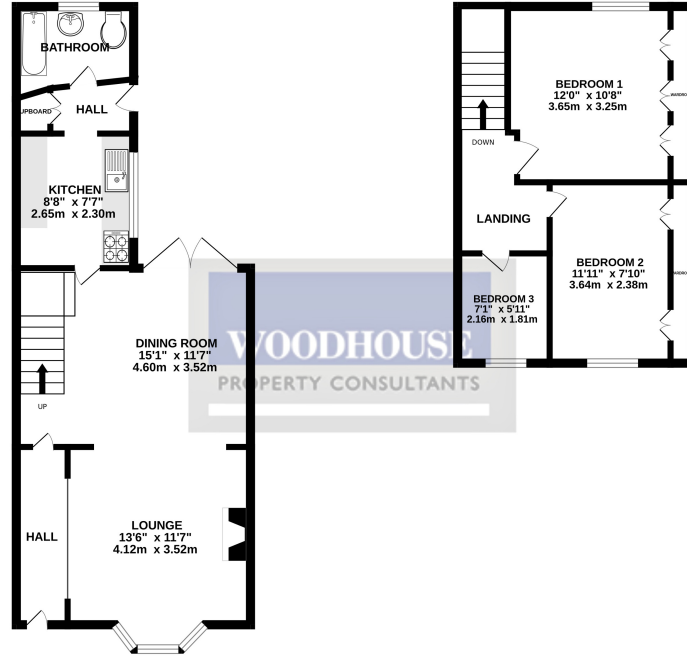

TOTAL FLOOR AREA: 926sq ft. (86.0 sq.m.) approx.
 Whilst every attempt has been made to ensure the accuracy of the floorplan contained here, measurements of doors, windows, rooms and any other items are approximate and no responsibility is taken for any error, omission or mis-statement. This plan is for illustrative purposes only and should be used as such by any prospective purchaser. The services, systems and appliances shown have not been tested and no guarantee as to their operability or efficiency can be given.
 Made with Metagor 12/02/25

EPC

