



Day & Co
ESTATE AGENTS

28 Cavendish Street
Keighley
BD21 3RG



6 Victoria Terrace, Keighley,
West Yorkshire, BD21 4HX

OFFERS OVER £70,000

T: 01535 664609

W: www.dayandcoestateagents.co.uk

E: keighley@dayandcoestateagents.co.uk

- THROUGH TERRACE HOUSE
- GAS CENTRAL HEATING & DOUBLE GLAZING
- EPC RATING D

- TWO BEDROOMS
- NO CHAIN

SUMMARY

** STONE THROUGH TERRACE, SITUATED OFF DALTON LANE, TWO BEDROOMS, GAS CENTRAL HEATING, DOUBLE GLAZING, NO CHAIN, EPC RATING D **

FULL DESCRIPTION

Offered for sale is this stone through terrace house situated off Dalton Lane. This two bedroom property has no vendor chain and benefits from both gas central heating and double glazing. In brief comprises of a good sized lounge with windows to the front and rear elevations. Basement Cellar Kitchen with range of units, sink. Upper Floor Two bedrooms and a bathroom comprising of a bath, w.c. and wash basin.

EPC Rating D

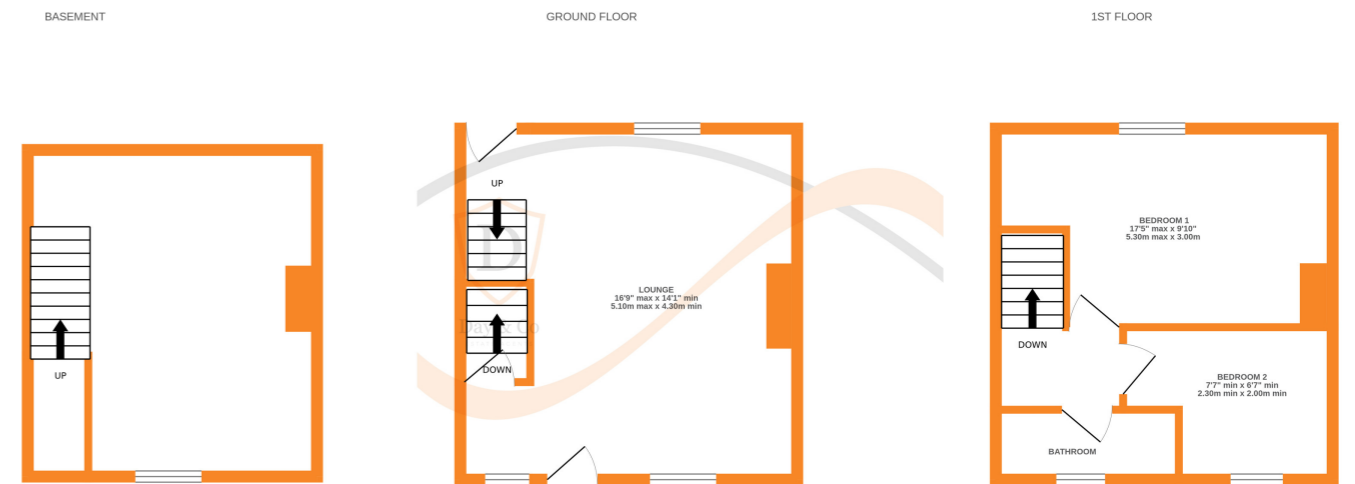

Whilst every attempt has been made to ensure the accuracy of the floorplan contained here, measurements of doors, windows, rooms and any other items are approximate and no responsibility is taken for any error, omission or mis-statement. This plan is for illustrative purposes only and should be used as such by any prospective purchaser. The services, systems and appliances shown have not been tested and no guarantee as to their operability or efficiency can be given.
Made with Metropix ©2023