



Freshfield Road,  
Formby, L37 3PS

£92,500

SM

STEPHANIE MACNAB  
ESTATE AGENT



Welcome to Hillary Court, a highly regarded development by McCarthy & Stone, ideally located within easy walking distance of both the Village centre and Train Station, offering exceptional convenience in a sought-after setting.

Situated within PHASE TWO of this well-respected, purpose-built retirement community, this beautifully maintained second-floor apartment enjoys a TURNKEY PRESENTATION and a thoughtfully designed layout with WELL-PROPORTIONED ROOMS, making it ideal for those seeking a comfortable, low-maintenance lifestyle.

Upon entering, you are welcomed by a spacious ENTRANCE HALL, complete with useful built-in storage and an intercom entry system for added peace of mind. The generous LOUNGE is filled with natural light and features a charming Juliet BALCONY, providing a pleasant outlook and a relaxing place to enjoy the surroundings.

The KITCHEN, positioned at the front of the apartment, offers a bright and practical space with ample work surfaces and storage – perfect for day-to-day use.

The BEDROOM is fitted with built-in furniture, providing excellent storage solutions while maximising floor space. The modern SHOWER ROOM is both practical and stylish, with a contemporary suite and ease of access.

With its IMMACULATE PRESENTATION, MOVE-IN READY CONDITION, and prime village location, this appealing apartment at Hillary Court offers a superb lifestyle opportunity for those looking to downsize without compromise.

There are additional details, which include the following:-

Lift - Laundry Room - Communal Lounge with kitchen for various social activities - Guest Suite available for visitors - 24-hour telephone care line system recently upgraded - On-site Development Manager - Landscaped Gardens - Car Parking - Bicycle Shed

There is NO ONWARD CHAIN. Call to view 01704 516 626.





## Second Floor Apartment

Approx. 46.8 sq. metres (503.9 sq. feet)

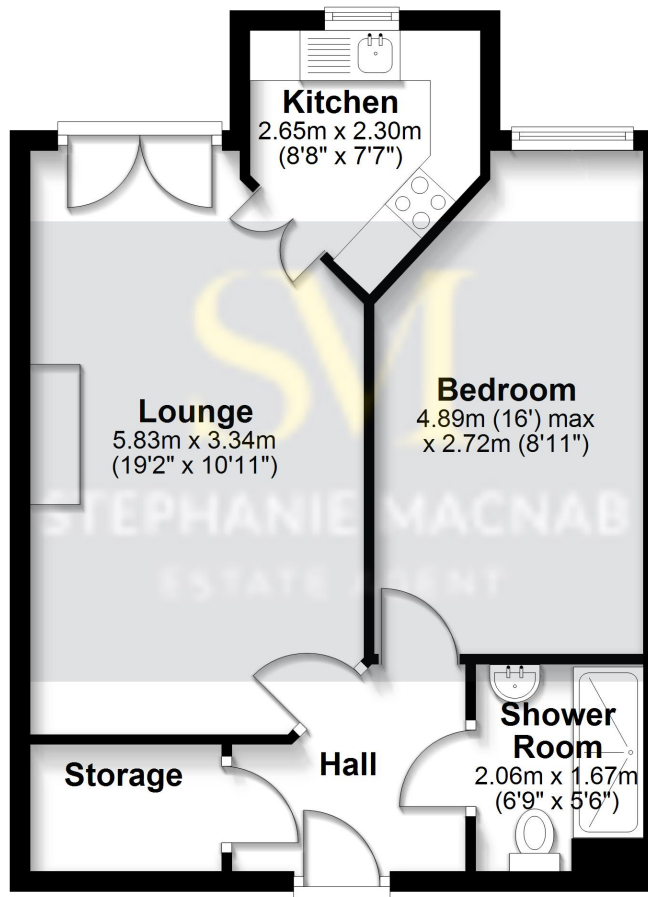

Total area: approx. 46.8 sq. metres (503.9 sq. feet)

This floorplan is for illustrative purposes only and is not to scale.  
Plan produced using PlanUp.



