

FOR
SALE



117 Dorchester Way, Belmont, Hereford HR2 7ZW

£485,000 - Freehold

22, Broad Street, Hereford, HR4 9AP 01432 355455 hereford@flintandcook.co.uk

PROPERTY SUMMARY

Peacefully situated on the outskirts of the City, an impressive 5-bedroom modern detached house offering ideal family accommodation. The property which is in excellent decorative order, has the added benefit of gas central heating, double glazing, 2 en-suite shower rooms, newly fitted kitchen and utility room, private rear garden and to fully appreciate this property we strongly recommend an internal inspection.

POINTS OF INTEREST

- *Popular residential area*
- *Modern detached house*
- *5 bedrooms, 2 en-suite*
- *2 reception rooms*
- *Double garage & ample parking*
- *Ideal family home*
- *No onward chain*
- *Viewing highly recommended*



ROOM DESCRIPTIONS

Ground Floor

Canopy Entrance Porch
with UPVC entrance door through to the

Reception Hall

Fitted carpet, smoke alarm, radiator, coved ceiling, carpeted staircase to the first floor, central heating thermostat, under-stairs store cupboard and door to the

Cloakroom

Low flush WC, wash hand-basin, tiled floor, radiator, double glazed window and wall mirror.

Lounge

Fitted carpet, coved ceiling, feature fireplace with hearth, display mantel and built-in coal effect fire, double glazed bay window to the front aspect, two radiators, fitted carpet and archway through to the

Dining Room

Fitted carpet, coved ceiling, radiator, double doors to the rear garden and door to the

Kitchen/Breakfast Room

With a range of wall and base units, ample high gloss worksurfaces with tiled splashbacks, tiled floor for easy maintenance, integrated dishwasher, double oven, microwave and induction hob with cooker hood over, space for upright fridge/freezer, double radiator, space for breakfast table, two double glazed windows with roller blinds overlooking the rear garden, recessed spotlighting, under-cupboard lighting and door to the

Utility Room

With 1 ½ bowl sink unit, range of wall and base cupboards, worksurfaces with tiled splashbacks, wall mounted gas central heating boiler, tiled floor, space and plumbing for washing machine, extractor fan, radiator, internal door to the garage, double glazed window and door to the rear garden.

From the Utility Room, there is a door to the

Second Downstairs Cloakroom

Low flush WC, radiator, tiled floor, double glazed window.

First Floor

Landing

Fitted carpet, smoke alarm, built-in Airing Cupboard, access hatch to loft space with ladder - partially boarded and with electric light.

Bedroom 1

Fitted carpet, extensive range of fitted wardrobes, further walk-in store cupboard/wardrobe, radiator, double glazed window to the front aspect and door to the
EN-SUITE SHOWER ROOM with newly installed shower cubicle, pedestal wash hand-basin, low flush WC, radiator, extractor fan, double glazed window, shaver point, tiled floor and mirror fronted medicine cabinet.

Bedroom 2

Fitted carpet, two radiators, fitted double wardrobe, access hatch to loft storage space and door to the
EN-SUITE SHOWER ROOM with double shower cubicle, pedestal wash hand-basin, low flush WC, radiator, extractor fan, shaver point and Velux roof window.

Bedroom 3

Fitted carpet, space for wardrobes, radiator, double glazed window to the rear.

Bedroom 4

Fitted carpet, recess ideal for wardrobes, radiator, double glazed window to the front aspect.

Bathroom

Suite comprising bath with mixer and handheld shower attachment over, partially tiled wall surround, wash hand-basin, low flush WC, tiled floor, radiator, shaver point, extractor fan, double glazed window, recessed spotlighting and mirror fronted cabinet.

Outside

To the front of the property there is a lawned garden with paved pathway leading to the front entrance door.

A double width driveway providing ample off-road parking facilities leads up to the DOUBLE GARAGE with twin up-and-over doors (one of which is electrically operated), power and light points, door through to the Utility Room and scope to convert into extra living accommodation, subject to the necessary consent.

To the immediate rear of the property there is a paved entertaining area leading onto the remainder of the garden which is laid to lawn, bordered by flowers and shrubs and well-enclosed by high fencing to maintain privacy. There is a useful side access gate, timber garden shed, corner seating area, outside light and water taps to both the front and rear.

General Information

Mains water, electricity, drainage and gas are connected. Telephone (subject to transfer regulations). Gas-fired central heating.

Outgoings

Council tax band 'F' amount payable £3316.99

Water and drainage - metered supply

Tenure & Possession

Freehold - vacant possession on completion.

Directions

Proceed south out of Hereford City on the A465 Abergavenny Road, taking the 3rd exit at the Tesco roundabout onto Northolme Road. At the mini roundabout, turn left into Dorchester Way.

Viewing

Strictly by appointment through the Agent, Flint & Cook, Hereford (01432) 355455.

Money Laundering Regulations

Prospective purchasers will be asked to produce identification, address verification and proof of funds at the time of making an offer.

Opening Hours

Monday - Friday 9.00 am - 5.30 pm

Saturday 9.00 am - 2.00 pm

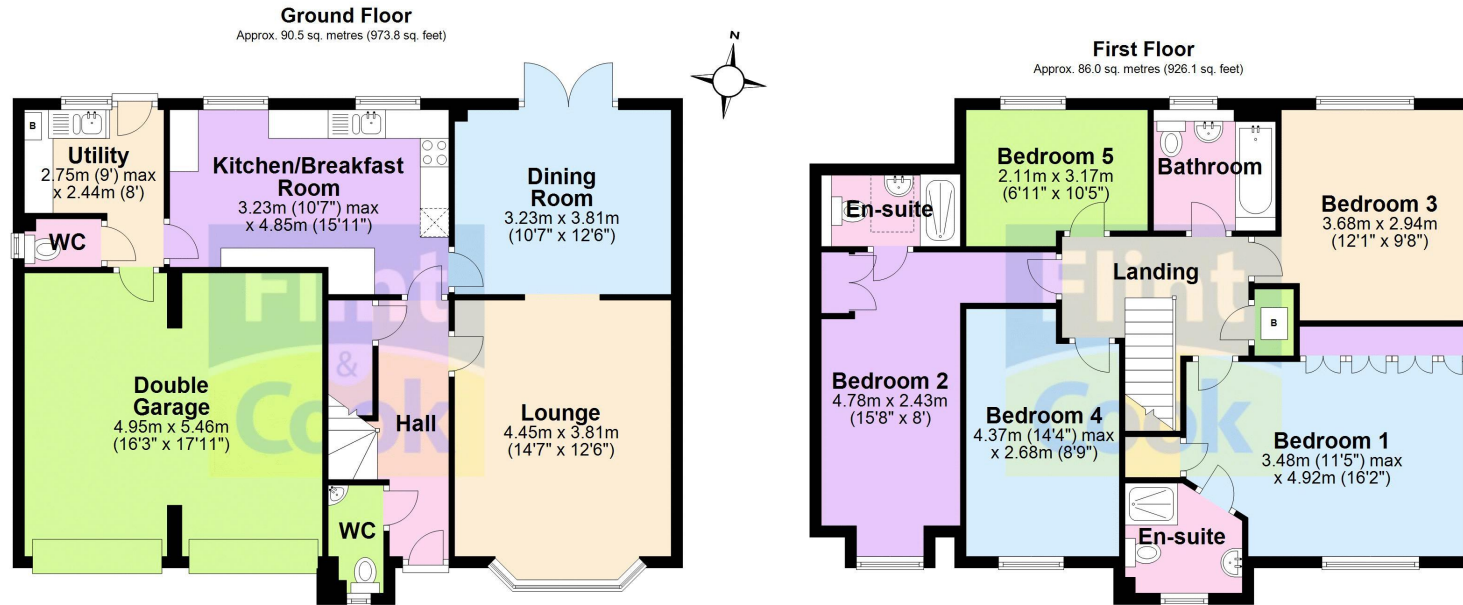

Total area: approx. 176.5 sq. metres (1899.9 sq. feet)

This plan is for illustrative purposes only
Plan produced using PlanUp.

These particulars are prepared for the guidance only of prospective purchasers. They are intended to give a fair and overall description of the property and do not constitute the whole or any part of an offer or contract. Any information contained herein (whether in text, plans or photographs) is given in good faith but should not be relied upon as being a statement or representation of fact. Any plans provided by the agents and/or with the sales particulars are intended for guidance purposes only; we cannot guarantee the accuracy and scale of any plans, and they do not form any part of the sales contract. Nothing in these particulars shall be deemed to be a statement that the property is in good condition or otherwise nor that any services or facilities are in good working order. Any movable contents, fixtures and fittings, (whether wired or not) referred to in these property particulars (including any shown in the photographs) are, unless the particulars say otherwise, excluded from the sale. In the event that the buyer proposes to purchase any movable contents or include them in any offer for the property, the buyer cannot in any respect imply any such inclusion from the property particulars. Any areas, measurements or distances referred to herein are approximate only and may be subject to amendment. It should not be assumed that the property has all necessary planning, building regulation or other consents and these matters must be verified by an intending purchaser. The information in these particulars is given without responsibility on the part of the agents or their clients and neither the agents nor their employees have any authority to make or give any representations or warranties whatever in relation to this property.

Flint & Cook Privacy Statement: We take your privacy very seriously. Your data will not be shared with any other parties without your express permission. Our Data protection Policy can be read in full on the Flint & Cook website, www.flintandcook.co.uk