

Fircroft Road, Ipswich

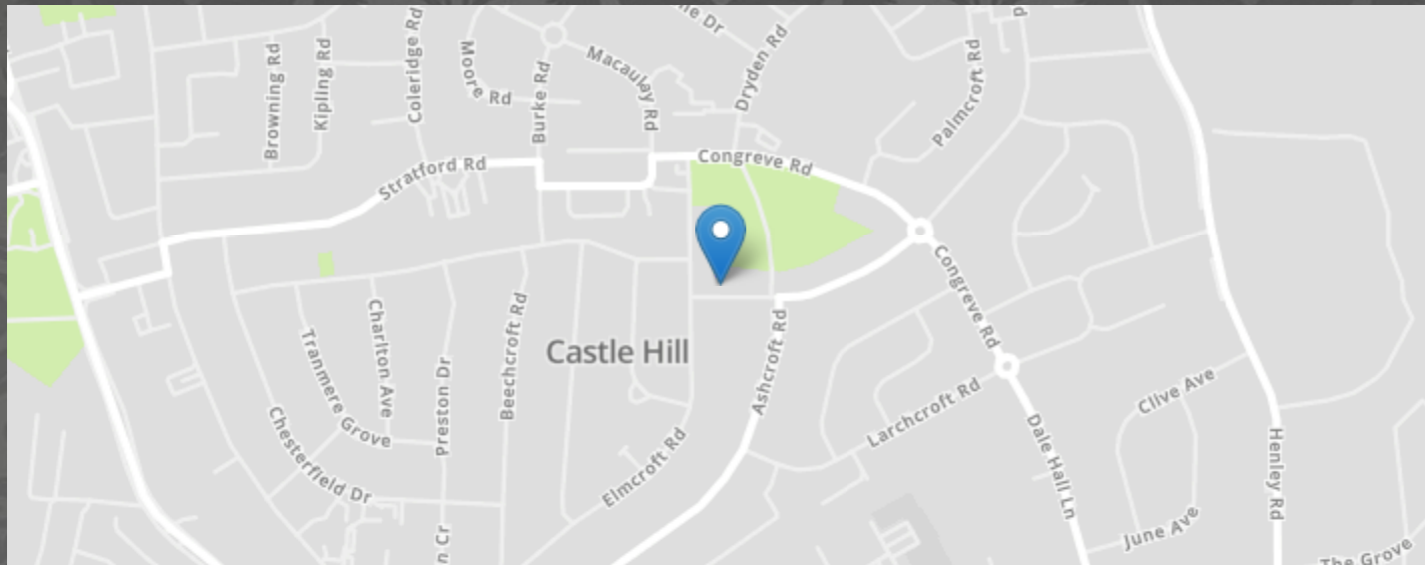

- SEMI DETACHED HOUSE
- POPULAR CROFTS DEVELOPMENT
- CLOSE TO LOCAL AMENITIES
- THREE BEDROOMS
- OFF ROAD PARKING
- CLOSE LINKS TO THE A14 & A12

MARKS & MANN



Fircroft Road, Ipswich

Marks and Mann are delighted to offer for sale this THREE BEDROOM SEMI DETACHED HOUSE situated on the popular Crofts development. The property boasts a lounge, three bedrooms, shower room and rear garden, garage and off road parking for three cars.

In the agents opinion early internal viewing is highly advised.

MARKS & MANN

7 The Square, Martlesham Heath, Ipswich, Suffolk, IP5 3SL.

01473 396 007

contactipswich@marksandmann.co.uk

Website www.marksandmann.co.uk

£275,000

Fircroft Road, Ipswich

Entrance Hall

1.07m x 2.00m (3' 6" x 6' 7")

Doors to Shower room, Kitchen, living room with stairs to first floor

Lounge

3.32m x 4.70m (10' 11" x 15' 5")

Double glazed window, fire place with mantel over and log burner, wood effect flooring, light fitting, radiator.

Kitchen

2.81m x 3.750m (9' 3" x 12' 4")

Double glazed window to the rear, double glazed door to rear, low level and eye level wood effect cupboards, space for fridge/freezer, cooker, washing machine and dishwasher, sink/draining board, tiled splashback light fitting.

Ground floor bathroom

1.60m x 1.83m (5' 3" x 6' 0")

Double glazed frosted window, tiled floor, shower, basin, toilet, light fitting, towel rail/radiator.

First floor landing

Window to side and doors to all bedrooms

Bedroom one

3.37m x 3.78m (11' 1" x 12' 5")

Double glazed window to the front, built in wardrobe, light fitting and radiator.

Bedroom two

2.82m x 3.78m (9' 3" x 12' 5")

Double glazed window to the rear, light fitting, loft access, radiator.

Fircroft Road, Ipswich

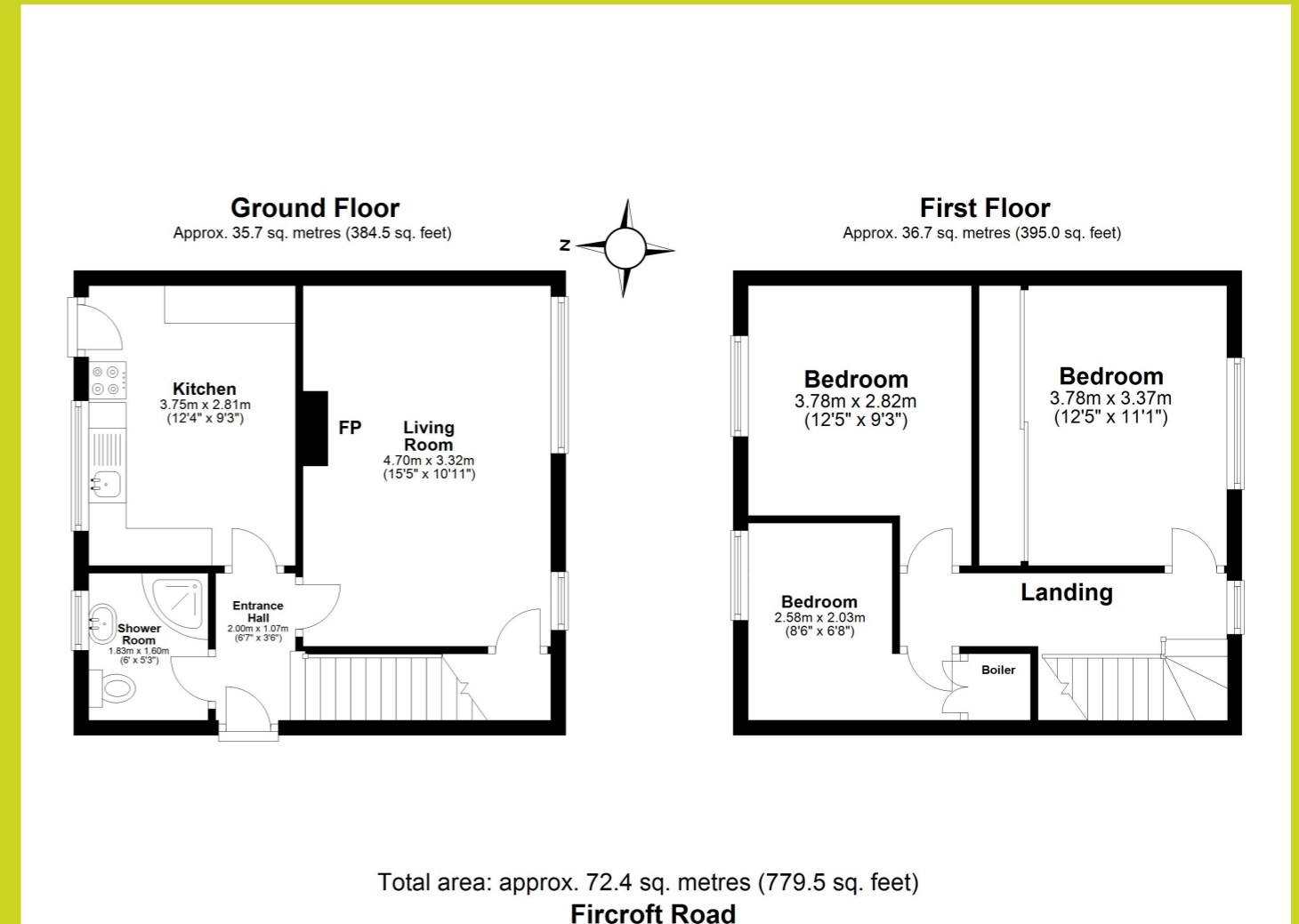

The above floor plans are not to scale and are shown for indication purposes only.

