



Toft Hill, Bishop Auckland, Durham. DL14 0PY

Situated in the heart of this beautiful village, this lovely detached property is set within a generous sized garden plot and ideal for living a semi-rural life within a great community. The accommodation offers the opportunity to further extend, subject to planning, and viewing comes strongly recommended.



£315,000 Freehold

PROPERTY DESCRIPTION

This charming detached property is situated prominently in the heart of the village, within a surrounding garden plot, in a picturesque village location. The accommodation comprises; entrance hall, lounge with feature fire surround and access to garden room. The kitchen has a range of wall and base units with space for appliances, and window over garden.

To the first floor is a return landing area with picture-window across the gardens. There are three bedrooms, one with recessed wardrobes, and a house bathroom comprising part tiling, bath, wash basin and shower.

Externally there is an extensive landscaped garden to the front, rear and sides. The entrance to the drive provides ample space for parking or subject to planning potential, to extend the current accommodation.

The property benefits from gas central heating and is connected to main drains.

Agent's Notes

Council Tax Band - D

Cost for Year 2023/2024 - Circa £2,412 PA

FEATURES

- Beautiful Village Location
- Detached Family Home
- Gardens to Front and Rear Aspects
- Three Bedrooms
- Charming and Full of Character
- Available with No Onward Chain



ROOM DESCRIPTIONS



FLOORPLAN



290 Toft Hill Lane, Bishop Auckland DL14 0PY, UK, DL14 0PY
 TOTAL APPROX. FLOOR AREA 109 SQ.M
 Whilst every attempt has been made to ensure the accuracy of the floor plan contained here, measurements of doors, windows, floors and any other items are approximate and do not necessarily correspond to actual dimensions, or measurements.
 This plan is for illustrative purposes only and should be used as such by any prospective purchaser.

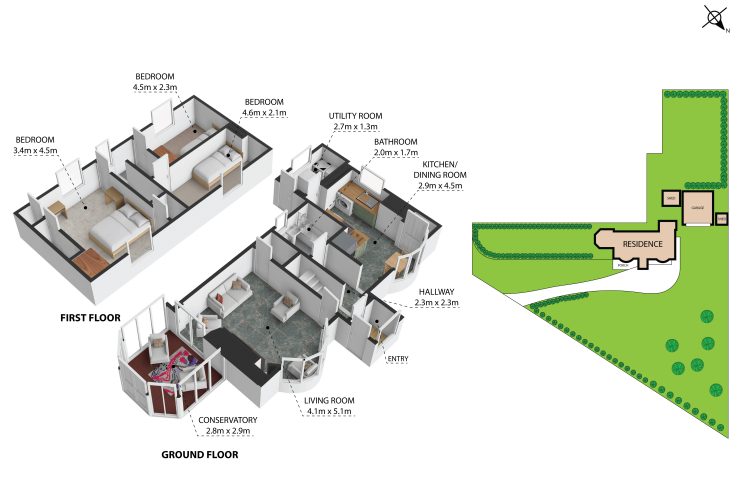

290 Toft Hill Lane, Bishop Auckland DL14 0PY, UK, DL14 0PY
 TOTAL APPROX. FLOOR AREA 109 SQ.M
 Whilst every attempt has been made to ensure the accuracy of the floor plan contained here, measurements of doors, windows, floors and any other items are approximate and do not necessarily correspond to actual dimensions, or measurements.
 This plan is for illustrative purposes only and should be used as such by any prospective purchaser.

Newcastle upon Tyne
 65, Quayside, Newcastle upon Tyne, NE1 3DE
 0845 6431186
 info@urban-base.com