



176 Western Way, Letchworth Garden City, Hertfordshire, SG6 4SS

£400,000

Letchworth Garden City was designed to combine energetic town life with the beauty of the countryside. The town offers a variety of High Street stores, independent shops, restaurants and public houses together with a wide range of attractions including museums, art galleries, a four screen cinema, swimming pool and leisure facilities, open green spaces, parks and gardens, superb and highly regarded Private & public schools, yet only 29 minutes from Kings Cross & Moorgate, 28 minutes to Cambridge, whilst the A1(M) is a few minutes' drive, and London Luton Airport 25 minutes away.



176 Western way

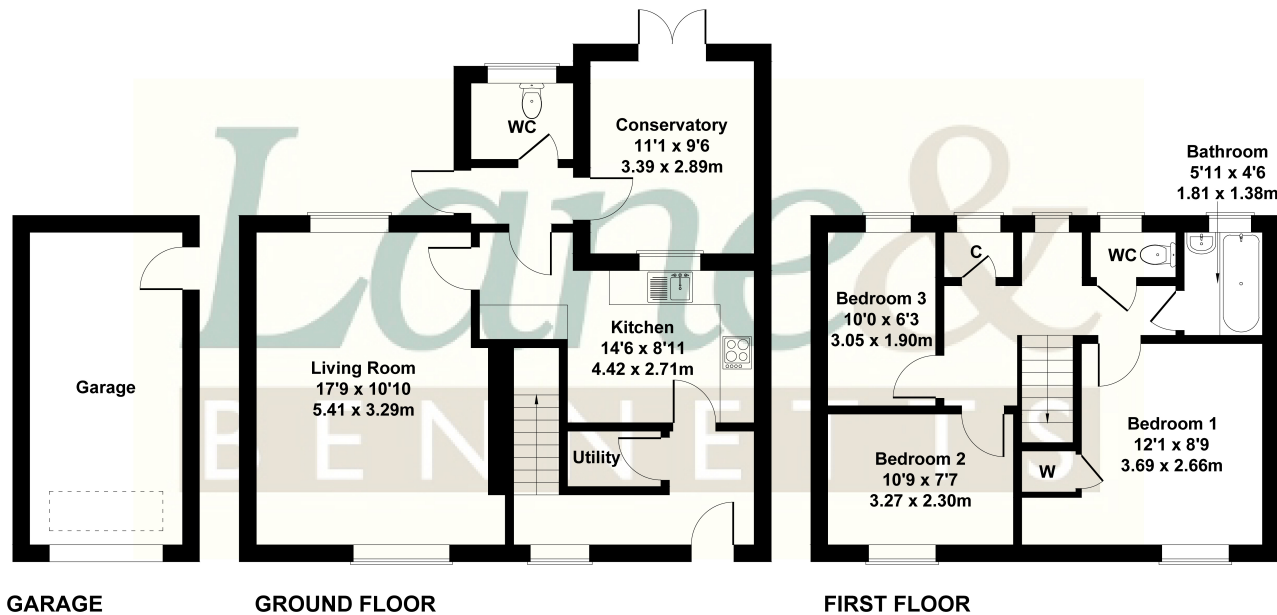

Not to Scale. Produced by The Plan Portal 2025
For Illustrative Purposes Only.

- Post war end terrace property
- opportunity to upgrade and re-model.
- FREEHOLD | COUNCIL TAX BAND C
- Chain free property
- Spacious living/dining space (5.1m x 3.3m)
- Large conservatory leading to rear patio.
- Fitted Kitchen & Utility space
- APPROX. 1 MILE TO TOWN & STATION
- Gas central heating | full double glazing
- Large rear garden and sweeping corner plot.
- Front garden with driveway
- DETACHED GARAGE