

Milburys

SALES LETTING MANAGEMENT



10 Gloucester Terrace, Gloucester Road, Thornbury, South Gloucestershire BS35 1DE £215,000



## Floor Plan

Approx. 52.0 sq. metres (559.7 sq. feet)

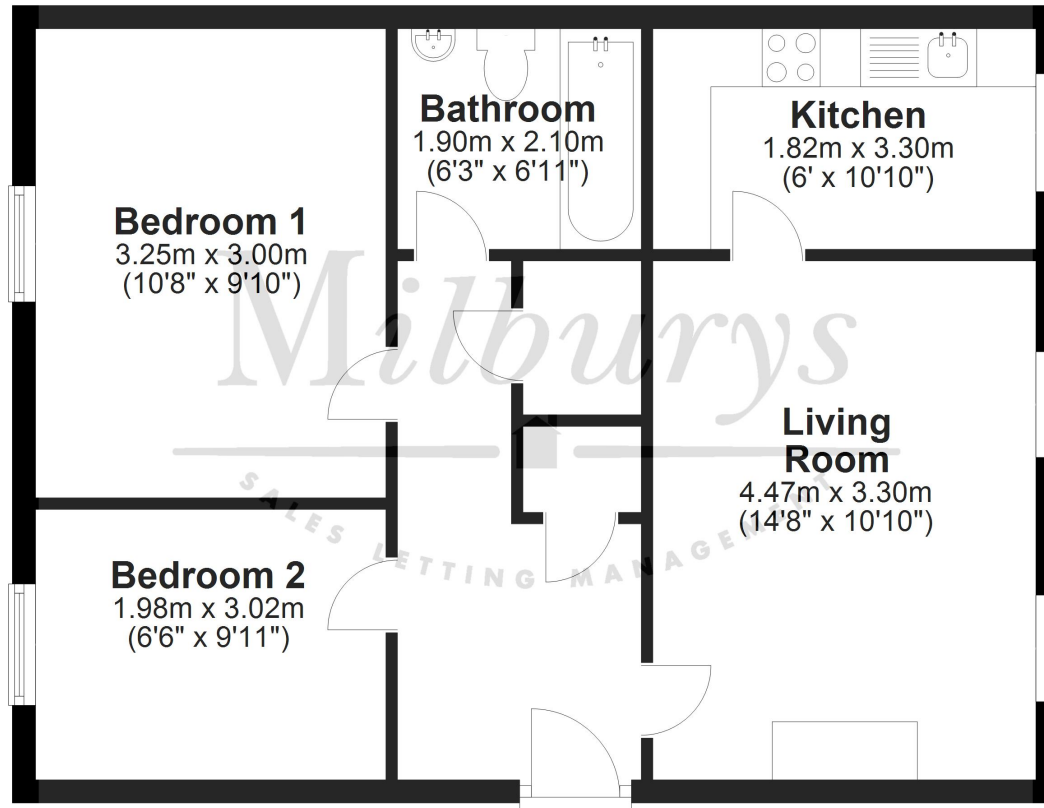

Total area: approx. 52.0 sq. metres (559.7 sq. feet)

For Illustrative Purposes Only. Not to Scale.  
Plan produced using PlanUp.



# 10 Gloucester Terrace, Gloucester Road, Thornbury, South Gloucestershire BS35 1DE

A glorious and welcoming two bedroom, ground floor apartment, in a central location just a short stroll from Thornbury High Street. Attractive and convenient with all the towns amenities on your doorstep, with allocated and visitor parking... it is a must see!! Accessed through the secure entry system, the internal communal hall is clean and tidy and provides entry to the front door. Once inside the property, to the right, a spacious lounge with double sash windows allowing light to flood in, electric fireplace and space for a dining area. To the rear, a fabulous shaker style fitted kitchen giving a modern touch, offering small details' such as cabinet lighting alongside an array of wall and base units, integrated electric oven, 4 ring hob over and extractor hood above. The bedrooms are clean and bright, the fitted bathroom offers an electric shower over bath, heated towel rail and sink with generous vanity storage. Further benefits include, storage cupboard, large airing cupboard electric heating and UPVC sash windows. Offered with no onward chain making a prompt and uncomplicated move possible. Arrange your tour today.

## Situation

Thornbury is a thriving market town to the north of the City of Bristol and the M4/M5 interchange, with excellent commuting links via the motorway network and by rail from Bristol Parkway Station (Paddington/South Wales). The High Street offers a wide variety of shops, cafes, pubs and restaurants. Other facilities include the leisure centre, golf course and library, plus open community spaces, parks and sports grounds/clubs. The town is blessed with a number of primary and junior schools, plus The Castle secondary school ([www.thecastleschool.org.uk](http://www.thecastleschool.org.uk)) which is situated on the edge of open countryside close to Thornbury's Tudor Castle, now a luxury hotel.

## Property Highlights, Accommodation & Services

- Modern Purpose Built Two Bedroom Ground Floor Apartment
- Central Location - Easy Stroll To Shops, Cafes And High Street Amenities
- Spacious Lounge, Double Windows And Electric Fireplace
- Shaker Style Fitted Kitchen With Wall And Base Units With Space For Appliances
- Family Bathroom With Shower Over Bath, Fitted Vanity And Heated Towel Rail
- Useful Storage Cupboard In Hallway
- Allocated Off Street Parking and Guest Parking
- Communal Outside Space and Secure Entry System
- No Onward Chain!

## Directions

From the mini roundabout near the bottom of the High Street, bear left onto Gloucester Road. Gloucester Terrace is a short way along on your left-hand side. Drive in under the arch where there are marked visitor bays.

## Local Authority & Council Tax -

**Tenure** - Leasehold

**Additional Information** - Management Fees Apply

**Contact & Viewing** - Email: [thornbury@milburys.co.uk](mailto:thornbury@milburys.co.uk) Tel: 01454 417336

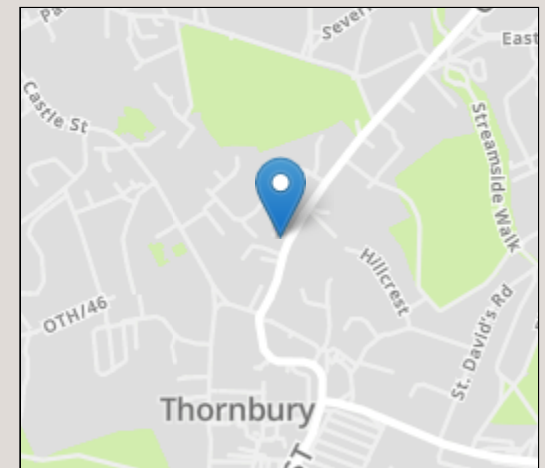

IMPORTANT NOTICE Milburys Estate Agents Ltd, their clients and any joint agents give notice that they have not tested any apparatus, equipment, fixtures, fittings, heating systems, drains or services and so cannot verify they are in working order or fit for their purpose. Interested parties are advised to obtain verification from their surveyor or relevant contractor. Statements pertaining to tenure are also given in good faith and should be verified by your legal representative. Digital images may, on occasion, include the use of a wide angle lens. Please ask if you have any queries about any of the images shown, prior to viewing. Where provided, floor plans are shown purely as an indication of layout. They are not scale drawings and should not be treated as such. Complete listings and full details of all our properties (both for sale and to let) are available at [www.milburys.co.uk](http://www.milburys.co.uk)



