



Middleton Crescent
Norwich
Norfolk
NR5 0PX

Offers In Excess Of £208,000

bettermove 

Middleton Crescent Norwich

Bettermove are proud to present this 2 bedroom end of terrace house in Norwich available with no forward chain.

The property benefits from double glazing, gas central heating throughout.

The council tax band is B.

The interior of this property comprises a spacious living room and fitted kitchen on the ground floor. The first floor consists of 2 bedrooms and the family bathroom with separate w/c. The exterior boasts a private rear garden, perfect for enjoying the summer months.

Located in the popular residential area of Costessey, the property is close to a range of amenities, including shops, supermarkets, restaurants and pubs. Excellent transport connections can be found from the A47, A1074 and local bus routes.

This exciting opportunity should not be missed! All enquiries can be made through Bettermove on 0330 004 0050.



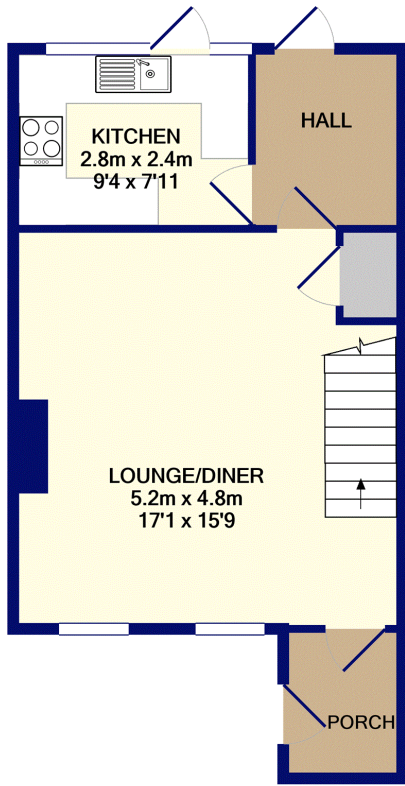

GROUND FLOOR
APPROX. FLOOR
AREA 39.2 SQ.M.
(422 SQ.FT.)

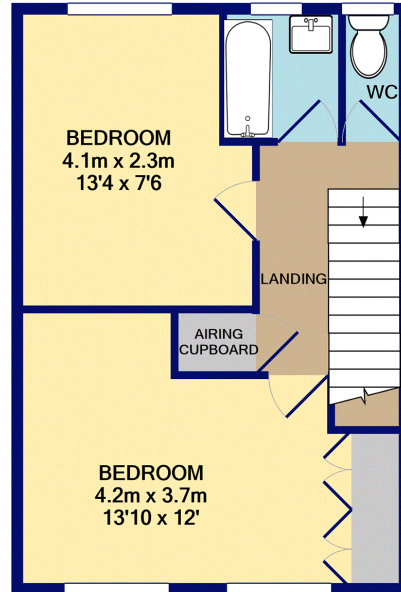

1ST FLOOR
APPROX. FLOOR
AREA 36.7 SQ.M.
(395 SQ.FT.)

TOTAL APPROX. FLOOR AREA 75.9 SQ.M. (817 SQ.FT.)

Whilst every attempt has been made to ensure the accuracy of the floor plan contained here, measurements of doors, windows, rooms and any other items are approximate and no responsibility is taken for any error, omission, or mis-statement. This plan is for illustrative purposes only and should be used as such by any prospective purchaser. The services, systems and appliances shown have not been tested and no guarantee as to their operability or efficiency can be given
Made with Metropix ©2020

Energy Efficiency Rating		
	Current	Potential
Very energy efficient - lower running costs		
(92+) A		
(81-91) B		85
(69-80) C		
(55-68) D	68	
(39-54) E		
(21-38) F		
(1-20) G		
Not energy efficient - higher running costs		
England, Scotland & Wales	EU Directive 2002/91/EC	



20-22 Bridge End, Leeds, LS1 4DJ
t: 0330 004 0050 e: hello@bettermove.co.uk
www.bettermove.co.uk