



Estate Agents and Solicitors

30/4, Easter Dalry Wynd, Dalry, Edinburgh, EH11 2TJ

Beautifully Presented & Spacious, One Bedroom, Dual Aspect Flat.

Up to date price and viewing info at [mov8realestate.com/property](https://www.mov8realestate.com/property)

espc rightmove  Zoopla
find your happy

Property Description

Beautifully-presented and spacious, one-bedroom, dual-aspect flat on the second floor of a modern, factored conversion of the Caledonian Distillery. Located in a residential development in Edinburgh's Dalry district, west of the city centre.

Comprises an entrance hall, living/dining room, kitchen, double bedroom and a bathroom.

Features include generous room sizes, a fitted kitchen with appliances, double glazing, gas central heating, storage space, a secure entry system and TV and telephone points. Externally, there is ample space in the residents car park, and a well-maintained communal courtyard and grounds.

The entrance hall which has a small storage cupboard as you walk in provides access to each room within the property. Set to the front, the living room has wood effect flooring extending from the hall, a central light fitting, a Juliet balcony and ample space for freestanding living/dining furniture.

Open plan to the living room, the kitchen is fitted with modern units and stone effect worktops, a tiled surround, a stainless steel sink with drainer, an integrated oven, and an electric hob with canopy above. Appliances include a fridge/freezer, integrated dishwasher and washing machine.

The generously sized bedroom has a built-in wardrobe, carpeted flooring and a pendant light fitting. Completing the accommodation, the modern bathroom is fitted with a three-piece suite with a mains mixer shower over the bath, tiled splash walls and tiled flooring.

A 360 Virtual Tour is available online.



30/4 Easter Dalry Wynd Dalry Edinburgh EH11 2TJ

Approximate Gross Internal Area: (614 sq ft - 57 sq m.)

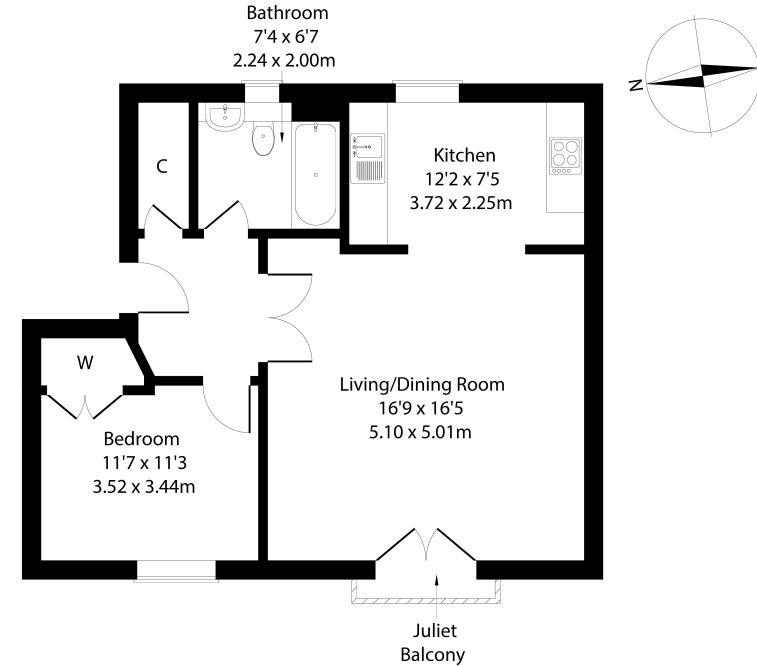

Legal Disclaimer : Floor-plan and measurements are for illustrative guidance only, and not intended to form part of any contract.

Area Description

Dalry is a high-amenity area within walking distance of Haymarket Station, Edinburgh's West End and the city centre. There is excellent local shopping, with specialist shops and supermarkets close by, including Co-operative and Lidl supermarkets, whilst a Sainsbury's and Aldi are located nearby in Gorgie. There is an extensive range of cafes, bars and restaurants both in Dalry and West End, whilst leisure facilities include the

with a multi-screen cinema and fitness centre, and the Dalry Swim Centre. Dalry is also convenient for Napier and Heriot-Watt universities, and Edinburgh College. There are highly frequent bus services, whilst the tram network is available from Haymarket for direct connections to Edinburgh Airport or the city centre.





Our Services

- Free pre-sale property valuations
- Great value fixed estate agency fees
- Extensive buyer matching database
- Purchase and sale conveyancing

Contact Us

0345 646 0208

sales@mov8realestate.com

www.mov8.com

Head Office

6 Redheughs Rigg, Edinburgh, EH12 9DQ

Glasgow Office

77 Renfrew Street, Glasgow, G2 3BZ



Estate Agents and Solicitors



These particulars do not form part of any contract and the statements or plans contained herein are not warranted nor are they to scale. All descriptions, dimensions, areas, reference to condition and necessary permissions for use and occupation and other details are given in good faith, and are believed to be correct, but any prospective purchaser should not rely on them as statements or representations of fact, and any prospective purchaser must satisfy themselves by inspection or otherwise as to the correctness of each of them. The Seller shall not be bound to accept the highest or any offer nor to accept a full offer of the Fixed Price where this is applicable. Approximate measurements have been taken by sonic device and measurements are most often taken to the widest point of any room or space. Services and appliances have not been tested for efficiency or safety and no warranty is given as to their compliance with any Regulations. Offers should be made using the Combined Standard Clauses.