



Page Crescent, Croydon, Surrey, CR0

£330,000 Leasehold

- Fantastic sized garden
- Local primary school within walking distance
- Brilliant location for transport and amenities
- Fantastic sized private garden
- Long lease and low service charges
- Loft space with storage
- Walking distance to local parks
- Double glazed and central heated

Page Crescent, Croydon, Surrey, CR0

£330,000 Leasehold

A brilliant sized maisonette that offers ample space for a new home owner to enjoy. Located in on of the greener spaces of Croydon, which also provides excellent transport links, this lovely sized two bedroom home with superb private garden space is a must see!

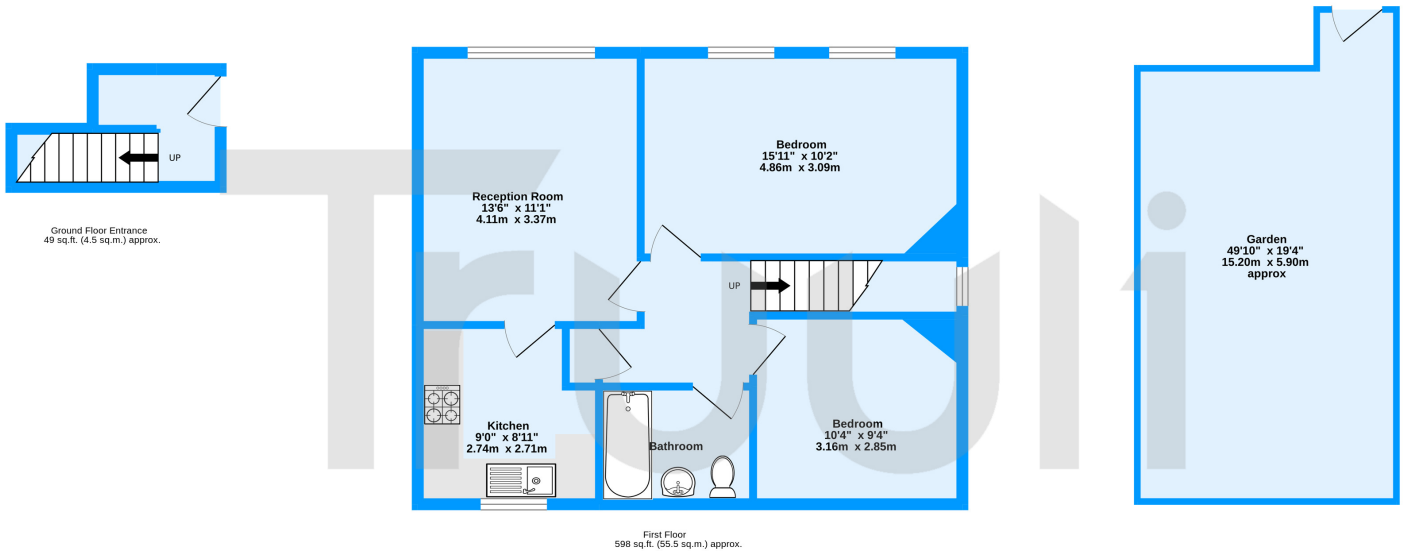

Page Crescent, Croydon, CR0

TOTAL FLOOR AREA : 646 sq.ft. (60.0 sq.m.) approx.

Whilst every attempt has been made to ensure the accuracy of the floorplan contained here, measurements of doors, windows, rooms and any other items are approximate and no responsibility is taken for any error, omission or mis-statement. This plan is for illustrative purposes only and should be used as such by any prospective purchaser. The services, systems and appliances shown have not been tested and no guarantee as to their operability or efficiency can be given.
Made with Metropix ©2022

