



103 Shaftesbury Crescent, Staines-upon-Thames, Surrey, TW18 1QN

WELL PRESENTED & SPACIOUS THREE BEDROOM END-TERRACED PROPERTY WITH DOUBLE GARAGE IDEALLY LOCATED FOR STAINES & ASHFORD TOWN CENTRES. The property benefits from a spacious lounge/diner, separate modern fitted kitchen, three well proportioned bedrooms, modern white bathroom suite and a secluded rear garden leading to double garage. No Onward Chain. Viewings Highly Recommended!

ROOM DESCRIPTIONS

Double glazed door leading to:

Entrance Hall

Light Point, double radiator, cupboard housing fuseboard, glazed door to Lounge & stairs to first floor.

Lounge/Diner

Front aspect double glazed window, light and power points, two single radiators, TV point, rear aspect double glazed sliding patio door to Garden, understairs storage cupboard.



Kitchen

Rear aspect double glazed window, range of fitted units at eye and base level, roll edged worktops, 1 1/2 bowl sink drainer unit, space for cooker & fridge/freezer. Wall mounted boiler, rear aspect double glazed door to Garden.



First Floor

Landing

Side aspect double glazed window, light and power points, doors to all rooms.

Bedroom 1

Front aspect double glazed window, light and power points, single radiator, cupboard housing hot water tank.



Bedroom 2

Rear aspect double glazed window, light and power points, single radiator.

Bedroom 3

Rear aspect double glazed window, light and power points, single radiator.

ROOM DESCRIPTIONS

Bathroom

Front aspect double glazed frosted window, panel enclosed shower bath, low level W.C, wash hand basin inset to cabinet, single radiator, heated towel rail, tiled walls, tiled floor.



Double Garage

With light and power points.



Outside

Front Garden

Mainly laid to lawn with pathway leading to front door.

Rear Garden

Paved patio area nearest to house, mainly laid to lawn, brick-built shed, gated side access to front and rear.



FLOORPLAN

Ground Floor

Approx. 39.7 sq. metres (427.0 sq. feet)

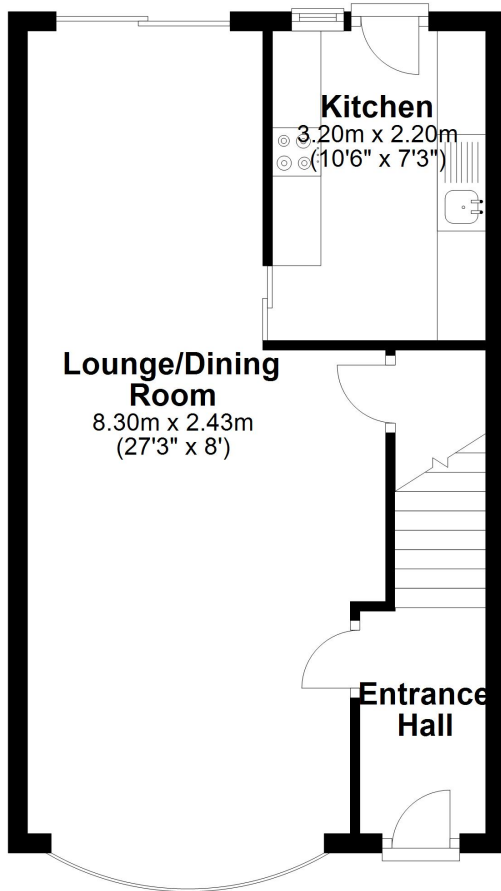

First Floor

Approx. 39.4 sq. metres (424.0 sq. feet)

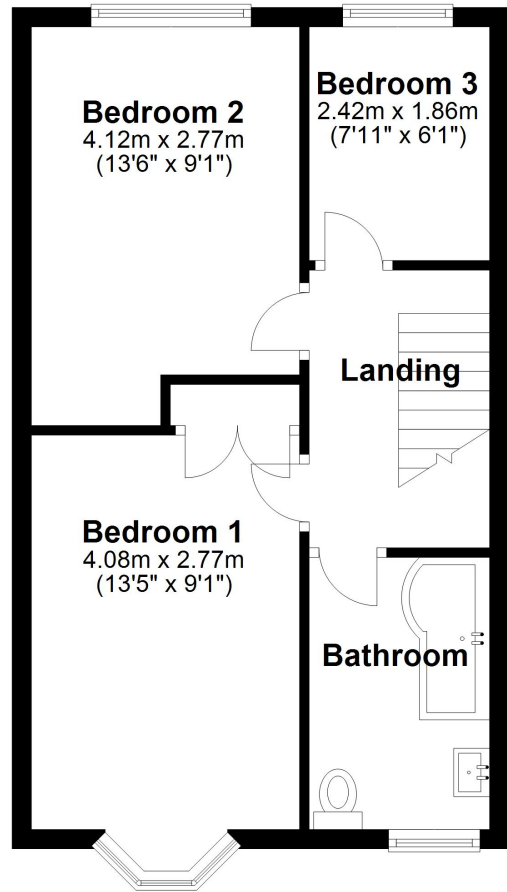

Total area: approx. 79.1 sq. metres (851.0 sq. feet)