



**Apt 2903 West Tower, Pan Peninsula 1 Peninsula Square, London  
£2,500 per calendar month**

**BELTON DUFFEY**



# **APT 2903 WEST TOWER, PAN PENINSULA 1 PENINSULA SQUARE, LONDON E14 9HL**

A 1 bedroom Pan Peninsula apartment on the 29th Floor of the West Tower with benefits including 24 hour concierge service.  
Furnished.

## **DESCRIPTION**

Furnished to corporate standards on the 29th floor of the West Tower is this fabulous one bedroom, one bathroom apartment in the fantastic Pan Peninsula development.

The accommodation briefly comprises an open-plan fitted kitchen with microwave/oven, full height fridge/freezer, dishwasher, washing machine and tumble dryer, open plan lounge area with floor to ceiling windows and balcony offering amazing views, double bedroom with fitted wardrobe; the rooms have made great use of ample lighting which helps characterise the rooms and their furnishings. There is also a contemporary designed bathroom finished in marble with white stone bath, basin and wc.

This fully prepared apartment benefits from a 24 hour concierge service, highly secured surroundings and leisure facilities which include a residents cinema and 50th floor residents' cocktail lounge, waterside restaurant and a fully managed gymnasium with pool. For more information about the services available please visit [www.panpeninsula.com](http://www.panpeninsula.com)

N.B. Please be aware that the owner of this property is a director of Belton Duffey West Norfolk Ltd

Furnished.

## **SITUATION**

Pan Peninsula is situated in an extremely central location, just across the river from charming Greenwich and moments from the bustling shops, bars and restaurants in Canary Wharf where the Jubilee Line provides direct access into the West End and a plethora of vibrant theatres, museums and markets.

Further transport links include South Quay Station (DLR) offering direct access to City Airport and Waterloo International (British Rail and Eurostar services) is just a quick hop along the Jubilee Line at Canary Wharf.



## **KITCHEN**

An open plan fitted kitchen with microwave/oven, full height fridge/freezer, dishwasher, washing machine and tumble dryer.

## **OPEN-PLAN LOUNGE AREA**

Floor to ceiling windows with balcony, giving views over the surrounding area.

## **BEDROOM**

Fitted wardrobe, views overlooking surrounding area.

## **BATHROOM**

Contemporary design finished in marble with a white stone bath, basin and wc.

## **ADDITIONAL INFORMATION**

- 1) References - For tenancies commencing from the 1st June 2019 the tenant fee ban applies, therefore agents can no longer charge for tenant referencing. The Lettings Hub undertake the referencing process by sending you an email with a link asking you to create an account and access an application form. You can return to the Hub at any time to view the latest status of your application and see exactly which referees we are waiting for, or if we are waiting for any further information from you.
- 2) Anti-money laundering - We will undertake anti-money laundering checks including checks for politically exposed persons (PEPs).
- 3) Deposit £3000.00 (Capped at no more than 5 weeks' rent).
- 4) To be let furnished.

## **DIRECTIONS**

Apartment 2093 Pan Peninsula is located right by South Quays DLR station, approximately 7 minutes walk from Canary Wharf business district and all the amenities within the surrounding areas.

## **OTHER INFORMATION**

Council Tax Band F.

EPC - B.

Furnished.

## **VIEWING**

Strictly by appointment with the agent.

# Ground Floor

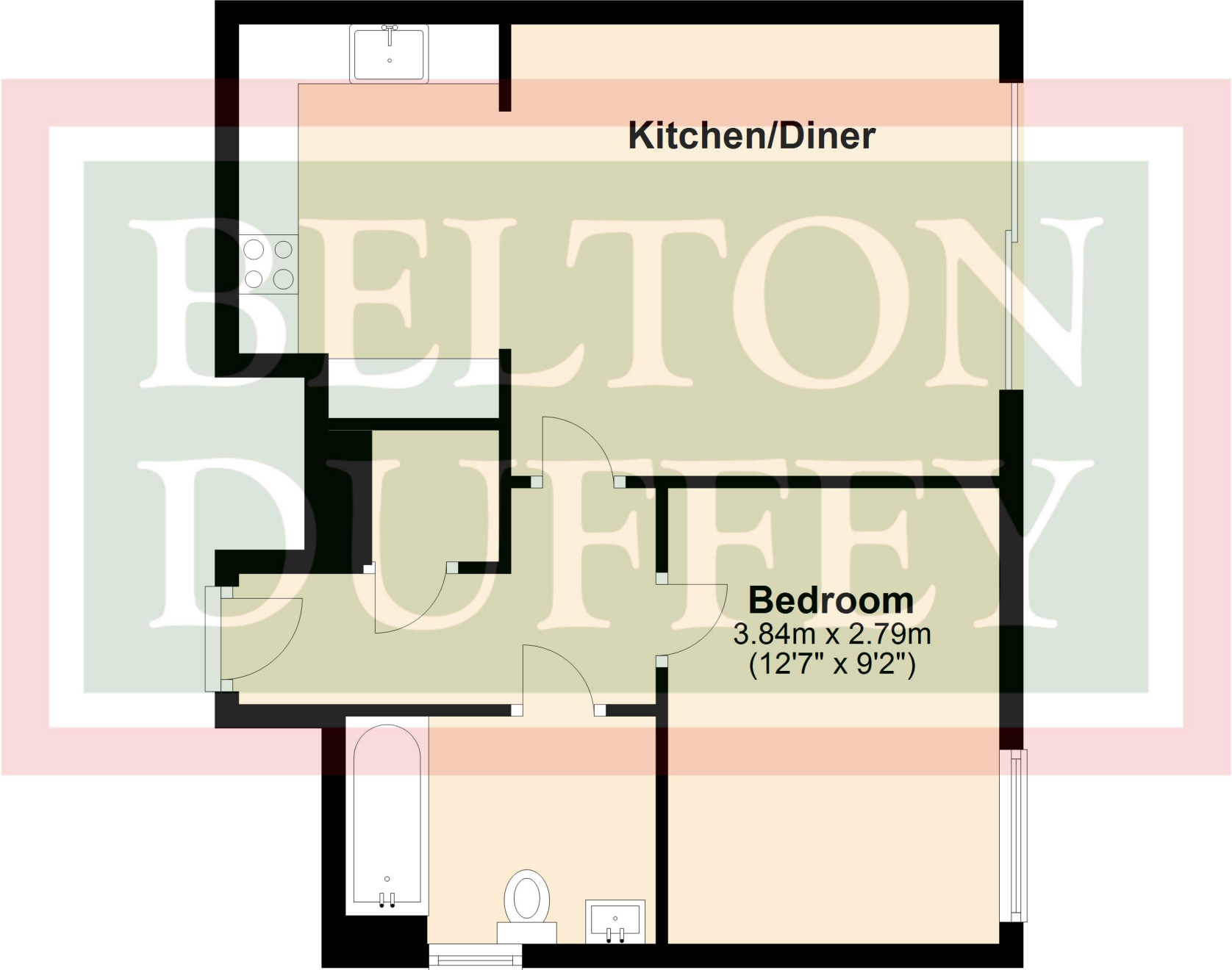





## BELTON DUFFEY

12-16 Blackfriars Street,  
King's Lynn,  
Norfolk, PE30 1NN.  
T: 01553 660866  
E: [lettings@beltonduffey.com](mailto:lettings@beltonduffey.com)

Our lettings department, based at the King's Lynn office, covers West Norfolk, North Norfolk and the fenland and Breckland villages. if you would like any further information or would like to view this property, please contact us.

[www.beltonduffey.com](http://www.beltonduffey.com)

**IMPORTANT NOTICES:** 1. Whilst these particulars have been prepared in good faith to give a fair description of the property, these do not form any part of any offer or contract nor may they be regarded as statements of representation of fact. 2. Belton Duffey have not carried out a detailed survey, nor tested the services, appliances and specific fittings. All measurements or distances given are approximate only. 3. No person in the employment of Belton Duffey has the authority to make or give representation or warranty in respect of this property. Any interested parties must satisfy themselves by inspection or otherwise as to the correctness of any information given.

