



Golden Willows

Golden Willows | Ickleford | Hitchin | Hertfordshire | SG5 3TR

www.stonegate-estates.co.uk



GOLDEN WILLOWS

Property Description

We are delighted to offer for sale this spacious two bedroom detached property in a lovely rural location on a small site with similar Park Homes.

Benefits include a spacious living room, a fitted kitchen and separate dining room, a shower room and two bedrooms, double glazing and a private, enclosed garden looking on to a small paddock currently with sheep in it. There is a driveway to the side with parking for two vehicles.

The property has oil fired heating and is located within this small and well maintained site of similar properties.

Ickleford is a beautiful village situated on the outskirts of Hitchin town centre and provides its residents with a local shop, highly rated primary school, community centre and a pleasant local community. Just a short distance from Ickleford is Hitchin town centre which offers a further host of popular shops, restaurants, bars and leisure facilities along with convenient access into London, Cambridge and Peterborough via both direct rail link and the A1(m).

Please Note:

The site has an age restriction of over 50's.

The buyer has the responsibility of paying 10% of the purchase price to the Site owner as part of the purchase.

£139,950 Leasehold





Floor Plan
Approx. 68.8 sq. metres (740.8 sq. feet)

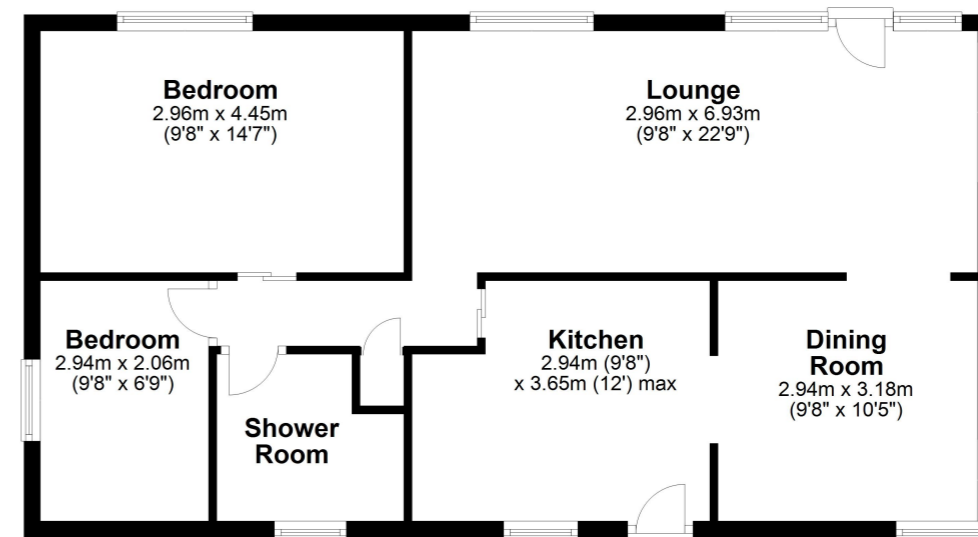

Total area: approx. 68.8 sq. metres (740.8 sq. feet)

All measurements shown are approximate and for guidance only. Garages and workshops are not included in any gross floor areas unless integral to the main building where they will be included.
Plan produced using PlanUp.



- Village Location
- Park Home
- Large Lounge
- Dining Room
- Two Bedrooms
- Enclosed Rear Garden
- Parking for Two cars
- Restricted to Over 50's

EPC Rating:

Stonegate Estate Agents

01462 438979

sales@stonegate-estates.co.uk | www.stonegate-estates.co.uk

