



4A SANDRINGHAM WAY, MARKET DEEEPING
PE6 8AX OFFERS OVER £370,000

FREEHOLD



Briggs Residential
17 Market Place
Market Deeping
PE6 8EA

01778
349300

briggsresidential.co.uk



Situated in a sought after location, overlooking an open green, this well presented family home benefits from an exceptionally spacious 26' kitchen/diner alongside three further spacious reception rooms, whilst to the first floor there are four double bedrooms, the master having an en-suite. With ample parking and a generous enclosed rear garden, the property is offered for sale with no forward chain.

Entrance door opening to

HALLWAY

With stairs leading to first floor.

CLOAKROOM

Comprising wash-hand basin, WC, radiator and tiled flooring.

KITCHEN/DINER 26'7 x 8'8 (8.12m x 2.64m)

A stunning open-plan space with a modern fitted kitchen, including base and eye level units with worktop over, space for American style fridge/freezer, plumbing for washing machine, range style oven, tiled flooring, box bay window to front elevation, further window to side elevation and open-plan access through to

GARDEN ROOM 12'5 x 9'1 (3.77m x 2.78m)

With windows overlooking the rear garden, ceiling spotlights, tiled flooring, door to Lounge and double doors opening onto rear garden.

LOUNGE 14'7 x 12'1 (4.45m x 3.68m)

With electric feature fireplace, window to rear elevation and door to Garden Room.

FAMILY ROOM 16'1 x 7'9 (4.90m x 2.38m)

With radiator and window to front elevation.

LANDING

With airing cupboard.

MASTER BEDROOM 11'10 x 12'1 (3.60m x 3.68m)

With radiator, built-in wardrobes, two windows to front elevation overlooking the open green and door to

EN-SUITE

Fitted with a three piece suite comprising wash-hand basin with cupboard below, recessed shower enclosure, WC, tiled flooring and surround, radiator and window to front elevation.

BEDROOM TWO 10'3 x 8'9 (3.11m x 2.67m)

With radiator, built-in wardrobes and window to rear elevation.

BEDROOM THREE 12'6 x 8'2 (3.81m x 2.47m)

With radiator, built-in wardrobes and window to front elevation.

BEDROOM FOUR 11'3 x 8'1 (3.43m x 2.46m)

With radiator and window to rear elevation.

FAMILY BATHROOM

Re-fitted with a modern three piece suite comprising panelled bath with shower over and glass screen, pedestal wash-hand basin, WC, tiled flooring, heated towel rail and window to rear elevation.

OUTSIDE

To the front of the property there is a spacious block-paved driveway providing ample off-road parking, with a mature cherry tree set in ornamental gravelling.

The rear garden comprises a block-paved patio seating area leading off from the Lounge and Garden Room, in turn opening onto lawns with mature planted borders and gated side access.

EPC RATING: C

COUNCIL TAX BAND: D (SKDC)

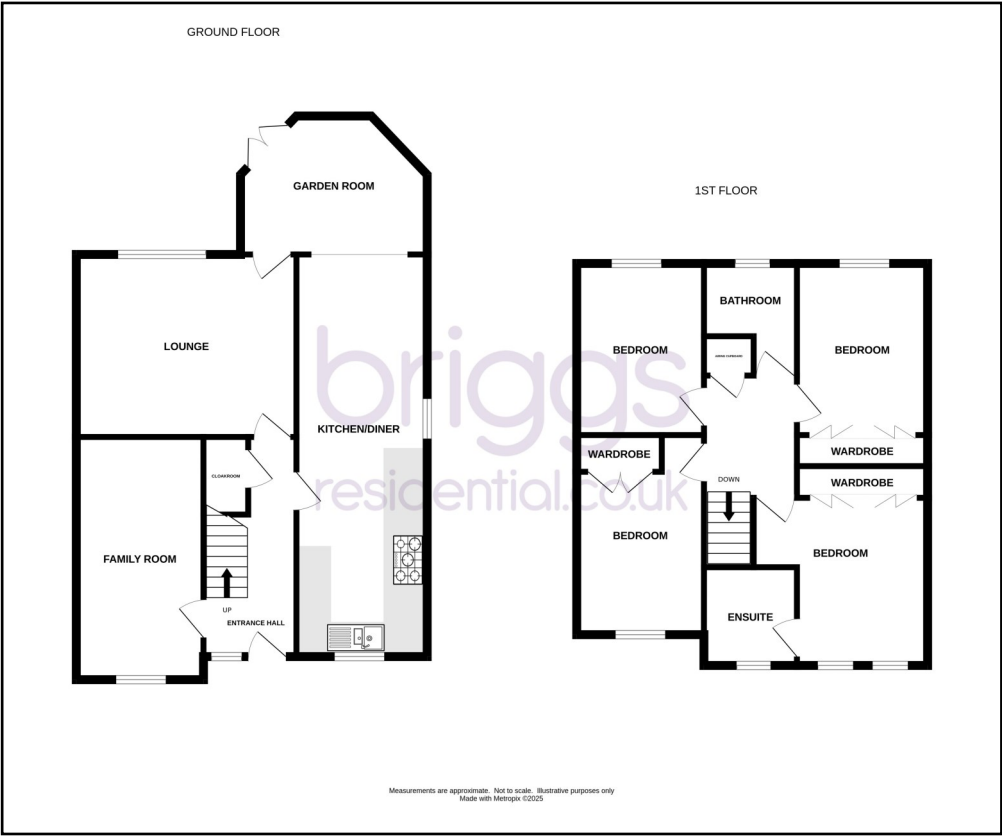

These particulars do not constitute part or all of an offer or contract. The measurements and details are supplied for guidance only and as such must be considered incorrect. Potential buyers are advised to recheck the measurements before committing to any expense. Briggs Residential have not tested any apparatus, equipment, services, fixtures or fittings and it is in the buyers interest to check the working condition of appliances. Briggs Residential have not sought to verify the legal title or structure of the property and suggest buyers obtain such verification from their solicitors.