



Tel: 01242 676767

www.cotswoldestateagents.co.uk

41a Church Road, Bishops Cleeve, Cheltenham, GL52 8LP

33, Churchfields
Bishops Cleeve GL52 8LL

£205,000



FOR SALE

Open plan lounge/dining kitchen area. window to side aspect, double glazed door to patio and rear garden, stairs to landing and first floor living accommodation, wooden laminate flooring and modern fitted kitchen fitted with a matching range of eye and base level storage units with built-in and integrated appliances to include fan-assisted oven, ceramic hob with extractor hood, integrated fridge-freezer, washing machine, dishwasher and breakfast bar.

First floor landing, doors to shower room and bedroom. Shower room: fully tiled white suite with built-in quadrant shower unit, fitted with Mira shower unit, vanity unit, WC with concealed cistern, chrome heated towel radiator and stone effect ceramic tile flooring. Bedroom one: window to front aspect with views to Cleeve Hill, trap to loft space, built-in wardrobe housing wall mounted gas combination boiler and built-in airing cupboard.

Exterior front garden: being walled and mainly laid to stone chipping, block paved hard standing for one vehicle and gated access to rear garden. Rear garden: East facing garden enclosed with brick walling, patio area, mostly laid to lawn and stocked with various flowers and shrubs including a mature clematis and storage shed.







Ground Floor

Approx. 22.1 sq. metres (238.0 sq. feet)

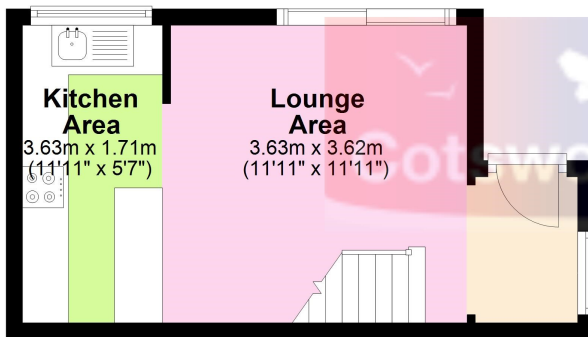

First Floor

Approx. 19.6 sq. metres (211.4 sq. feet)

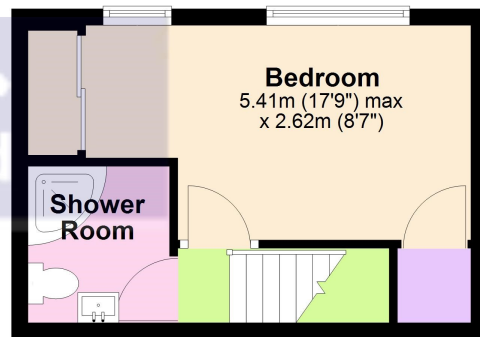

Total area: approx. 41.8 sq. metres (449.4 sq. feet)

