



Buller Road, Thornton Heath, Surrey, CR7 8QX

£550,000 Freehold

- Stunning end of terrace family home
- Impressive dual aspect lounge with dining area
- Upstairs bathroom with separate shower & downstairs WC
- Two garages & ample off street parking
- Conservatory
- Mature private garden with patio area

Buller Road, Thornton Heath, Surrey, CR7 8QX

£550,000 Freehold

Situated on a popular residential road in Thornton Heath, this larger-than-average 1930s end of terrace home offers generous living space, timeless charm and exceptional outdoor space — all within walking distance of the beautiful Grangewood Park.

Lovingly owned and maintained by the same family for over three decades, this much-loved home is filled with warmth and character.

Buller Road

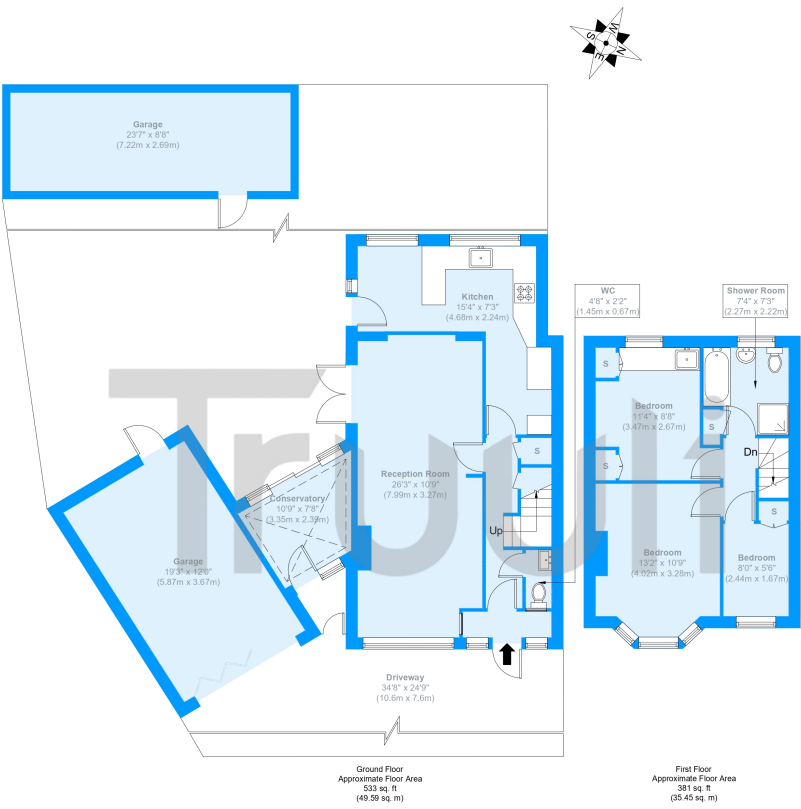

Approximate Gross Internal Area = 85.04 sq m / 915 sq ft

Garage = 39.6 sq m / 426 sq ft

Conservatory = 6.1 sq m / 65 sq ft

Total = 130.74 sq m / 1407 sq ft

The Floor plan is not to scale and measurements and areas shown are approximate and therefore should be used for illustrative purposes only. The plan has been prepared in accordance with the RICS code of Measuring Practice and whilst we have confidence in the information produced it must not be relied on. Maximum lengths and widths are represented on the floor plan. If there is any aspect of particular importance, you should carry out or commission your own inspection of the property.
Copyright @ BleuPlan

