



- Well Presented Bungalow
- Stunning Newly Fitted Kitchen/Breakfast Room
- Two Bedrooms
- Cosy Living Room
- Generous Rear Garden
- Potential To Extend (STPP)
- Driveway Providing Ample Off Road Parking

24 Lowefields, Earls Colne, Colchester, Essex. CO6 2LH.

Situated in Lowefields in Earls Colne, this recently renovated two-bedroom bungalow embodies modern comfort and potential for further expansion. The property welcomes with a charming curb appeal, boasting off-road parking and an enchanting rear garden, presenting an inviting retreat for residents.



Property Details.

Room Measurements

Entrance Hall

Living Room



4.80m x 3.10m (15' 9" x 10' 2")

Kitchen/Breakfast Room



4.09m x 3.10m (13' 5" x 10' 2")

Bedroom One



3.05m x 2.84m (10'

Property Details.

0" x 9' 4")

Bedroom Two



3.10m x 2.11m (10'
2" x 6' 11")

Bathroom



1.85m x 1.70m (6' 1"
x 5' 7")

Property Details.

Floorplans

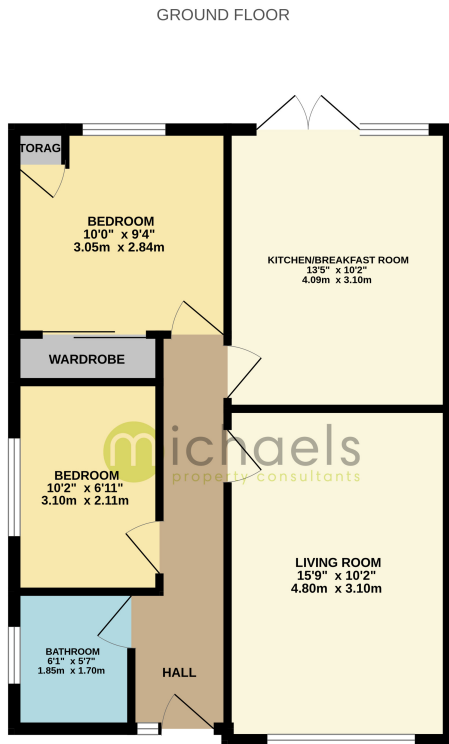

Whilst every attempt has been made to ensure the accuracy of the floorplan contained herein, measurements of doors, windows, rooms and any other items are approximate and no responsibility is taken for any error, omission or mis-statement. This plan is for illustrative purposes only and should be used as such by any prospective purchaser. The services, systems and appliances shown have not been tested and no guarantee as to their operability or efficiency can be given.
Made with Intergo 03/2021

Location

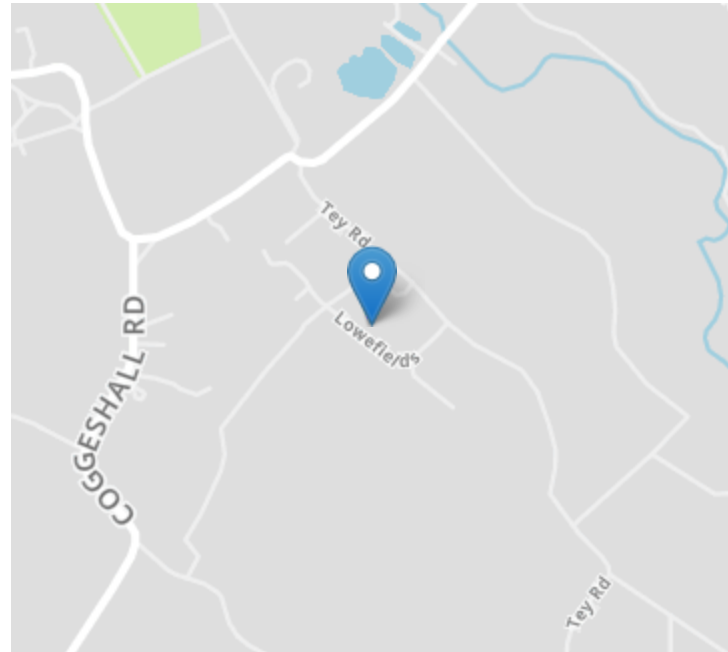

Energy Ratings

We have not carried out a structural survey and the services, appliances and specific fittings have not been tested. All photographs, measurements, floor plans and distances referred to are given as a guide only and should not be relied upon for the purchase of carpets or any other fixtures or fittings. Gardens, roof terraces, balconies and communal gardens as well as tenure and lease details cannot have their accuracy guaranteed for intending purchasers. Lease details, service ground rent (where applicable) are given as a guide only and should be checked and confirmed by your solicitor prior to exchange of contracts.