



Alder Close, Baldock, Hertfordshire. SG7 6HN





1 Bedroom Flat

£170,000 Leasehold

Offered to the market on a chain free basis, is this one bedroom first floor apartment. The property benefits from having its' own front door and offers good sized accommodation throughout. Based in this popular and convenient residential turning, the property also has allocated parking and is within touching distance of Baldock High Street.

- Chain free
- Central location
- Allocated parking
- Viewing recommended
- Great size
- One bedroom
- Rear garden
- EPC rating C. Council tax band B

Ground Floor:**Entrance:**

Via own front door.

Hallway:

Easy access to all rooms.

Lounge:

Abt. 12' 0" x 12' 0" (3.66m x 3.66m) Double glazed window to rear aspect. Radiator.

Kitchen:

Abt. 7' 0" x 12' 5" (2.13m x 3.78m) Double glazed window to front aspect. Range of fitted wall and base units. Stainless steel sink and drainer. Lino flooring.

Bedroom:

Abt. 10' 0" x 12' 0" (3.05m x 3.66m) Two double glazed windows to front aspect. Fitted wardrobe. Radiator.

Bathroom:

Double glazed window to side aspect. Suite comprising low level WC, wash hand basin and panelled bath.

External:**Outside:**

Personal front door. Rear garden. Allocated parking.



These particulars are a guide only and do not constitute an offer or a contract. The floor plan is for identification purposes only and not to scale. All measurements are approximate and should not be relied upon if ordering furniture, white goods and flooring etc. We have presented the property as we feel fairly describes it but before arranging a viewing or deciding to buy, should there be anything specific you would like to know about the property please enquire. Satchells have not tested any of the appliances or carried out any form of survey and advise you to carry out your own investigations on the state, condition, structure, services, title, tenure, and council tax band of the property. Some images may have been enhanced and the contents shown may not be included in the sale. Satchells routinely refer to 3rd party services for which we receive an income from their fee. If you would like us to refer you to one of these services please ask one of our staff who will pass your details on. We advise you check the availability of the property on the day of your viewing.

First Floor

Approx. 61.6 sq. metres (663.4 sq. feet)

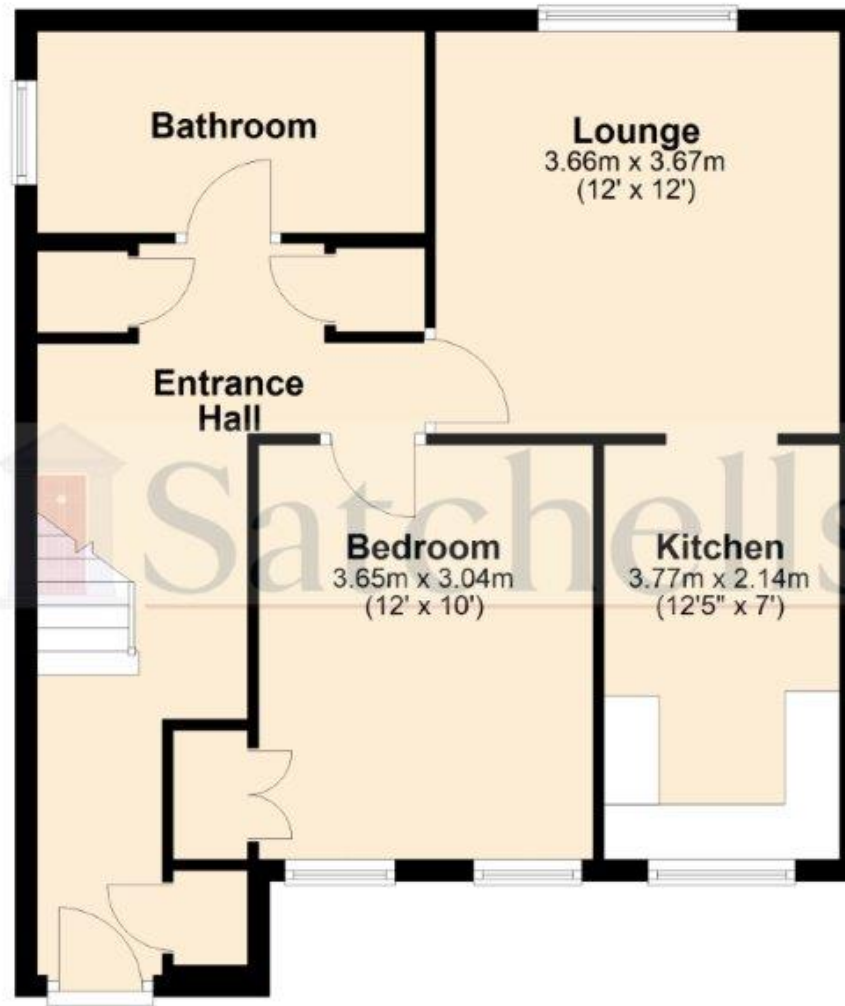

Total area: approx. 61.6 sq. metres (663.4 sq. feet)

For illustration purposes only - NOT TO SCALE - Measurements shown are approximate. The size and position of doors, windows, appliances and other features are approximate.
Plan produced using PlanUp.