

TO LET  
£1,700 pcm

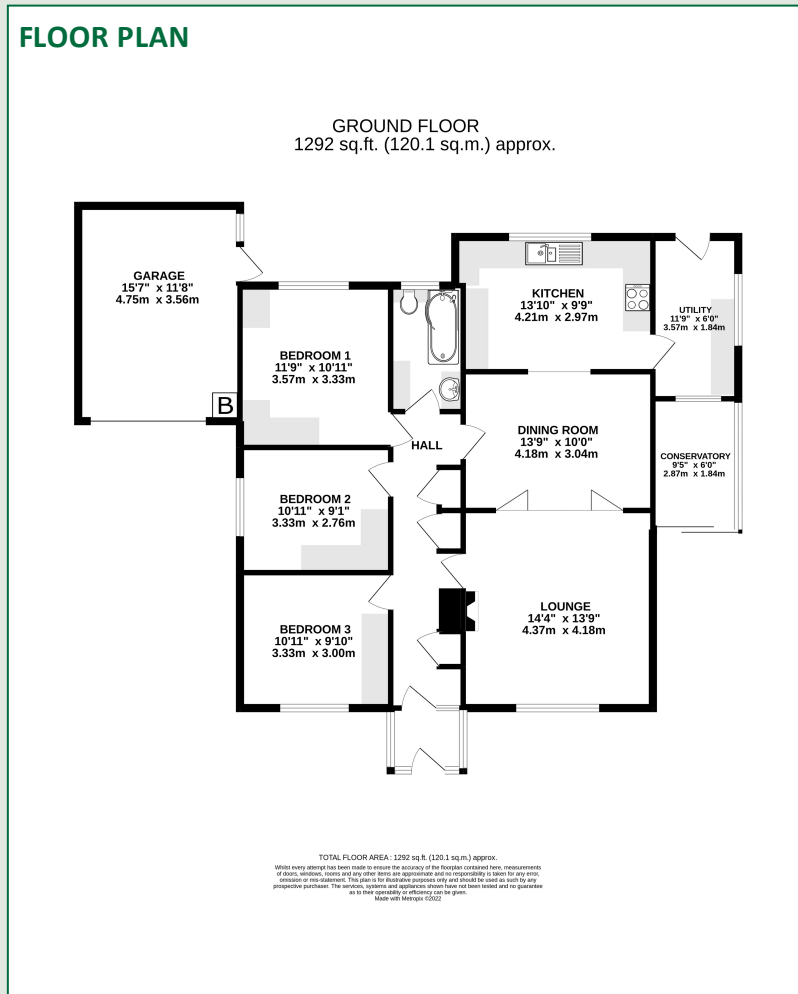

**DESCRIPTION**

A deceptively large three bedroom detached bungalow situated in a tucked away position at the end of a cul de sac on the fringe of Thatcham town. Set in lovely mature garden.



**ENERGY EFFICIENCY RATING**

Energy Efficiency Rating		Current	Potential
Very energy efficient - lower running costs			
(92-100)	<b>A</b>		
(81-91)	<b>B</b>		81
(69-80)	<b>C</b>		
(55-68)	<b>D</b>	61	
(39-54)	<b>E</b>		
(21-38)	<b>F</b>		
(1-20)	<b>G</b>		
Not energy efficient - higher running costs			
England, Scotland & Wales		EU Directive 2002/91/EC	

