



Alpha Road, Croydon, Surrey, CR0 6TH

£230,000 Leasehold

- Chain free
- Loft storage
- End of terrace building
- Bright and airy maisonette
- Period conversion
- Excellent and efficient transport links

Alpha Road, Croydon, Surrey, CR0 6TH

£230,000 Leasehold

Located in a popular and convenient area, this delightful first-floor one-bedroom maisonette on Alpha Road offers a perfect blend of space, comfort and practicality and is offered to the market with no onward chain.

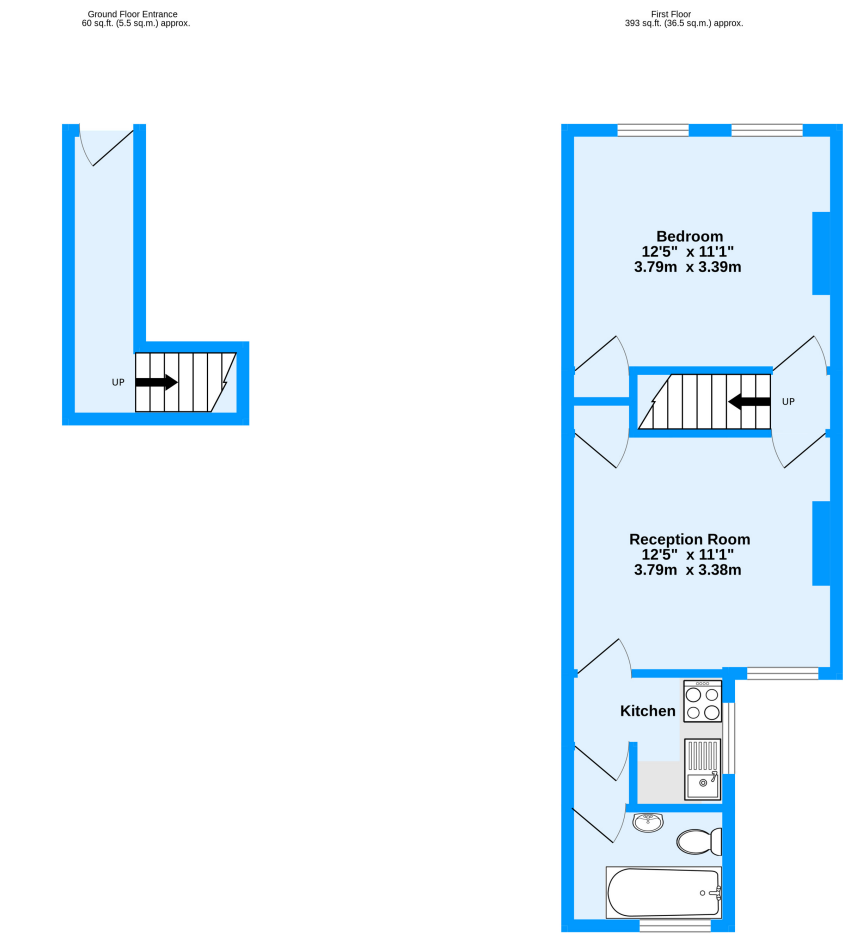

Alpha Road, Croydon, CR0

TOTAL FLOOR AREA : 452 sq.ft. (42.0 sq.m.) approx.

Measurements are approximate. Not to scale. Illustrative purposes only

Made with Metropix ©2024

