

16 Tinus Avenue, Hampton Vale, Peterborough, PE7 8HZ

Capitol Lettors

Capitol Lettors Sales & Letting Agents

PO Box 1476, Peterborough, Cambs, PE2 2WX

Tel: 01733 553366

Email: Enquiries@capitollettors.com • www.capitollettors.com

VAT No. 922 2845 32 • Company Registration No. 6218276



16 Tinus Avenue, Hampton Vale, Peterborough, PE7 8HZ

£140,000 Leasehold

Capitol Lettors are happy to advertise this 1st floor flat in Hampton Vale. This two bedroom flat offers UPVC double glazing and electric heating throughout, entrance hall, kitchen, lounge/diner, two bedrooms and bathroom. Outside the property has a communal parking area with a single garage with up and over door.

Service Charge £1606.69 per annum, Ground Rent £130 per annum, & 70 years remaining on lease. These figure are approximate & will need to be confirmed via your solicitor.

Capitol Lettors has not tested any of the equipment or the heating system (if mentioned) in these details. Purchasers are advised to satisfy themselves as to their working order and condition. These particulars do not constitute or form any part of an offer or contract nor may they be regarded as representations. All interested parties must themselves verify their accuracy. All measurements are approximate.



www.capitollettors.com

Zoopa.co.uk
Smarter property search

16 Tinus Avenue, Hampton Vale, Peterborough, PE7 8HZ

HALLWAY

4.85m (15'11") x 1.19m (3'11")
Flat Door, Loft hatch, fuse board,
cupboard housing water tank, entry
phone system, electric heater, fitted
carpet.

LOUNGE/DINER

4.55m (14'11") x 3.63m (11'11")
UPVC window to front, electric heater,
fitted carpet.

KITCHEN/DINER

2.72m (8'11") x 2.03m (6'8")
UPVC window to rear, fitted kitchen
with base and eye level units, sink unit
with mixer taps, tiled splash backs,
matching worktops, electric oven,
electric hob and extractor hood, space
for fridge/freezer and washing
machine.

BEDROOM ONE

3.33m (10'11") x 3.33m (10'11")
UPVC window to the front aspect,
electric heater, fitted carpet.

BEDROOM TWO

3.33m (10'11") x 2.11m (6'11")
UPVC window to the rear aspect,
electric heater, fitted carpet.

BATHROOM

UPVC window to the rear, three piece
suite comprising of paneled bath with
shower over, pedestal wash hand basin
and low level WC, part tiled walls.

OUTSIDE

There is a communal car parking area
to the rear with a single garage with an
up and over door.

16 Tinus Avenue, Hampton Vale, Peterborough, PE7 8HZ

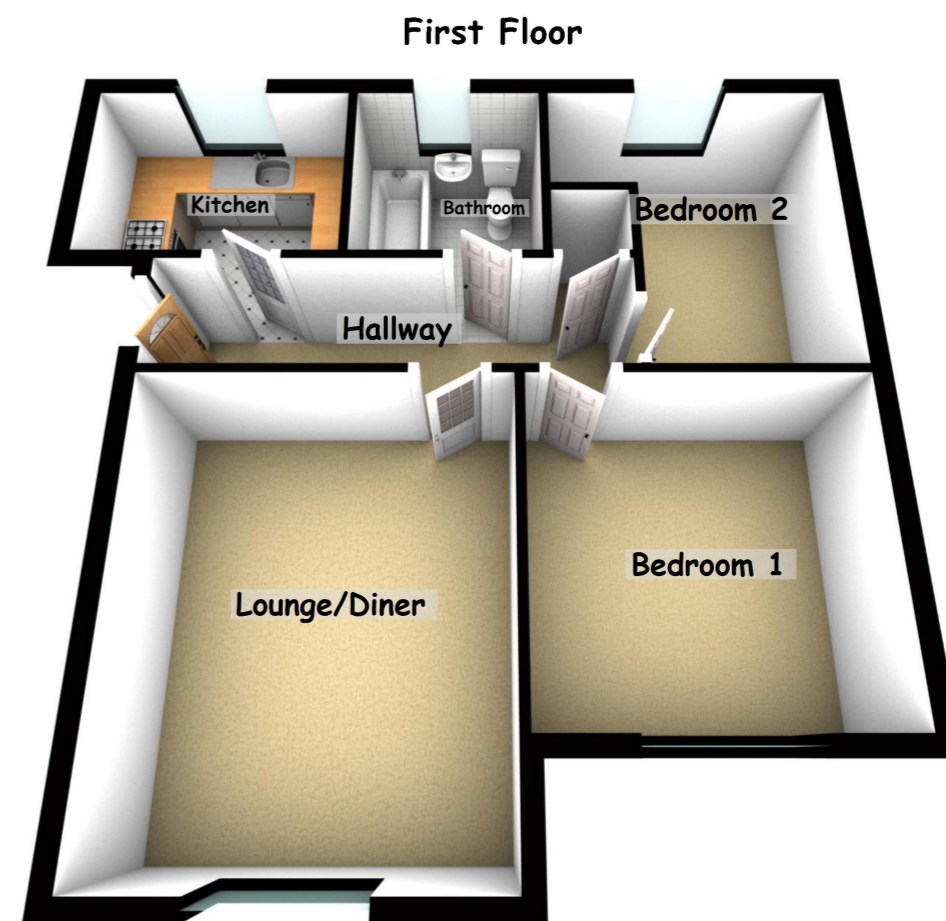

This plan is for illustration purposes only and may not be representative of the property. Plan may not be to scale.

Plan produced using PlanUp.

Tinus Avenue

