

38 Bedford Road, Lower Stondon, Bedfordshire, SG16 6DZ

£240,000

Character cottage situated close to local amenities and open countryside yet within striking distance of a railway station and the A1 motorway. Cosy lounge with feature fireplace with log burner, fitted kitchen/breakfast room with built in hob, oven and extractor. Upstairs are two bedrooms with a shower room of the ,main bedroom and outside is a south facing courtyard garden with brick built shed. CALL TO VIEW



38 Bedford Road Lower Stondon

Approximate Gross Internal Area
527 sq ft - 49 sq m

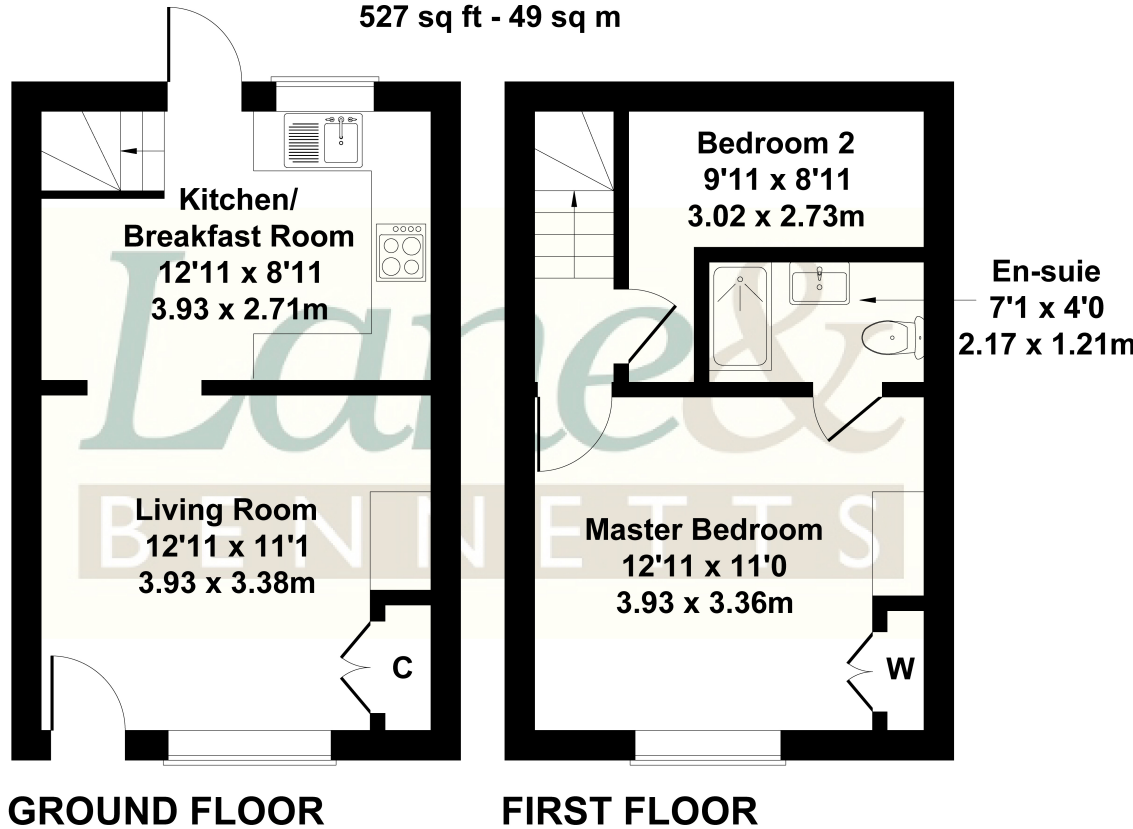

Not to Scale. Produced by The Plan Portal 2024
For Illustrative Purposes Only.

- CHARACTER COTTAGE
- CLOSE TO LOCAL AMENITIES & OPEN COUNTRYSIDE
- LIVING ROOM WITH FEATURE FIREPLACE
- LOG BURNER
- TWO BEDROOMS
- UPSTAIRS SHOWER ROOM OFF BEDROOM 1
- SOUTH FACING COURTYARD GARDEN
- BRICK BUILT STORE
- CLOSE TO HITCHIN + ARLESEY TRAIN STATION

