



2, 5 Bolebrooke Road, Bexhill On Sea, East  
Sussex, TN40 1EN

£209,950



- Spacious 1st Floor Apartment
- Large Lounge With Bay Window
- Fitted Kitchen
- Two Spacious Double Bedrooms
- Family Bathroom Offering Separate Shower & Bath
- Sea Views From Bay Window
- Gas Central Heated & Double Glazed Throughout
- Neutrally Decorated & Well Presented Throughout
- Well Presented & Secure Communal Entrance
- Town Centre & Seafront Location
- Sold With No Onward Chain
- Viewing Highly Recommended.





**GROUND FLOOR**  
**719 sq.ft. (66.8 sq.m.) approx.**

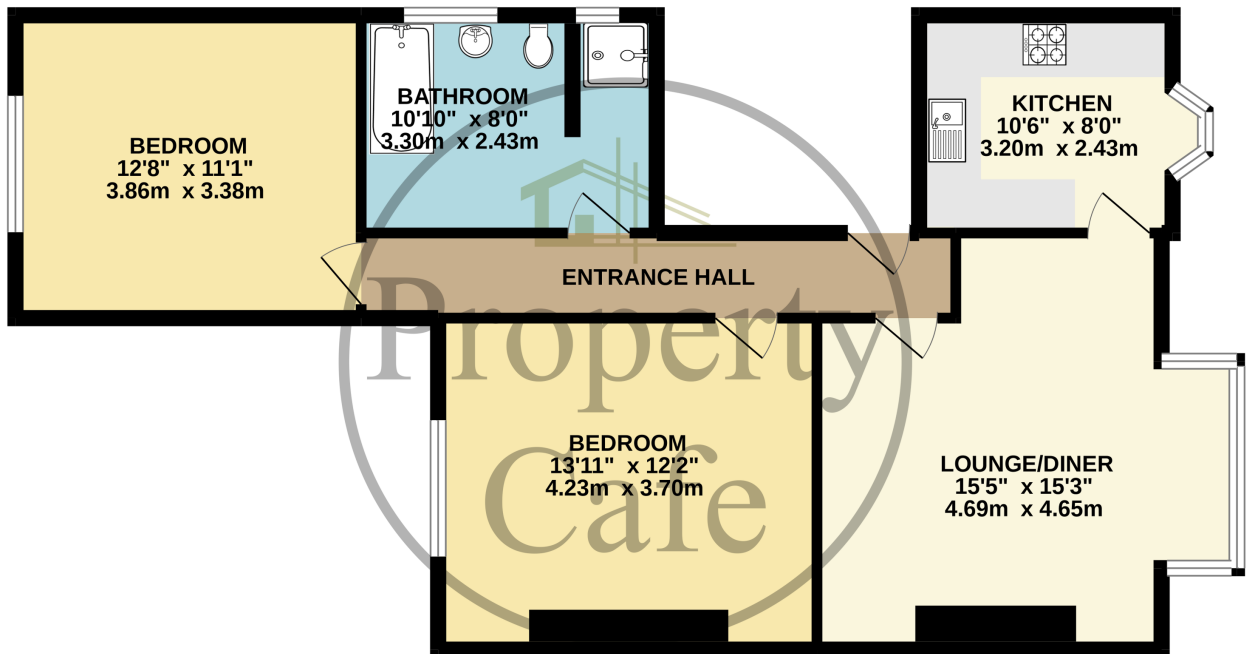

TOTAL FLOOR AREA : 719 sq.ft. (66.8 sq.m.) approx.

Whilst every attempt has been made to ensure the accuracy of the floorplan contained here, measurements of doors, windows, rooms and any other items are approximate and no responsibility is taken for any error, omission or mis-statement. This plan is for illustrative purposes only and should be used as such by any prospective purchaser. The services, systems and appliances shown have not been tested and no guarantee as to their operability or efficiency can be given.

Made with Metropix ©2022