



## The Windmills, Broomfield, Chelmsford, Essex, CM1 7FD

Council Tax Band C (Chelmsford City Council)



£350,000 Freehold

## ACCOMMODATION

This well presented end of terrace family home offers accommodation comprising an entrance hall, cloakroom, fitted kitchen, living/dining room with door leading out to the garden, three bedrooms and family bathroom with modern white suite. Externally the property benefits from a block paved driveway providing off road parking to front and an attractive South facing rear garden which is mainly laid to lawn with a patio area.

## LOCATION

Set in the popular parish of Broomfield which is situated to the North of Chelmsford, The Windmills is a no through road situated within walking distance of Broomfield Hospital and Chelmer Valley High School. Broomfield offers a popular primary school as well as Chelmer Valley High Schools. Both of Chelmsford's highly sought after grammar schools, King Edward VI grammar school and The County High School for girls are within a bus ride from the property from either Court Road or Hospital Approach.

The parish of Broomfield offers a village like feel with its own Church and church green, two local pubs/restaurants, library, local newsagents/convenience store, a football club and cricket club. Situated to the North of Chelmsford city centre, Broomfield offers a regular bus service to the city centre and mainline station.

Chelmsford city centre offers a thriving nightlife with a selection of bars and a wide selection of places to eat from independent family restaurants to well known chain restaurants serving cuisines from around the world, Chelmsford features a comprehensive range of shopping facilities with its pedestrianised High Street, two shopping precincts and hugely popular Bond Street with John Lewis store.

Chelmsford is extremely popular with leisure enthusiasts with a selection of sports clubs and gyms including the newly refurbished Riverside Ice & Leisure.

Chelmsford is renowned for its educational excellence and alongside the local schools, it offers two of the country's top performing grammar schools, Writtle agricultural college, Anglia Ruskin University and a selection of private schools.

TENURE: Freehold

COUNCIL TAX BAND: C

MAINTENANCE CHARGE PAYABLE TO HML GROUP: £101.13pa

- Well Presented End Of Terrace Home
- South Facing Rear Garden
- Fitted Kitchen
- Cloakroom

- Three Bedrooms
- Living/Dining Room
- Block Paved Driveway
- Sought After Parish of Broomfield







## GROUND FLOOR

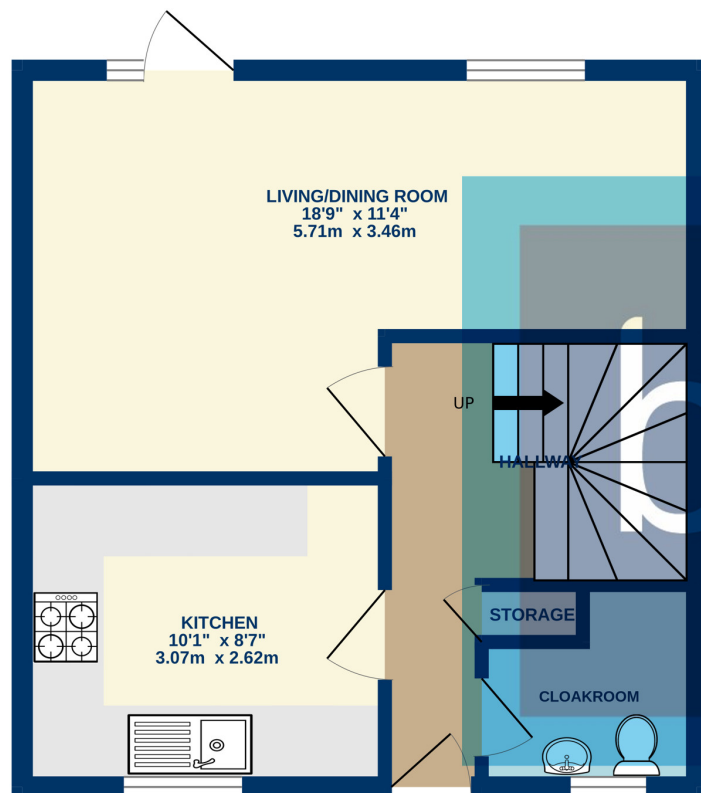

## 1ST FLOOR

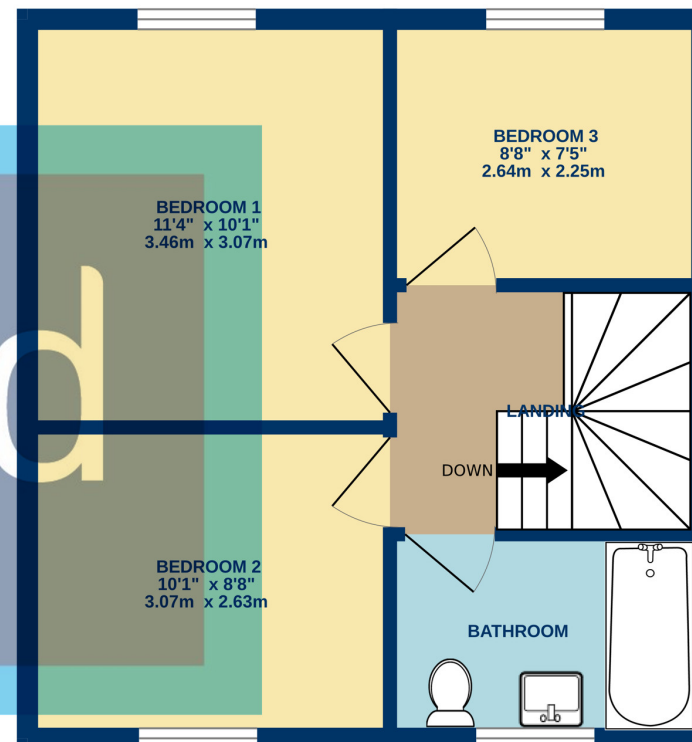

Whilst every attempt has been made to ensure the accuracy of the floorplan contained here, measurements of doors, windows, rooms and any other items are approximate and no responsibility is taken for any error, omission or mis-statement. This plan is for illustrative purposes only and should be used as such by any prospective purchaser. The services, systems and appliances shown have not been tested and no guarantee as to their operability or efficiency can be given.  
Made with Metropix ©2023

Consumer Protection from Unfair Trading Regulations 2008 and the Business Protection from Misleading Marketing Regulations 2008. Bond Residential have made every effort to ensure that consumers and/or businesses are treated fairly and provided with accurate material information as required by law. We have not tested any apparatus, equipment, fixture, fitting or any services and as such are unable to verify they are in working order, fit for their purpose, or within the ownership of the seller or landlord. Neither have we been able to check the legal documentation to verify the legal status of the property. We therefore advise potential buyers or tenants to verify these matters with their own solicitors or other advisers.

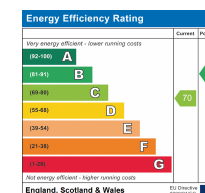

78, New London Road,  
Chelmsford, Essex, CM2 0PD  
Telephone: 01245 500599  
Website: [www.bondresidential.co.uk](http://www.bondresidential.co.uk)