



Nevis Way, York YO24 2XE

£350,000 EPC Rating - D

Approx. Gross Internal Floor Area 830 sq. ft 77.11 sq. m

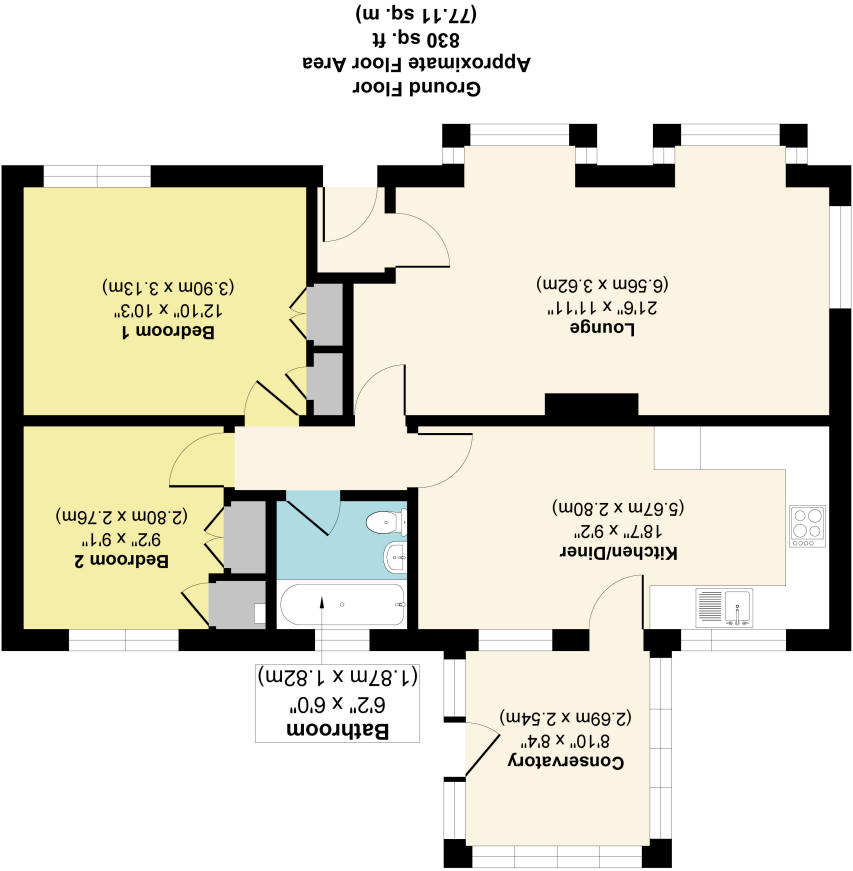
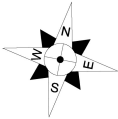

Illustration for identification purposes only, measurements approximate, not to scale.
Copyrighted and Produced by MS Property Marketing.

Our property particulars do not represent an offer or contract, or part of one. The information given is without responsibility on the part of the agents, sellers or lessors) and you should not rely on the information as being factually accurate about the property, its condition or its value. Neither redmove nor anyone in its employment or acting on its behalf has authority to make any representation or warranty in relation to this property. We have not carried out a detailed survey, nor tested the services, appliances or fittings at the property. The images shown may only represent part of the property and are as they appeared at the time of being photographed. The areas, measurements and distances are approximate only. Any reference to alterations or use does not mean that any necessary planning permission, building regulation or other consent has been obtained.

YORK 01904 488 444

23B Whitby Avenue
York
YO31 1EU

info@redmove.co.uk

17 Nevis Way, York YO24 2XE

Offered for sale with no onward chain is this spacious detached bungalow situated on a corner plot with a south facing rear garden! The property briefly comprises; entrance hall, a bright and spacious living room, large dining kitchen, two good sized double bedrooms each with fitted wardrobes, a three piece house bathroom and a conservatory overlooking the garden. Externally the property boasts a great south facing garden with mature borders, a large detached double garage, driveway for ample off street parking and low maintenance front and side gardens. This property is ready to move in to and enjoy yet also offer the potential to extend and improve (STPP). Located in the desirable area of Acomb Park, close to local amenities and with great road networks close by. We feel viewing is needed to truly appreciate the accommodation on offer.

- Detached Bungalow
- Two Double Bedrooms
- Large Dining Kitchen
- Spacious Living Room
- Consevratory
- Bathroom
- South Facing Garden
- Large Detached Double Garage
- Off Street Parking
- Built In Wardrobes
- Opportunity to Extend STPP

Leave York via Tadcaster Road and at the roundabout turn right onto Moor Lane. Proceed along Moor Lane for some distance before taking a right hand turning into Alness Drive. Take the left hand turning into Nevis Way. The property is located on the left hand side and can be identified by our For Sale sign.

Nevis Way forms part of the popular Acomb Park/Woodthorpe area, to the West of York. This location is well placed for access to the outer ring road and the A64 bypass. There is a good range of local amenities and a regular bus service to York city centre. The is also the park and ride nearby forming part of the Tesco Superstore complex.

