

# Cheddar Woods

BS27 3DB

COOPER  
AND  
TANNER



## £50,000

An opportunity to own a pre-loved lodge in good condition set within an award winning development. It is set within spacious plot, the lodge is ideal for those looking for a holiday home.

# Cheddar Woods

BS27 3DB



3



1



1

EPC TBC

## £50,000

### DESCRIPTION

A unique opportunity to own a pre-loved lodge available on an elevated plot, this lodge is ideal for those looking for the perfect holiday home. The Lodge blends style with function, light and space and innovation with design-all combined in perfect harmony.

The kitchen is filled with light and is fully fitted and leads into the living room which is furnished with sofas and a dining room table and opens onto the balcony.

The clever space continues into the master bedroom, there is entry into the bathroom which is Jack and Jill style. There are two further bedrooms and a cloakroom.

### OUTSIDE

Outside the lodge, you can relax on the spacious balcony, complete with rattan furniture, enjoying southerly views to the front. You also have allocated block paved parking.

On site there are plenty of amenities, something to please everyone! Ranging from facilities such as tennis, basketball, five-a-side football, climbing walls, a farm shop heated swimming pool sauna and steam room, fitted gymnasium, spas, golf stimulator, ten pin bowling, restaurant and bar. There really is something for all the family to enjoy. Cheddar Woods is the ideal location for a family get away.

### LOCATION

Situated at the foot of the Mendip Hills, Cheddar is an ideal base from which to enjoy wonderful country walks. The village itself has a wide range of shops to cater for everyday needs, banks, a building society and a Post Office as well as doctor and dentist surgeries. Road links are excellent, with easy access to the A38. Bristol is only 30 minutes away and the M5 motorway approximately 20 minutes. Public transport is well represented with a bus service passing through the village every hour linking Cheddar with Axbridge, Weston Super Mare and Wells. Local attractions include Cheddar Gorge, Wookey Hole Caves, Glastonbury Tor and the seaside at Weston Super Mare.

### DIRECTIONS

From our office, turn right and proceed to the Market Cross. Turn right again and proceed out of the village for approximately two miles on the A371. Once out of Cheddar you will pass a Petrol Station and a right hand turning indicating Shipham. Continue around the left-hand bend and the entrance to Cheddar Woods will be found approximately 100 yards along on the right hand side.





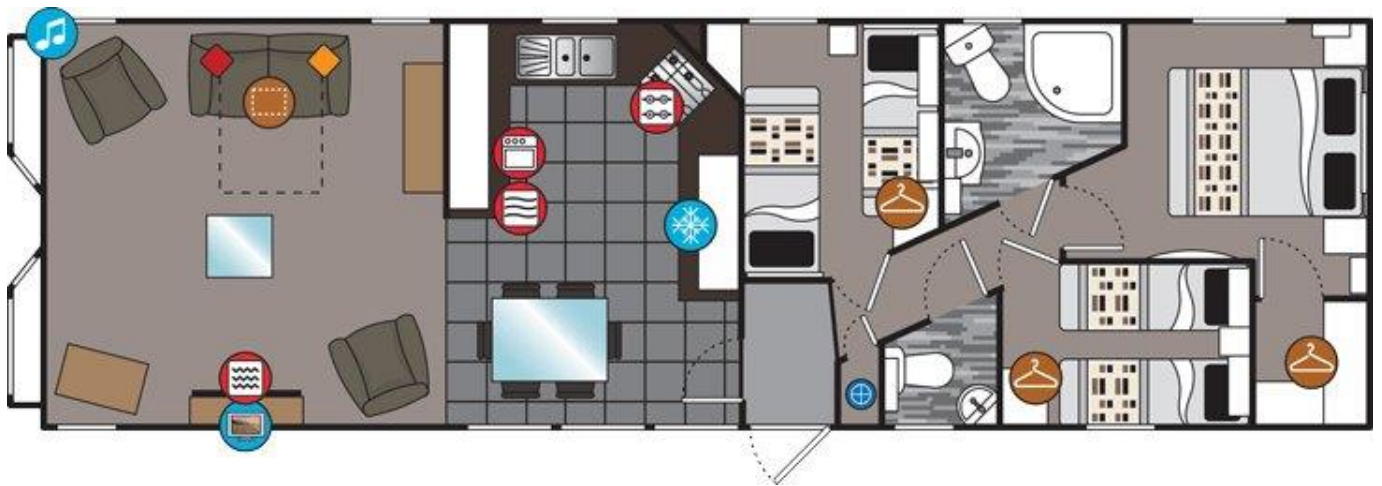

## CHEDDAR OFFICE

Telephone 01934 740055

Unit 2, Union Street, Cheddar, Somerset BS27 3NA

[cheddar@cooperandtanner.co.uk](mailto:cheddar@cooperandtanner.co.uk)

**COOPER  
AND  
TANNER**

Important Notice: These particulars are set out as a general outline only for the guidance of intended purchasers and do not constitute, nor constitute part of, an offer or contract. All descriptions, dimensions, reference to condition and necessary permissions for use and occupation, warranties and other details are given without responsibility and any intending purchasers should not rely on the map as statements or representations of fact but must satisfy themselves by inspection or otherwise as to the correctness of each of them.

