



Bedford Road

Maples Court | Bedford Road | Hitchin | Hertfordshire | SG5 1HF

www.stonegate-estates.co.uk



BEDFORD ROAD

Property Description

Situated in a sought-after retirement development just moments from Hitchin town centre, this immaculately presented ground floor apartment with doors opening onto the communal gardens offers comfortable and convenient living for those aged 60 and over.

The property features very good accommodation throughout with the lounge benefitting from doors opening on to the communal gardens and the added feature of an external canopy fitted which opens over the lounge doors, perfect for enjoying fresh air and the gardens. The refitted kitchen looks fabulous and is complimented by the refitted modern shower room, there are two well-proportioned bedrooms all of which match the modern and immaculately presented feel of the wonderful ground floor retirement flat.

Residents also enjoy exclusive use of a communal lounge, laundry facilities, and beautifully maintained grounds.

With no onward chain, this apartment offers a fantastic opportunity to move straight in without any work or updating required for you to start enjoying your new lifestyle straight away.

Additional features include lift access, emergency pull cords, and a friendly on-site manager.

Early viewing is highly recommended.

£325,000 Leasehold



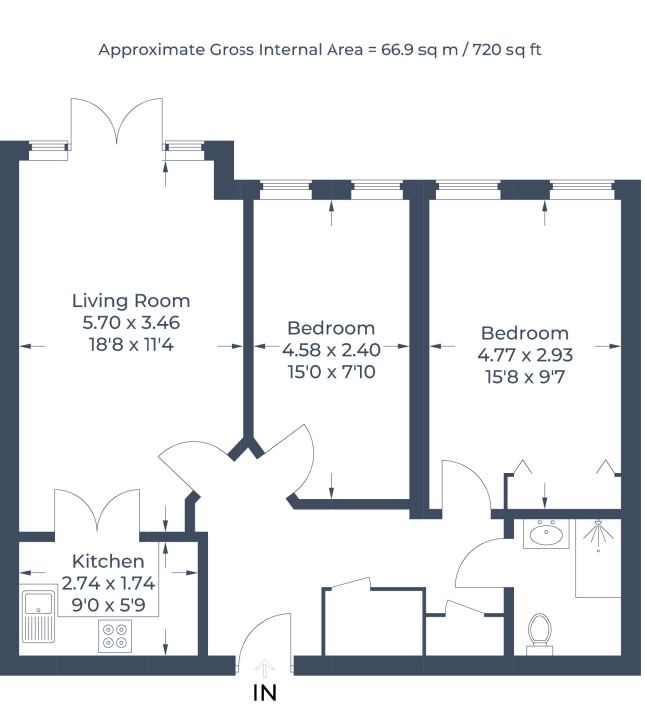

Illustration for identification purposes only,
measurements are approximate, not to scale.
© CJ Property Marketing Produced for Stonegate Estates



- Ground Floor Apartment
- Two Double Bedrooms
- Apartment Opens Directly onto Communal Gardens
- Immaculately Presented
- Chain Free Purchase
- Town centre Location
- Communal Gardens
- Parking on Site

EPC Rating: C

Stonegate Estate Agents

01462 438979

sales@stonegate-estates.co.uk | www.stonegate-estates.co.uk

