



- Three Bedroom Terraced House
- Garage & Allocated Parking
- Popular Marks Farm Development
- Generous Kitchen/Diner
- Double Aspect Living Room
- En Suite To Master Bedroom
- Well Presented Throughout
- Beautiful Rear Garden With Outbuilding/Studio
- Gas Central Heating & UPVC Windows
- Overlooking A Greensward

47 Gulls Croft, Braintree, Essex. CM7 3RT.

Michaels Property Consultants are delighted to bring to the market this well proportioned three bedroom terraced house, occupying a tranquil walk-way position within the ever popular Mark Farm Development. New to the market and offered for sale in excellent decorative order, we feel this superb property lends itself perfectly to first time buyers seeking a low maintenance purchase.



Property Details.

Ground Floor

Entrance Hall

Kitchen/Diner



16' 3" x 10' 6" (4.95m x 3.20m)

Cloakroom/WC

Lounge



First Floor

Bedroom One



10' 5" x 9' 8" (3.17m x 2.95m)

En Suite Shower Room



Property Details.

Bedroom Two



9' 10" x 8' 0" (3.00m x 2.44m)

Bedroom Three

7' 3" x 7' 1" (2.21m x 2.16m)

Family Bathroom



Outside

Rear Garden With Studio



Garage



Allocated Parking Space

Property Details.

Floorplans

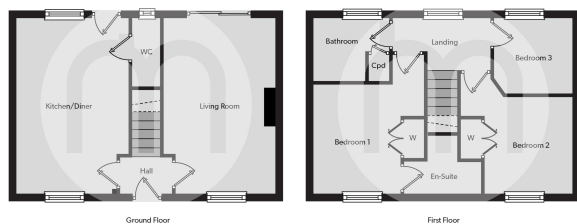

Location

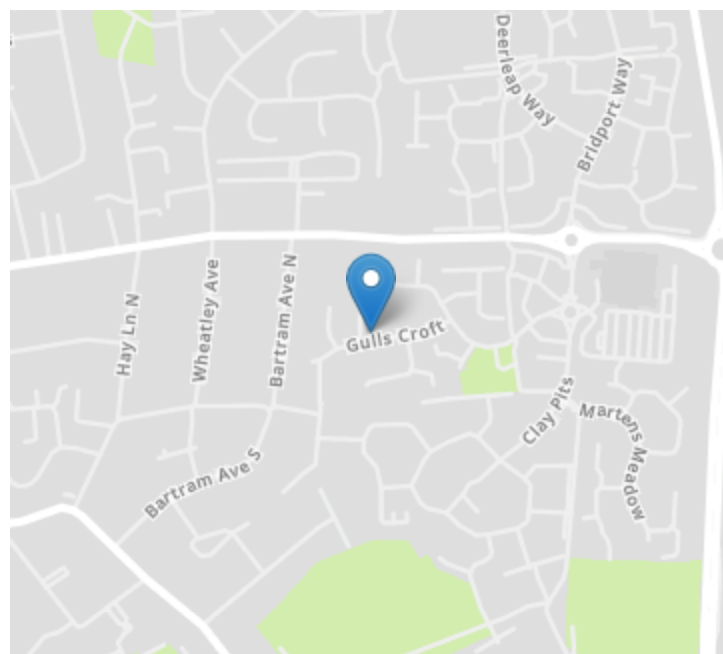

Energy Ratings

We have not carried out a structural survey and the services, appliances and specific fittings have not been tested. All photographs, measurements, floor plans and distances referred to are given as a guide only and should not be relied upon for the purchase of carpets or any other fixtures or fittings. Gardens, roof terraces, balconies and communal gardens as well as tenure and lease details cannot have their accuracy guaranteed for intending purchasers. Lease details, service ground rent (where applicable) are given as a guide only and should be checked and confirmed by your solicitor prior to exchange of contracts.