



Whitings Court

Paynes Park | HITCHIN | SG5 1EJ

www.stonegate-estates.co.uk



WHITINGS COURT

Property Description

A one bedroom retirement apartment in the heart of Hitchin located in Paynes Park with direct access to the Arcade, High Street and Market Place without having to cross any roads.

Located on the first floor the apartment benefits from a lift to access all floors, double glazing, a communal lounge, gardens . The development has a security entry system and a House Manager with each apartment having a 24 hour emergency call system in each room via the Careline System.

Hitchin town centre provides a broad range of shops and a regular traditional market; together with a good selection of restaurants, bars and pubs within its historic centre. The town also provides a swimming centre, theatres and a library; whilst the commuter is served by the mainline railway station (Kings Cross – 30 minutes) and direct road links to the A1(M)

£170,000 Leasehold





Approximate Gross Internal Area
 First Floor = 47.5 sq m / 511 sq ft

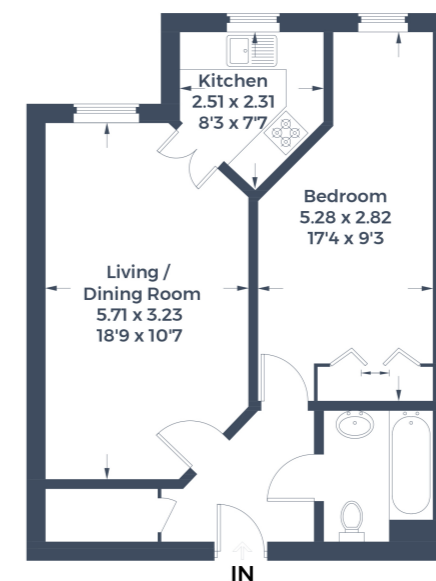

First Floor

This plan is for layout guidance only. Not drawn to scale unless stated. Windows and door openings are approximate. Whilst every care is taken in the preparation of this plan, please check all dimensions, shapes and compass bearings before making any decisions reliant upon them.
 © CJ Property Marketing Produced for Stonegate Estates



- One Bedroom
- Retirement Apartment
- First Floor Apartment
- Town Centre Location
- No Onward Chain
- 24 hour Careline System
- Development Manager
- communal Lounge & Garden
- Lift to all Floors
- View Over Garden

EPC Rating:

Stonegate Estate Agents

01462 438979

sales@stonegate-estates.co.uk | www.stonegate-estates.co.uk

