

FOR SALE

£350,000

Montgomery Hill, Frankby, Wirral. CH48 1NF



Semi-Rural Location! Fantastic opportunity to purchase this traditional semi-detached house with an open aspect over to the woodland of Royden Park at the front whilst also boasting a private rear garden.





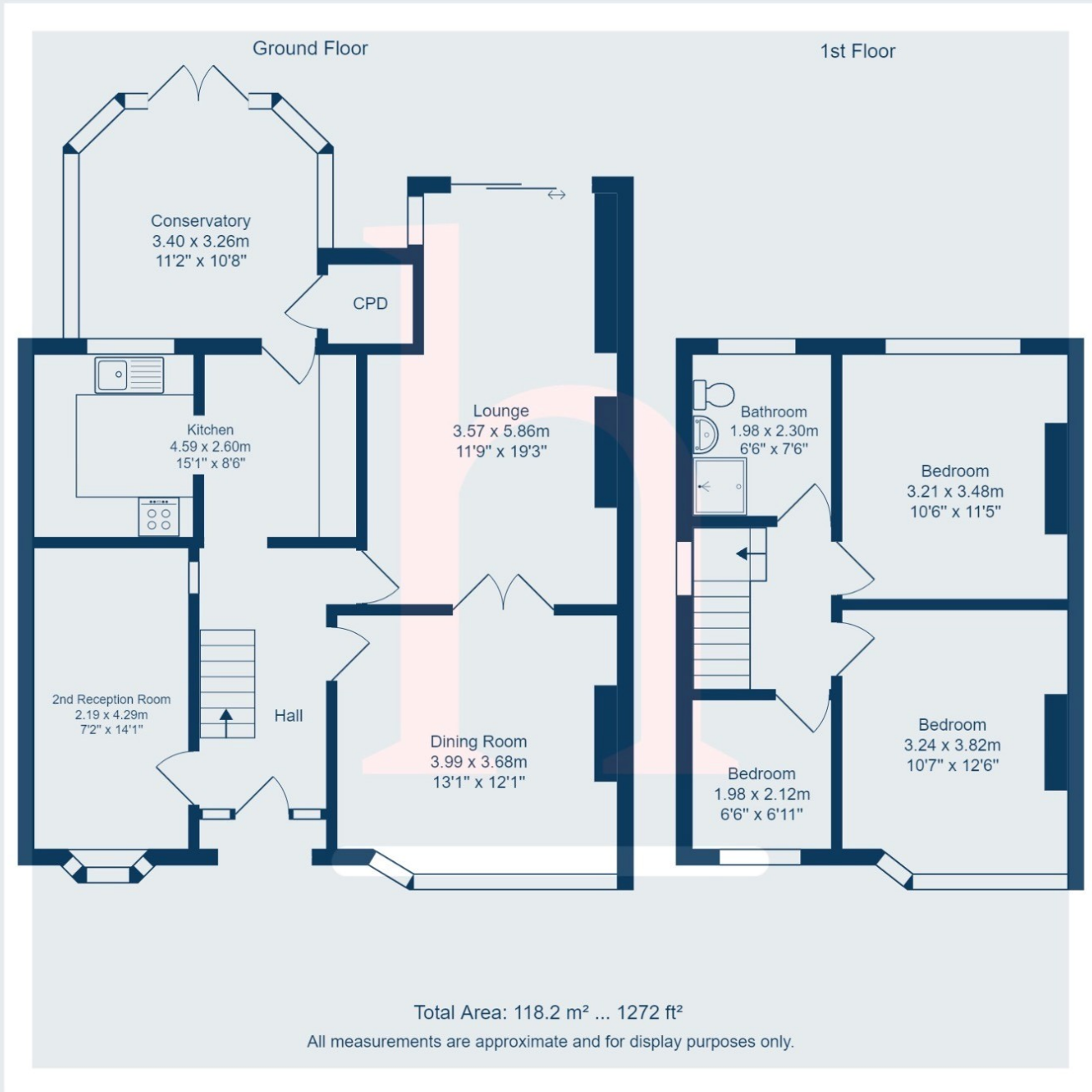

Energy Efficiency Rating		Current	Potential
Very energy efficient - lower running costs			
(92+)	A		
(81-91)	B		
(69-80)	C		79
(55-68)	D	58	
(39-54)	E		
(21-38)	F		
(1-20)	G		
Not energy efficient - higher running costs			
England, Scotland & Wales		EU Directive 2002/91/EC	