



Bromyard Avenue, London, W3 7FG

Cow & Co
LONDON



GUIDE PRICE £400,000-£500,000 A fantastic two-bedroom apartment is located on the first floor of this beautiful period building. The property is well-proportioned throughout and is presented in immaculate condition. There is an open-plan kitchen and reception room, two bedrooms and a family bathroom.

Bromyard House is a prestigious, well managed development situated opposite Virgin Active Health Club and Tesco Metro. With East Acton station (Central Line), Acton Central rail station and multiple bus routes to Shepherds Bush, Chiswick and Ealing close by this property makes a convenient option for the discerning buyer.



- Two double bedroom apartment
- Open-plan living room
- First floor
- Communal gardens
- Private gated development
- 24 Hour Concierge
- Nearby Westfield Shopping Centre
- Nearest tube East Acton
- South facing apartment

Bromyard House, Flat 578, Bromyard Avenue, London

Approximate Area = 740 sq ft / 69 sq m

For identification only - Not to scale

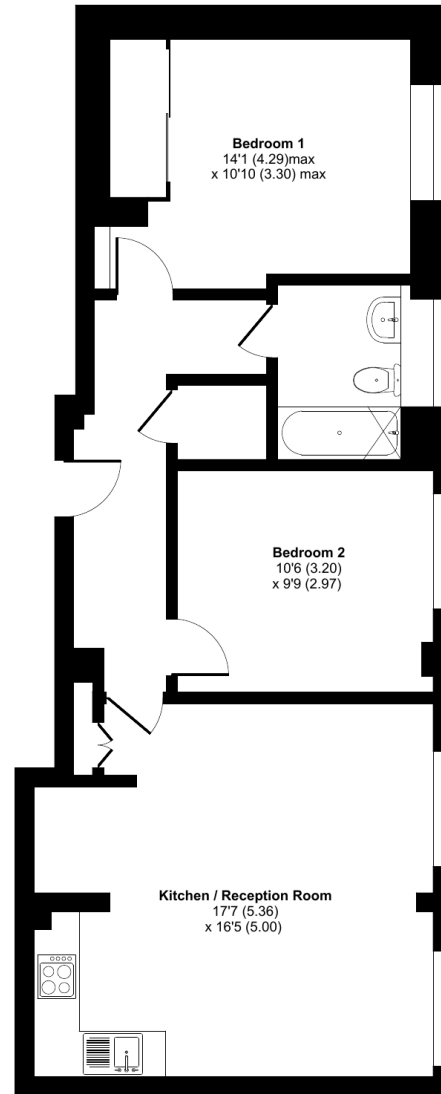

FIRST FLOOR



Floor plan produced in accordance with RICS Property Measurement Standards incorporating International Property Measurement Standards (IPMS2 Residential). © nchecon 2022. Produced for Cow & Co Properties Ltd. REF: 854858

Tel: 0208 065 0010
Email: thehub@cowandco-london.com
Web: cowandco-london.com

Agents note: All measurements are approximate and whilst every attempt has been made to ensure accuracy they are for general guidance only and must not be relied on. The fixture and fittings referred to have not been tested and therefore no guarantee can be given that they are in working order. Internal photographs are reproduced for general information and it must not be inferred that any item shown is included with the property.

Cow & Co

LONDON