

Moorland Street

Axbridge, BS26 2FH

COOPER
AND
TANNER



£309,950 Freehold

Offered to the market with no onward chain is this well proportioned three bedroom modern property close to Axbridge Square. The property benefits from two allocated parking bays, an enclosed rear garden and ample living space.

Moorland Street

Axbridge

BS26 2FH

 3  1  2 EPC TBC

£309,950 Freehold

DESCRIPTION

Offered to the market with no onward chain is this well proportioned three bedroom property close to Axbridge Square. The property benefits from two allocated parking bays, an enclosed rear garden and ample living space.

As you enter into the spacious entrance hall there is access into all of the downstairs rooms and the first floor with a handy hallway cupboard. The kitchen is fitted with an array of wall and base units, integral dishwasher, space for other white appliances and houses a freestanding range cooker fitted around with granite worktops. The kitchen is a great size and would fit a dining table. There is a utility room/cloakroom where there is a sink, low level WC. The living room is a good sized rear aspect room with window overlooking the garden and a door opening out. The kitchen, dining area and hallway are all fitted with solid oak flooring throughout.

The first floor houses the family bathroom which benefits from a panelled bath, low level WC and vanity sink. The master bedroom is a front aspect bedroom with an en suite shower room with WC, shower cubicle and vanity sink. There are two further bedrooms, one double and the other single which are both rear aspect with a handy storage cupboard conveniently placed in the corner of the larger room.

OUTSIDE

The rear garden is predominantly laid to lawn with a patio pathway with a stone chippings area. The garden is enclosed by fencing with a gate at the rear. The property also benefits from secure resident only parking accessed through electric gates, a shared secure lock up which is ideal for storing garden equipment or a bike - there is also a shared bin and recycling area.

LOCATION

An important wool-producer in the Middle Ages, Axbridge has always been at the centre of things. Indeed, in earlier times, it was a river port. This was reflected in its early charters allowing it to hold markets, fairs and become a royal borough. It even had its own mint, with coins showing the town's symbol - the Lamb and Flag. The layout of the town has changed little over the centuries, a medieval town expanding on a fortified Saxon burgh and even today visitors can wander the winding streets that remain at the heart of this charming place and soak up hundreds of years of the histories of ordinary lives. Axbridge is well located for commuting to local business centres of Wells, Cheddar, Weston-super-Mare and Bristol via the nearby M5 and A38. Bristol international Airport is 15 minutes drive away.

TENURE

Freehold

SERVICES

All mains services

COUNCIL TAX BAND

C

EPC RATING

C

VIEWINGS

Strictly by appointment only - Please call Cooper and Tanner

DIRECTIONS

From The Square in Axbridge, proceed along the left hand side of the chemist shop into Moorland Street. Continue along the road and the property is located on the left hand side just past the





GROUND FLOOR
439 sq.ft. (40.8 sq.m.) approx.

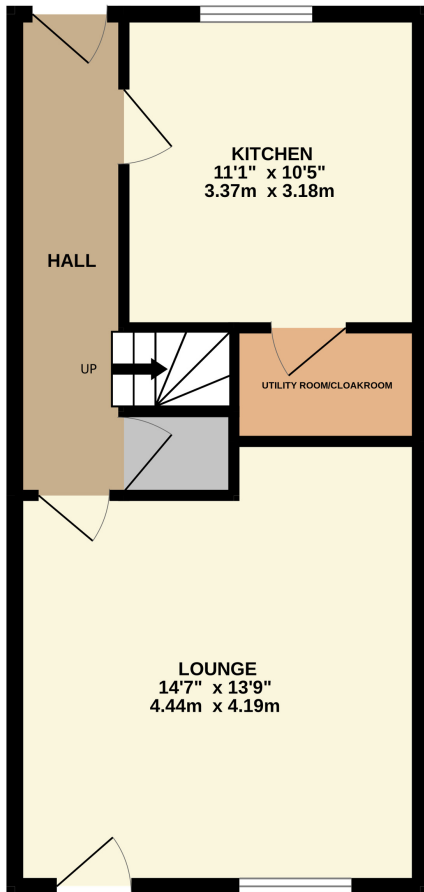

1ST FLOOR
0 sq.ft. (0.0 sq.m.) approx.

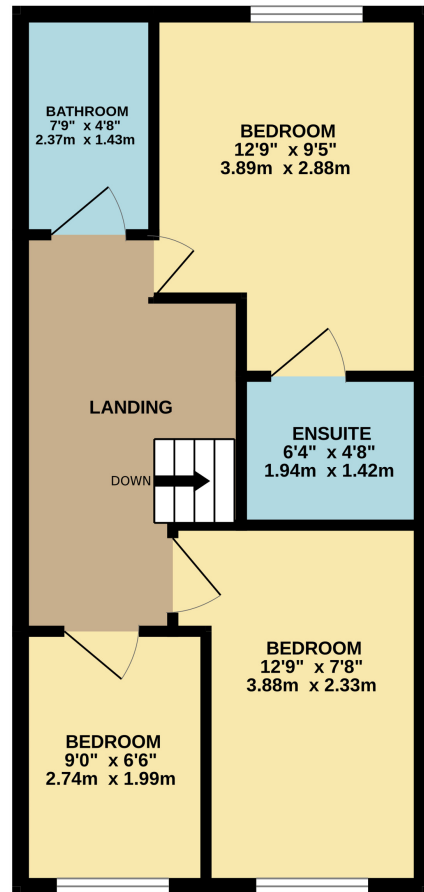

TOTAL FLOOR AREA : 439 sq.ft. (40.8 sq.m.) approx.

Whilst every attempt has been made to ensure the accuracy of the floorplan contained here, measurements of doors, windows, rooms and any other items are approximate and no responsibility is taken for any error, omission or mis-statement. This plan is for illustrative purposes only and should be used as such by any prospective purchaser. The services, systems and appliances shown have not been tested and no guarantee as to their operability or efficiency can be given.

Made with Metropix ©2024

CHEDDAR OFFICE

Telephone 01934 740055

Unit 2, Union Street, Cheddar, Somerset BS27 3NA

cheddar@cooperandtanner.co.uk

**COOPER
AND
TANNER**

Important Notice: These particulars are set out as a general outline only for the guidance of intended purchasers and do not constitute, nor constitute part of, an offer or contract. All descriptions, dimensions, reference to condition and necessary permissions for use and occupation, warranties and other details are given without responsibility and any intending purchasers should not rely on the m as statements or representations of fact but must satisfy themselves by inspection or otherwise as to the correctness of each of them.

