



Four Bedroom Detached House
Napier Road, Gillingham, Kent, ME7 4HL

Guide Price £350,000
Freehold

Napier Road, Gillingham, Kent, ME7 4HL

Guide Price £350,000

Freehold

Description

Guide Price £350,000 - £375,000

Enjoying a prominent position in this popular Gillingham road is this four bedroom, Victorian style detached family home. The property offers two reception rooms, a modern kitchen, ground floor bathroom, utility area, three good size bedrooms and a stylish shower room on the first floor and the fourth bedroom/study is in the cellar. There's also parking available at the front benefitting from an electric vehicle charging point and a fantastic rear garden leading to a handy workshop. Presented beautifully and ready to move straight into, the property is well located for the railway station, Gillingham Park, Medway Maritime Hospital, and the Medway Tunnel for links to London. Viewing is a must, so call the Greyfox Sales Team in Rainham to book your viewing now.

Key Features

- Victorian Style Detached Family Home
- Ground Floor Bathroom & First Shower Room
- Two Reception Rooms
- Four Bedrooms
- Off Road Parking & Electric Vehicle Charging Point
- Fantastic Garden measuring approximately 95' x 19'7 ft
- Popular Central Gillingham Location
- Great Transport Links

Local Area

Gillingham is located within the Medway towns and offers railway links to central London and Ebbsfleet International and road connections to the A2/M2, M25 and M20. In addition to its town centre Gillingham offers a host of amenities including ice skating, country parks, an outdoor pool, a golf course, Medway Park Sports Centre and more.



GROUND FLOOR
506 SQ.FT. (46.7 SQ.M.) approx.

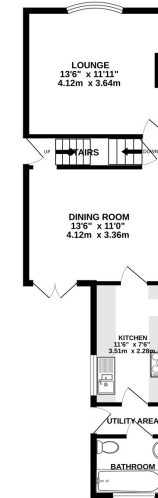

1ST FLOOR
507 SQ.FT. (47.1 SQ.M.) approx.

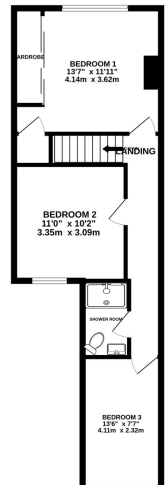

TOTAL FLOOR AREA : 1197 sq.ft. (111.2 sq.m.) approx.

Whilst every attempt has been made to ensure the accuracy of the floorplan contained here, measurements of doors, windows, rooms and any other items are approximate and no responsibility is taken for any error, omission or mis-statement. This plan is for illustrative purposes only and should be used as such by any prospective purchaser. The services, systems and appliances shown have not been tested and no guarantee as to their operability or efficiency can be given.
Made with Metropix ©2024



Property Location

Napier Road, Gillingham, Kent, ME7 4HL

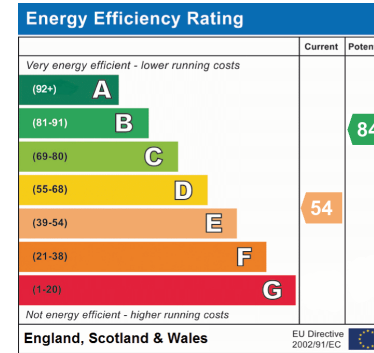
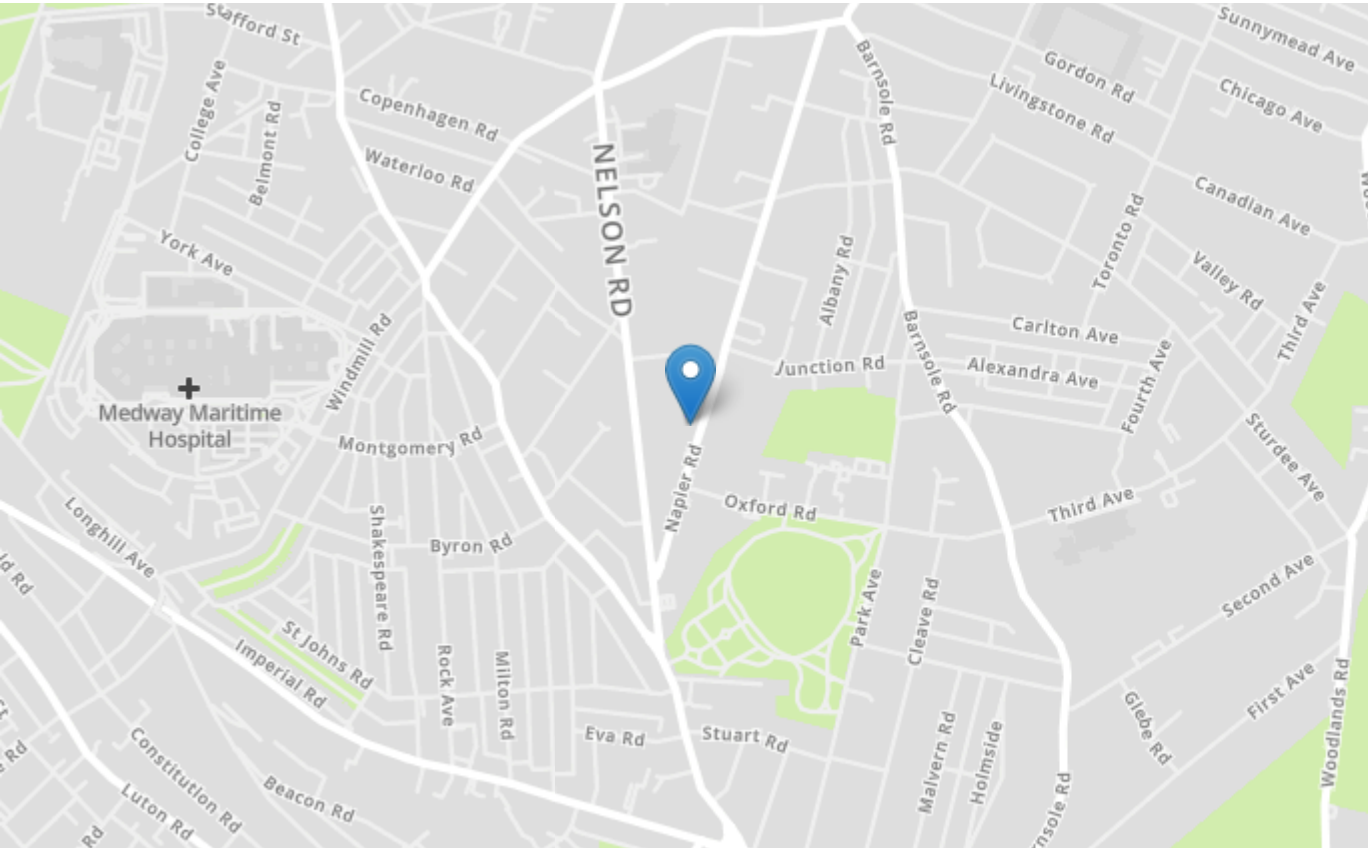

Tenure	Freehold
Lease Term	N/A
Ground Rent	N/A
Service Charge	N/A
Local Authority	Medway
Council Tax	Band C

Greyfox Walderslade

Unit 2, Thetford House
Walderslade Village Centre
Walderslade Road
Chatham
Kent
ME5 9LR
Tel: 01634 672227 Email:
walderslade@greyfox.co.uk

Greyfox Rainham

67C High Street
Rainham
Kent
ME8 7HS
Tel: 01634 377737 Email:
rainham@greyfox.co.uk

Agent Notes

These particulars are prepared as a general guide to a broad description of the property and should not be relied upon as a statement or representation of fact and do not constitute part of an offer or contract. The seller does not make or give nor do our employees or Greyfox have authority to make or give any representation or warranty to the property. We have not carried out a structural survey and the services, appliances and specific fittings have not been tested. All photographs, measurements, floorplans and distances referred to are given as a guide only and should not be relied upon for the purchase of carpets or any other fixtures or fittings. Lease details, service charges and ground rent (where applicable) and council tax are given as a guide only and should be checked and confirmed by you on inspection and your solicitor prior to exchange of contracts. If there are any points of particular importance to you we will be pleased to check the information for you and to confirm that the property remains available. This is particularly important should you be travelling some distance to view and where statements have been made by us to the effect that the information has not been verified. The copyright of all details, photographs and floorplans remain exclusive to Greyfox. For details of our privacy policy and referral fee arrangements with any of our selected partner companies please visit <https://www.greyfox.co.uk/legal/privacy> and <https://www.greyfox.co.uk/referral-fees>.