



Asiya House, 9a Dollis Drive, Farnham, Surrey. GU9 9QD.
Guide Price £450,000

- End of terrace town house
- 2 Luxury bath/shower rooms
- Integrated appliances
- Small, enclosed garden
- Brand New
- 2/3 bedrooms
- Kitchen/breakfast/living room
- Study/bedroom 3
- Private driveways for 2 cars
- Building warranty

Energy Efficiency Rating		Current	Potential
Very energy efficient - lower running costs			
(92-100)	A		95
(81-91)	B	84	
(69-80)	C		
(55-68)	D		
(39-54)	E		
(21-38)	F		
(1-20)	G		
Not energy efficient - higher running costs			
England, Scotland & Wales			EU Directive 2002/91/EC

Description

Set towards the end of a cul de sac is this deceptively spacious BRAND NEW 3-storey town house style property with flexible accommodation. Comprising 2 double bedrooms, 2 luxury bath/shower rooms, well appointed kitchen/dining/living room with integrated appliances, study/bedroom 3 and cloak/wc. Externally there is a private garden and parking is provided on 2 drives for 1 car each and an electric car charger.

New Building, Barns, Industrial Conversions Warranty - CMLC

Located on a popular residential road within easy distance of Farnham's mainline station, which offers a fast regular service through to Waterloo, and the town's elegant Georgian centre, famed for it's many exclusive shops, pavement cafe's and flower filled courtyards.

Directions

SAT NAV - GU9 9QD

Local Authority

Waverley

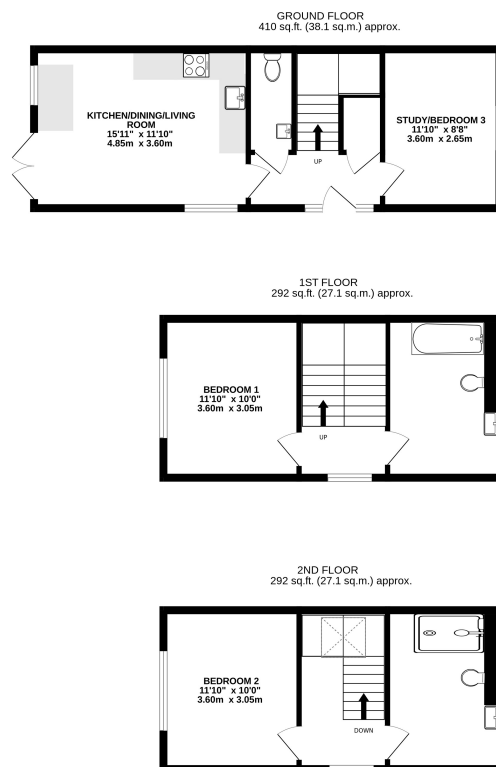

TOTAL FLOOR AREA: 994 sq.ft. (92.3 sq.m.) approx.

Whilst every attempt has been made to ensure the accuracy of the floorplan contained herein, measurements of doors, windows, rooms and any other items are approximate and no responsibility is taken for any error, omission or mis-statement. This plan is for illustrative purposes only and should be used as such by any prospective purchaser. The services, systems and appliances shown have not been tested and no guarantee as to their operability or efficiency can be given.
Made with Metropix 03/23

For clarification we wish to inform prospective purchasers that we have prepared these sales particulars as a general guide. We have not carried out a detailed survey or tested the services, appliances and specific fittings.