





- Well Presented Home
- GFCH & PVCu DG
- Two Reception Rooms
- Modern Kitchen & Utility Room
- Two Double Bedrooms
- Modern Bathroom
- Rear Garden & On Street Parking

Description

A well modernised and well presented two bedroom end-terrace home with gas central heating and PVCu double glazing. Lounge, separate dining room, modern fitted kitchen utility room, first floor landing, two double bedrooms and modern bathroom. Externally there are front and rear gardens and unrestricted parking is available on street. Immediately available, restrictions apply.



Location
Tenure

EPC Rating: E

Important Notes



Ground Floor

Approx. 38.3 sq. metres (412.2 sq. feet)

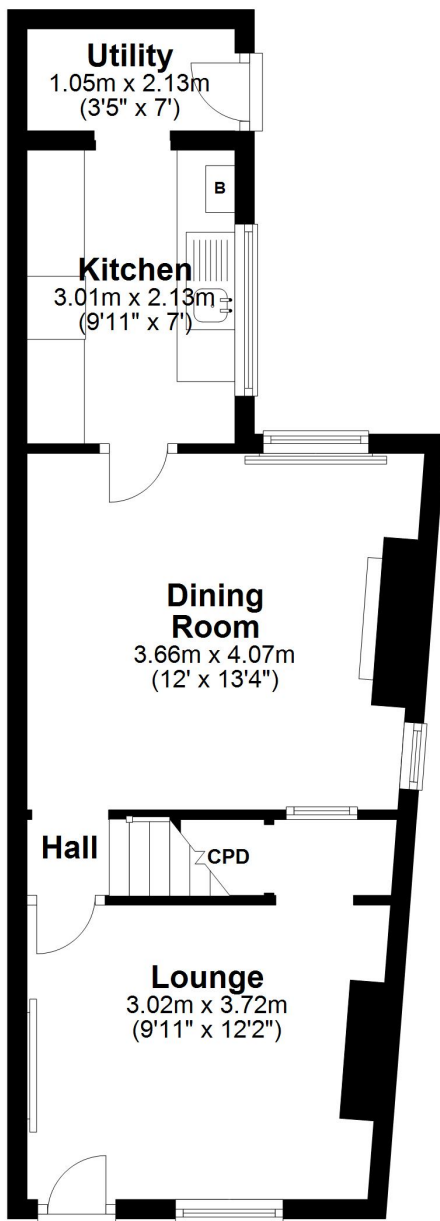

First Floor

Approx. 35.6 sq. metres (383.6 sq. feet)

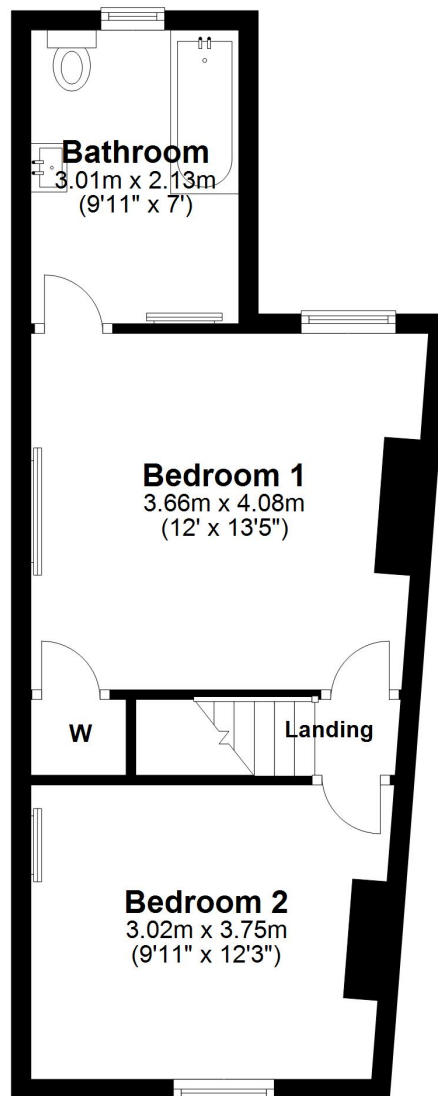

Total area: approx. 73.9 sq. metres (795.7 sq. feet)

