



- 1627sqft Detached House
- Four Bedrooms
- 130ft Rear Garden
- Three Reception Rooms
- Kitchen/Breakfast Room
- Utility/Shower Room
- En - Suite, Family Bathroom & Downstairs WC
- 27ft Garage And Parking For Several Cars

9 Tey Road, Earls Colne, Colchester, Essex. CO6 2LG.

Discover the epitome of spacious and comfortable living in this exquisite four-bedroom detached house located on Tey Road in the picturesque village of Earls Colne. Boasting an impressive 1600 square feet of accommodation, this property is a true gem, offering a perfect blend of indoor and outdoor spaces for a quality lifestyle.



Property Details.

Room Measurements

Porch

With access to;

Entrance Hall



Providing Access to;

Living Room



14' 6" x 11' 8" (4.42m x 3.56m)

WC

Utility/Shower Room



8' 5" x 6' 2" (2.57m x 1.88m)

Kitchen/Breakfast Room



18' 6" x 9' 10" (5.64m x 3.00m)

Sitting Room



Property Details.

12' 0" x 11' 0" (3.66m x 3.35m)

Snug

9' 10" x 7' 10" (3.00m x 2.39m)

Conservatory



19' 2" x 10' 5" (5.84m x 3.17m)

Landing

With access to;

Bedroom One



13' 0" x 11' 0" (3.96m x 3.35m)

En-Suite

8' 6" x 4' 4" (2.59m x 1.32m)

Bedroom Two



11' 8" x 9' 7" (3.56m x 2.92m)

Bedroom Three



11' 3" x 7' 9" (3.43m x 2.36m)

Bedroom Four

12' 0" x 8' 3" (3.66m x 2.51m)

Bathroom

9' 8" x 6' 5" (2.95m x 1.96m)

Property Details.

Floorplans

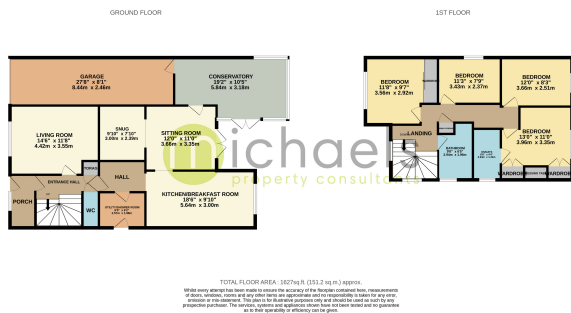

Location

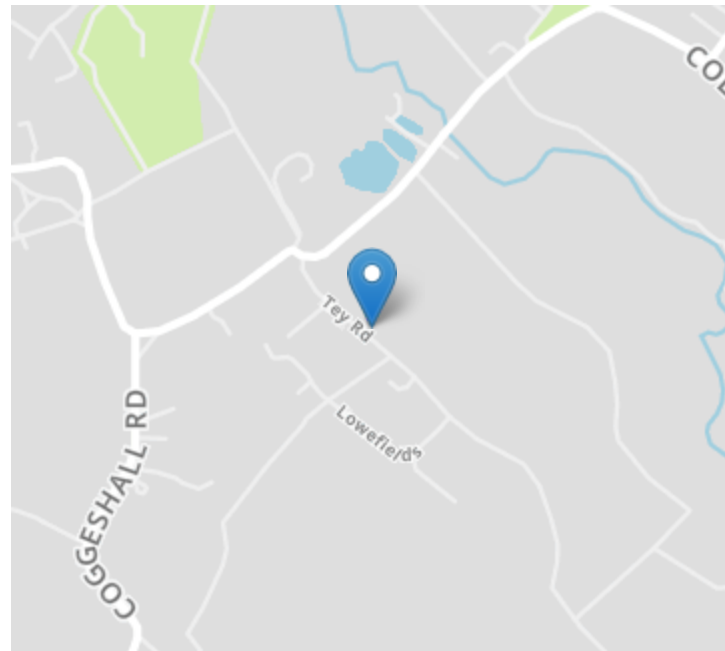

Energy Ratings

We have not carried out a structural survey and the services, appliances and specific fittings have not been tested. All photographs, measurements, floor plans and distances referred to are given as a guide only and should not be relied upon for the purchase of carpets or any other fixtures or fittings. Gardens, roof terraces, balconies and communal gardens as well as tenure and lease details cannot have their accuracy guaranteed for intending purchasers. Lease details, service ground rent (where applicable) are given as a guide only and should be checked and confirmed by your solicitor prior to exchange of contracts.