

Land adjoining Wandales Lane, Casterton, Carnforth LA6 2SE



Kirkby Lonsdale – 2 miles

A65 – 2 miles

Situation Wandales Lane is approached from the A65 mid way between Cowan Bridge and Kirkby Lonsdale on the long straight road signposted to Casterton, Barbon and Dent. Two miles up Wandales Lane the gate access to the land is on the right where a saleboard should be in place.

Description The land is freehold with vacant possession and extends to 7.83 acres or thereabouts. The gate access from the road leads over a culvert to a stream providing a natural water supply for animal needs never known to have dried up. The remaining area of the field is productive meadowland with part stone wall and part hedge and fence boundaries.

Informal Tender All offers should be made on the official tender form provided and submitted to the selling agents before midday Wednesday 7th August 2024. The successful tender will be expected to complete the purchase mid September 2024.

Guide Price £100,000

Viewing Anytime in daylight hours

Selling Agents Richard Turner & Son, Old Sawley Grange, Sawley, Clitheroe BB7 4LH. Tel. 01200 441351 or email to sawley@rturmer.co.uk

Please Note: In order for selling agents to comply with HM Revenue and Customs (HMRC) Anti-Money Laundering regulations we are now obliged to ask all purchasers to complete an Identification Verification Questionnaire form which will include provision of prescribed information (identity documentation etc.) and a search via Experian to verify information provided however please note the Experian search will NOT involve a credit search.

MISREPRESENTATION ACT 1967:

Richard Turner & Son, for themselves and for the vendors or lessors of these properties whose agents they are, give notice that these particulars do not constitute any part of an offer or a contract. All statements contained in these particulars as to these properties are made without responsibility on the part of Richard Turner & Son or the vendors or lessors, none of the statements contained in these particulars as to these properties are to be relied on as statements or representations of fact and any intending purchasers or lessees must satisfy themselves by inspection or otherwise as to the correctness of each of the statements contained in these particulars. The vendor or lessors do not make or give and neither Richard Turner & Son nor any person in their employment, has any authority to make or give any representation of warranty whatever in relation to these properties.



HM Land Registry
Current title plan

Title number **CU258301**
Ordnance Survey map reference **SD6379NW**
Scale **1:2500**
Administrative area **Westmorland and Furness**



© Crown Copyright. Produced by HM Land Registry. Reproduction in whole or in part is prohibited without the prior written permission of Ordnance Survey. Licence Number 10002831

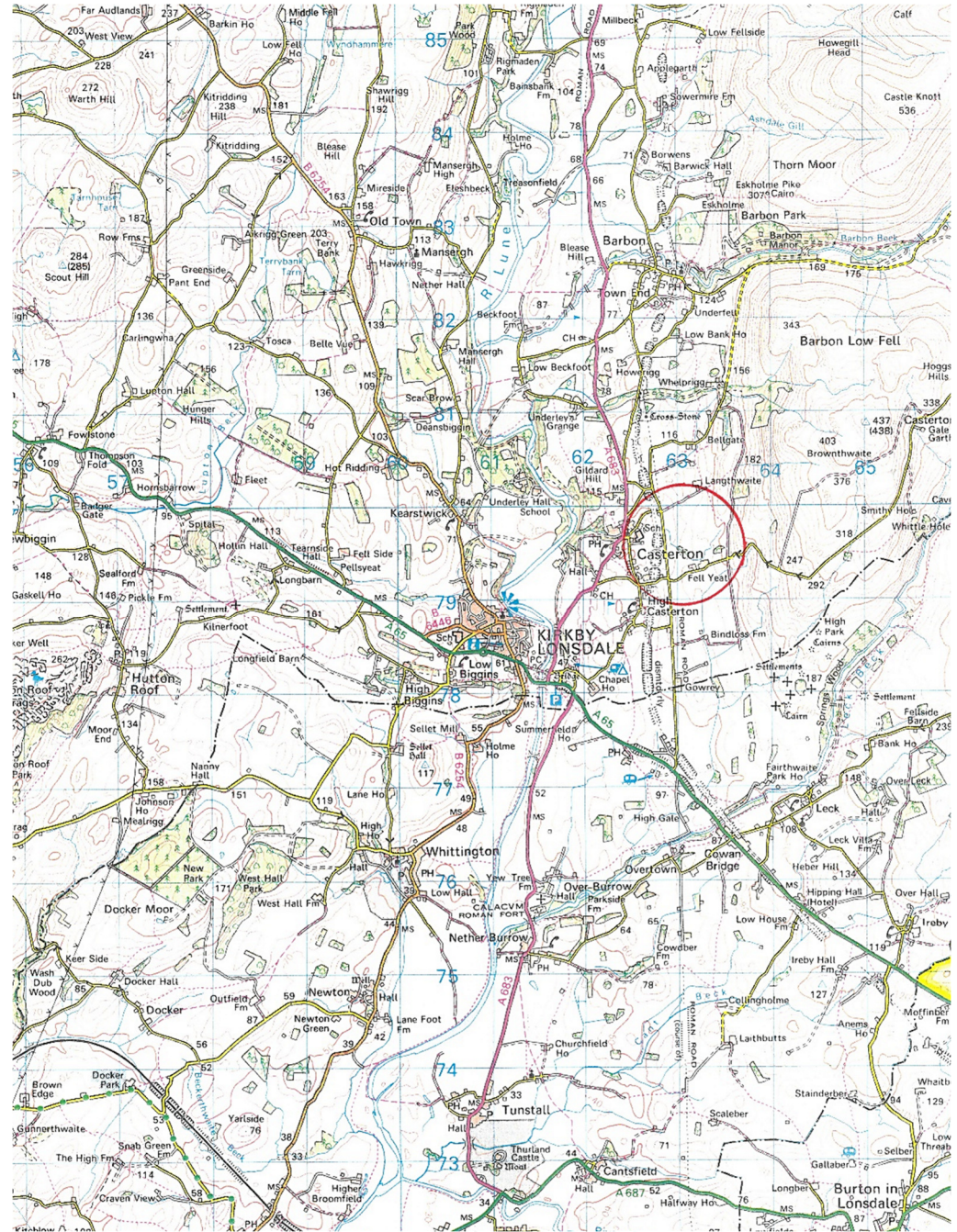
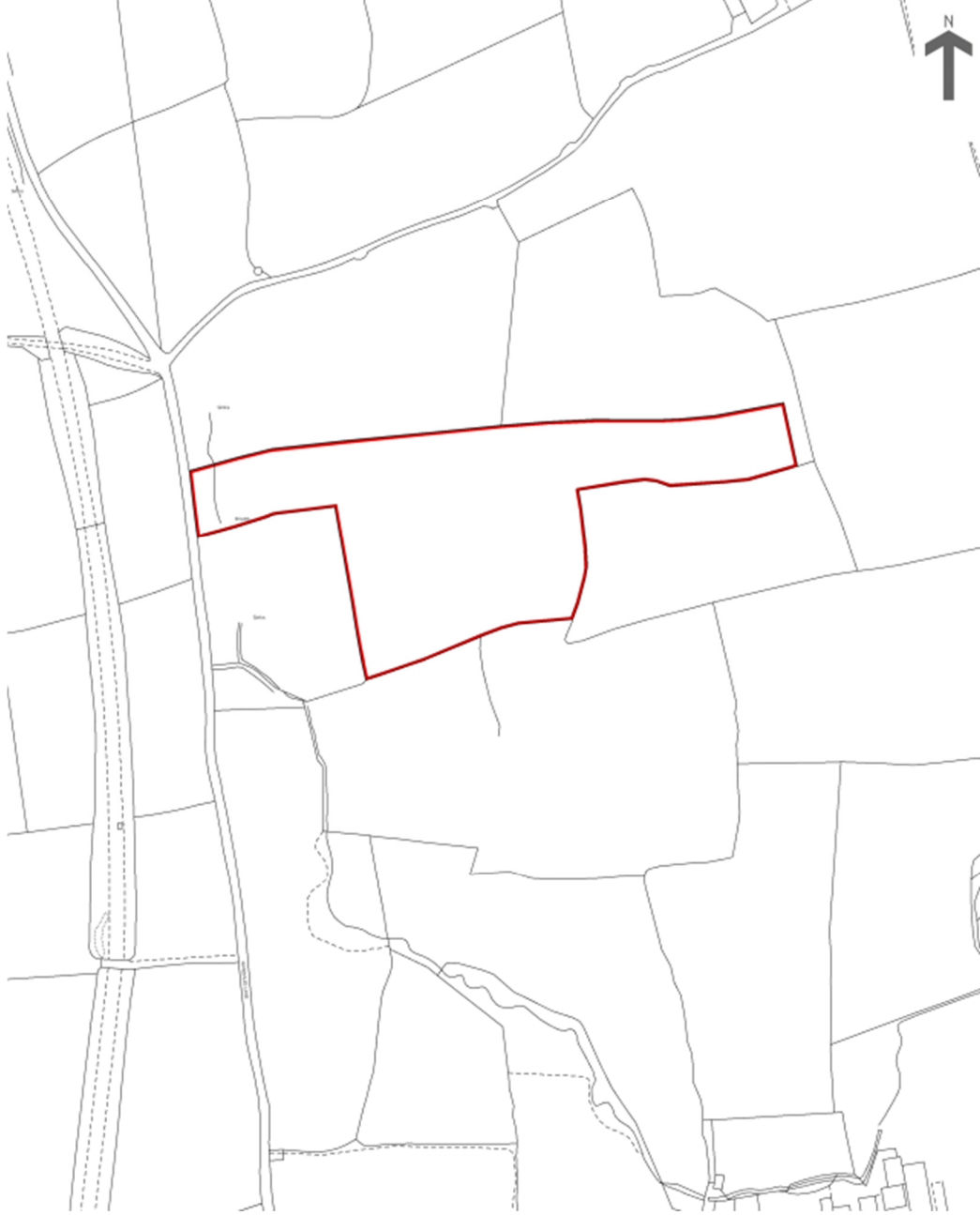

Richard Turner & Son, Old Sawley Grange, Gisburn Road, Sawley, Clitheroe BB7 4LH

