



Three Bedroom Terraced House
Mierscourt Road, Rainham, Gillingham, Kent, ME8 8JW

Offers in Region of £325,000
Freehold

Mierscourt Road, Rainham, Gillingham, Kent, ME8 8JW

Offers in Region of £325,000

Freehold

Description

Situated in a popular and convenient location within Rainham, this modern three-bedroom mid-terrace home offers well-presented and versatile accommodation ideal for families, first-time buyers, or investors alike. The property welcomes you via an entrance porch leading into a bright and comfortable living room. To the rear, the kitchen/diner provides an excellent space for everyday living and entertaining, flowing seamlessly into a conservatory that overlooks the garden and adds valuable additional living space. Upstairs, the home boasts two generous double bedrooms, one of which benefits from fitted wardrobes, alongside a large single bedroom. A well-appointed family bathroom completes the first-floor accommodation. Externally, the property features a low-maintenance rear garden with a combination of lawn and patio areas, perfect for outdoor relaxation. Further benefits include a garage en bloc with an additional parking space located in front. This attractive home combines modern living with a sought-after Rainham location and early viewing is highly recommended. Contact the Rainham Sales team at Greyfox to arrange a viewing! EPC awaited.

Key Features

- Chain Free!
- Modern Mid-Terrace House
- 3 Large Bedrooms
- Popular Rainham Location
- Kitchen/Diner
- Conservatory
- En-Bloc Garage & Parking Space
- Patio/Lawn Rear Garden

Local Area

Rainham in the Medway towns is located descending towards the banks of the river Medway, approximately 39 miles from London. The ancient Watling Street main road (A2) runs through the town with the M2 motorway on the southern edge with good links to the M25/M20. There are a good number of shops and facilities within the town, a mainline station and a selection of local schools including Rainham Mark Grammar School.

GROUND FLOOR
514 sq.ft. (47.7 sq.m.) approx.

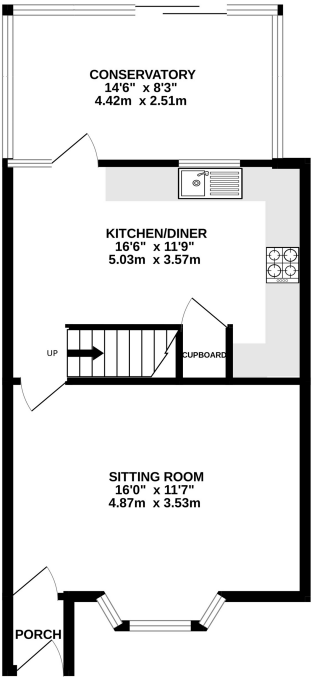

1ST FLOOR
372 sq.ft. (34.6 sq.m.) approx.

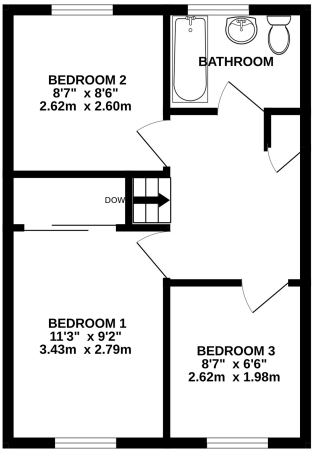

TOTAL FLOOR AREA: 886 sq.ft. (82.3 sq.m.) approx.
Whilst every attempt has been made to ensure the accuracy of the floorplan contained here, measurements of doors, windows, rooms and any other items are approximate and no responsibility is taken for any error, omission or mis-statement. This plan is for illustrative purposes only and should be used as such by any prospective purchaser. The services, systems and appliances shown have not been tested and no guarantee as to their operability or efficiency can be given.
Made with Mettix 12/2016



Property Location

Mierscourt Road, Rainham, Gillingham, Kent, ME8 8JW

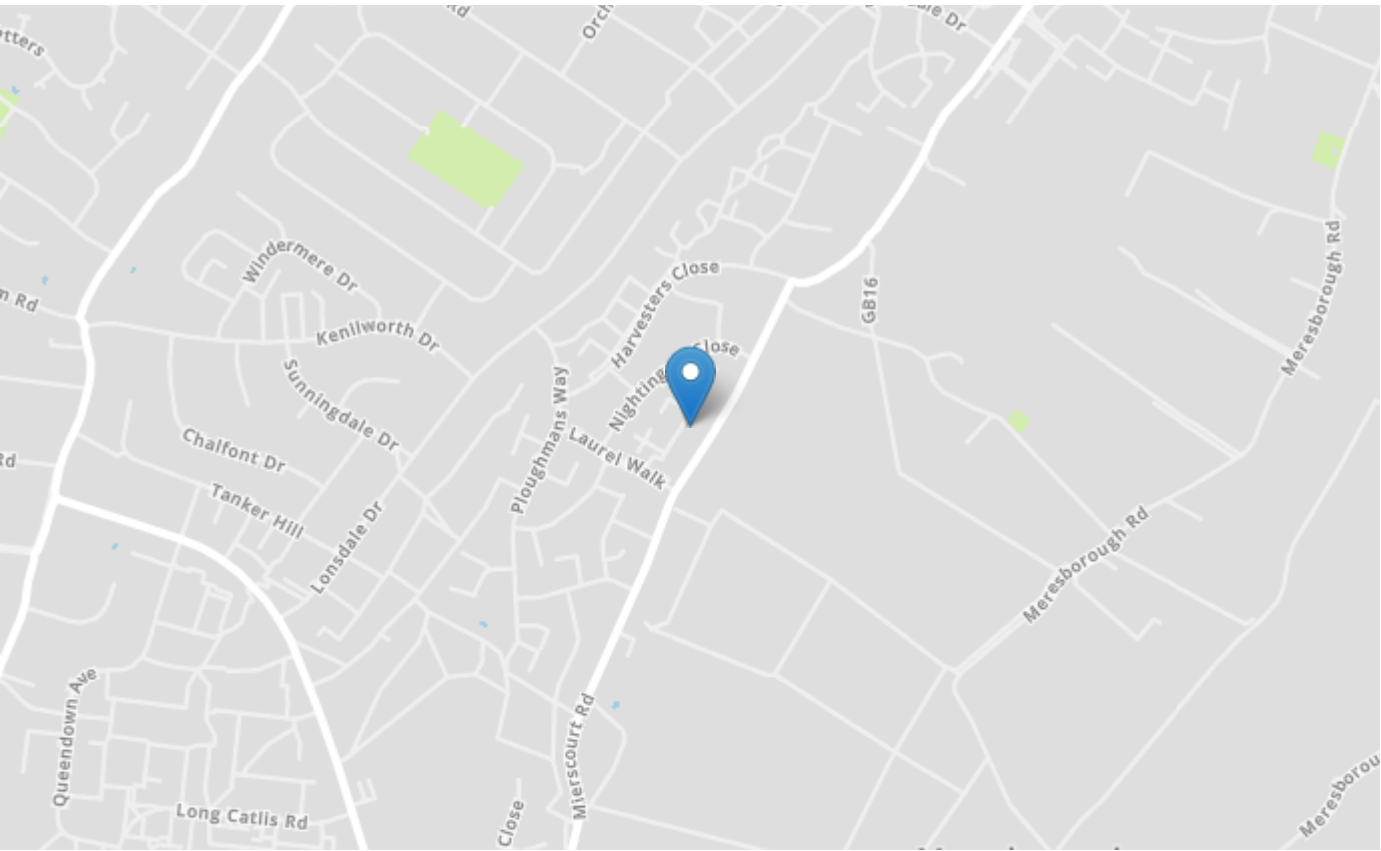

Tenure	Freehold
Lease Term	n/a
Ground Rent	n/a
Service Charge	n/a
Local Authority	Medway
Council Tax	Band C

Greyfox Walderslade
 Unit 2, Thetford House
 Walderslade Village Centre
 Walderslade Road
 Chatham
 Kent
 ME5 9LR
 Tel: 01634 672227 Email:
 walderslade@greyfox.co.uk

Greyfox Rainham
 67C High Street
 Rainham
 Kent
 ME8 7HS
 Tel: 01634 377737 Email:
 rainham@greyfox.co.uk

Agent Notes
 These particulars are prepared as a general guide to a broad description of the property and should not be relied upon as a statement or representation of fact and do not constitute part of an offer or contract. The seller does not make or give nor do our employees or Greyfox have authority to make or give any representation or warranty to the property. We have not carried out a structural survey and the services, appliances and specific fittings have not been tested. All photographs, measurements, floorplans and distances referred to are given as a guide only and should not be relied upon for the purchase of carpets or any other fixtures or fittings. Lease details, service charges and ground rent (where applicable) and council tax are given as a guide only and should be checked and confirmed by you on inspection and your solicitor prior to exchange of contracts. If there are any points of particular importance to you we will be pleased to check the information for you and to confirm that the property remains available. This is particularly important should you be travelling some distance to view and where statements have been made by us to the effect that the information has not been verified. The copyright of all details, photographs and floorplans remain exclusive to Greyfox. For details of our privacy policy and referral fee arrangements with any of our selected partner companies please visit <https://www.greyfox.co.uk/legal/privacy> and <https://www.greyfox.co.uk/referral-fees>.