



HENSTOCK

PROPERTY SERVICES



Approx Gross Internal Area
98 sq m / 1059 sq ft

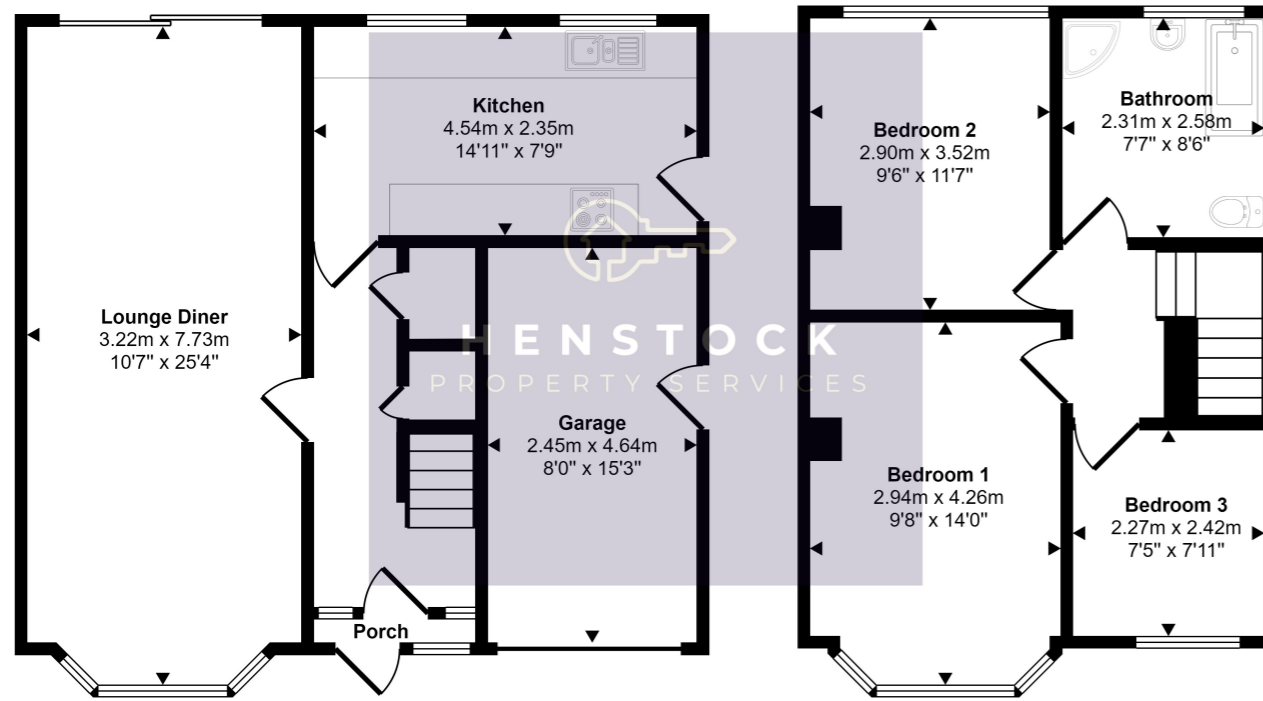

Ground Floor
Approx 58 sq m / 624 sq ft

First Floor
Approx 40 sq m / 434 sq ft

This floorplan is only for illustrative purposes and is not to scale. Measurements of rooms, doors, windows, and any items are approximate and no responsibility is taken for any error, omission or mis-statement. Icons of items such as bathroom suites are representations only and may not look like the real items. Made with Made Snappy 360.

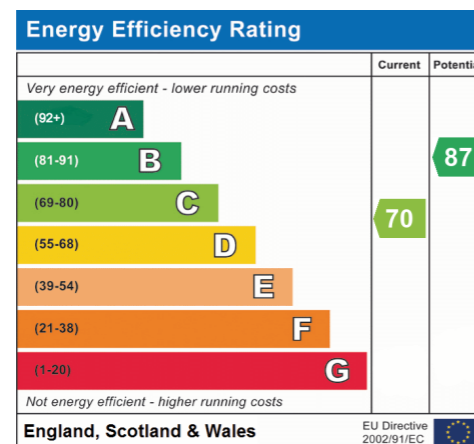

74 Broomfield Crescent, Middleton, Manchester, Lancashire M24 4FW

- 3 BEDROOMED SEMI DETACHED
- FREEHOLD
- COUNCIL TAX BAND B
- DOUBLE GLAZED WINDOWS THROUGHOUT
- GAS CENTRAL HEATING
- SINGLE GARAGE
- NO CHAIN

Offers in Excess of £240,000



PROPERTY DESCRIPTION

Henstock Property Services are pleased to market this 3 bedroomed semi detached family home set in this popular residential area. The living accommodation briefly comprises; entrance porch into hallway, through lounge with patio doors to rear garden, fitted kitchen, 3 bedrooms and a large family bathroom. The property also has the benefit of gas central heating, double glazed windows, driveway to front leading to attached garage and a good sized lawned garden to rear. Ideally situated in this extremely popular spot within easy reach of schools, shops/supermarkets, leisure/fitness facilities, good public transport services and a short distance from the M60 & M62 motorway link

GROUND FLOOR

Entrance

Porch leading into hallway.

Through Lounge

3.22m x 7.73m (10' 7" x 25' 4") bay window to front and patio doors to rear garden.

Kitchen

4.54m x 2.35m (14' 11" x 7' 9") views to rear, door to side leading out to rear garden.

Attached Garage

2.45m x 4.64m (8' 0" x 15' 3") up and over door to front, door to side.

FIRST FLOOR

Bedroom 1

2.94m x 4.26m (9' 8" x 14' 0") bay window to front.

Bedroom 2

2.9m x 3.52m (9' 6" x 11' 7") views to rear.

Bedroom 3

2.27m x 2.42m (7' 5" x 7' 11") views to front.

Bathroom

2.31m x 2.58m (7' 7" x 8' 6")

Exterior

Driveway to front leading to attached garage. Lawned rear garden.

