



**Kettlewell Way
Stockton-on-Tees
TS21 1FZ**

Offers in Excess of £232,000

bettermove

Kettlewell Way

A SPACIOUS house in Stockton-on-Tees, perfect for FIRST TIME BUYERS and CHAIN FREE. Call to enquire!

Bettermove are proud to present this 3 bedroom semi-detached in Stockton-on-Tees available with no forward chain, welcoming an array of buyers.

The property benefits from double glazing, gas central heating throughout and has a private garage and driveway for parking.

The council tax band is D.

The interior of this beautifully presented property comprises a spacious living room, dining room and fitted kitchen on the ground floor. The first floor consists of 3 bedrooms and the family bathroom. The exterior boasts a private rear garden, perfect for enjoying the summer months.

Located in the popular town of Stockton-on-Tees, the property is close to a range of amenities, including shops, supermarkets, restaurants and pubs. Excellent transport connections can be found from the A66 and public transport in the area.

This exciting opportunity should not be missed! All enquiries can be made through Bettermove on 0330 004 0050.



Approx Gross Internal Area
84 sq m / 908 sq ft

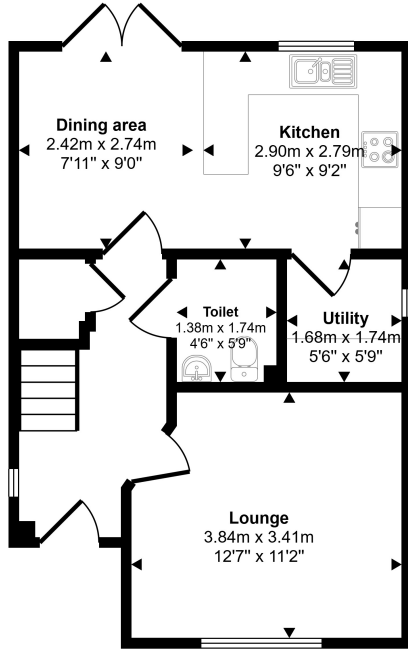

Ground Floor

Approx 42 sq m / 454 sq ft

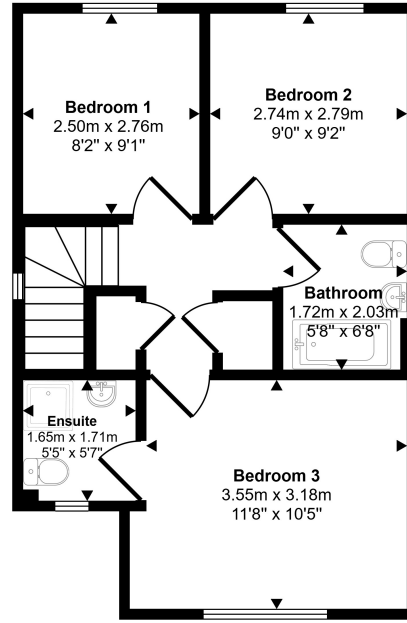

First Floor

Approx 42 sq m / 454 sq ft

Whilst every attempt has been made to ensure the accuracy of the floor plan contained here, measurements of doors, windows, rooms and any other items are approximate and no responsibility is taken for any error, omission, or mis-statement. The measurements should not be relied upon for valuation, transaction and/or funding purposes. This plan is for illustrative purposes only and should be used as such by any prospective purchaser or tenant.

Energy Efficiency Rating		Current	Potential
<i>Very energy efficient - lower running costs</i>			
(92+)	A		95
(81-91)	B	84	
(69-80)	C		
(55-68)	D		
(39-54)	E		
(21-38)	F		
(1-20)	G		
<i>Not energy efficient - higher running costs</i>			
England, Scotland & Wales		EU Directive 2002/91/EC	



20-22 Bridge End, Leeds, LS1 4DJ
t: 0330 004 0050 e: hello@bettermove.co.uk
www.bettermove.co.uk