



BRITISH  
PROPERTY  
AWARDS

2017 - 2019  
★★★★★

GOLD WINNER

ESTATE AGENT  
IN GL17-20

**Northway**

**01684 293246**

**Engall  
Castle**  
.com



## 31 Grange Court, Northway, Tewkesbury, GL20 8TE

This is a delightful freehold property which offers an excellent opportunity for downsizing, first time buyers and the investment buyer.

The property is modern and well-presented throughout and with No Chain is ready to move straight into.

An entrance porch leads into the property and through to an open plan living space with a modern kitchen at the rear. The kitchen is fitted with a range of wall and base units with a gas cooker and fridge.

On the first floor there is a double bedroom and bathroom. The bathroom has a panel bath with shower over, pedestal wash basin and low level wc.

Outside the garden is laid predominantly to lawn with patio area and garden shed. At the front the garden is paved providing off road parking.



The property benefits from gas central heating and upvc double glazed windows and doors.

Northway has the benefit of with its own primary school, small parade of convenience shops, community centre and park all within easy walking distance of the property.

Just 1.5 miles to the East of Tewkesbury it also benefits from the town's wealth of health, leisure, education and shopping amenities and with easy access to the motorway and rail links it is an excellent commuter base.

## Ground Floor

Entrance Porch  
Living Room 11'11"x11'11"  
Kitchen 11'11"x6'7"

## First Floor

Bedroom 1 12'10"x8'9"  
Bathroom 5'9"x5'6"

## Outside

Garden  
Driveway Parking

**Tewkesbury Borough Council Tax Band A**

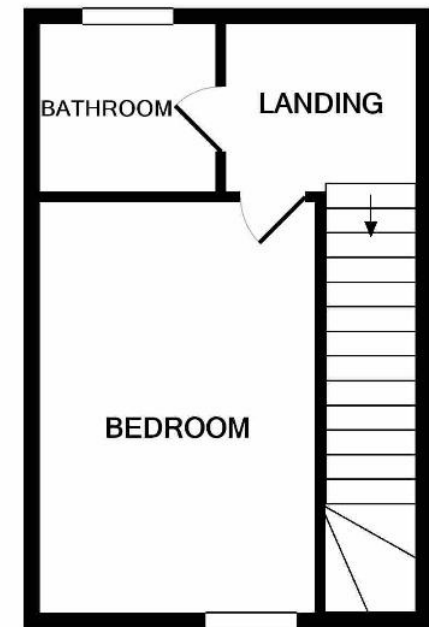
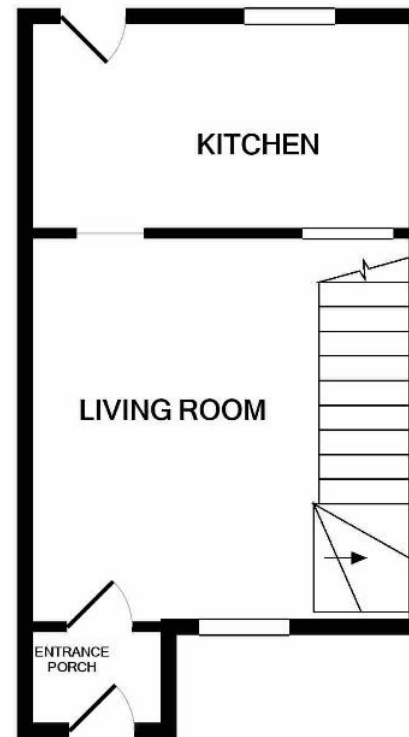

1ST FLOOR

GROUND FLOOR

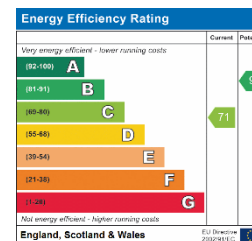

This floorplan is provided for guidance only as an approximate layout of the property and should not be relied upon as a statement of fact.



**Guide Price £160,000 Freehold**

Viewing strictly by arrangement with Engall Castle Ltd  
155 High Street Tewkesbury Gloucestershire GL20 5JP  
Office hours: Mon – Fri 9am to 5.30pm, Sat 9am to 2pm  
email: [sales@engallcastle.com](mailto:sales@engallcastle.com)

**01684 293 246**  
**[www.engallcastle.com](http://www.engallcastle.com)**



## Agents Note

These property details are set out as a general outline only and do not constitute any part of an Offer or Contract. Any services equipment, fittings or central heating systems have not been tested and no warranty is given or implied by Engall Castle Ltd that these are in working order. Buyers are advised to obtain verification from their solicitor or surveyor. Fixtures and fittings or other items are not included unless specifically described. All measurements, distances and areas are approximate and for guidance only and should not be relied upon for the purposes of fitting carpets or furniture etc. These property details and all statements within this document are provided without responsibility on behalf of Engall Castle Ltd or its employees or representatives and should not be relied on as statements of fact. Prospective purchasers must satisfy themselves as to the accuracy of all details pertaining to the property.



