



Watlands View,  
Porthill



**OneAgency**

01782 970222

[hello@oneagencygroup.co.uk](mailto:hello@oneagencygroup.co.uk)



£120,000

A fore-courted mid terrace house, offering spacious accommodation. The property is located in the popular residential location of Porthill, close to Newcastle-under-Lyme town centre and access to the A34. The property is considered ideal for both landlords and owner occupiers.





### Living Room

5.76m max into bay x 3.64m max(18' 11" x 11' 11") Double glazed window to front, radiator

### Dining Room

3.97m max x 2.78m (13' 0" x 9' 1") Double glazed window to rear, radiator, stairs to 1st floor, under the stairs storage

### Kitchen

3.63m x 2.09m (11' 11" x 6' 10") Fitted range of storage units, stainless steel sink and drainer unit, double glazed window to side, radiator.

### Rear Lobby

Door to side, built in storage area with boiler



### Bathroom

2.35m x 1.95m (7' 9" x 6' 5") White bathroom suite comprising of panelled bath with shower attachment, WC and hand wash basin, radiator, tiled walls

### First Floor

#### Bedroom 1

3.95m x 3.67m (13' 0" x 12' 0") double glazed window to front, radiator

#### Bedroom 2

2.49m x 2.69m (8' 2" x 8' 10") Double glazed window to rear, radiator.

### Outside

Rear Yard.

### Agents Notes

Newcastle-under-Lyme  
Council Tax Band A

Borough

GROUND FLOOR

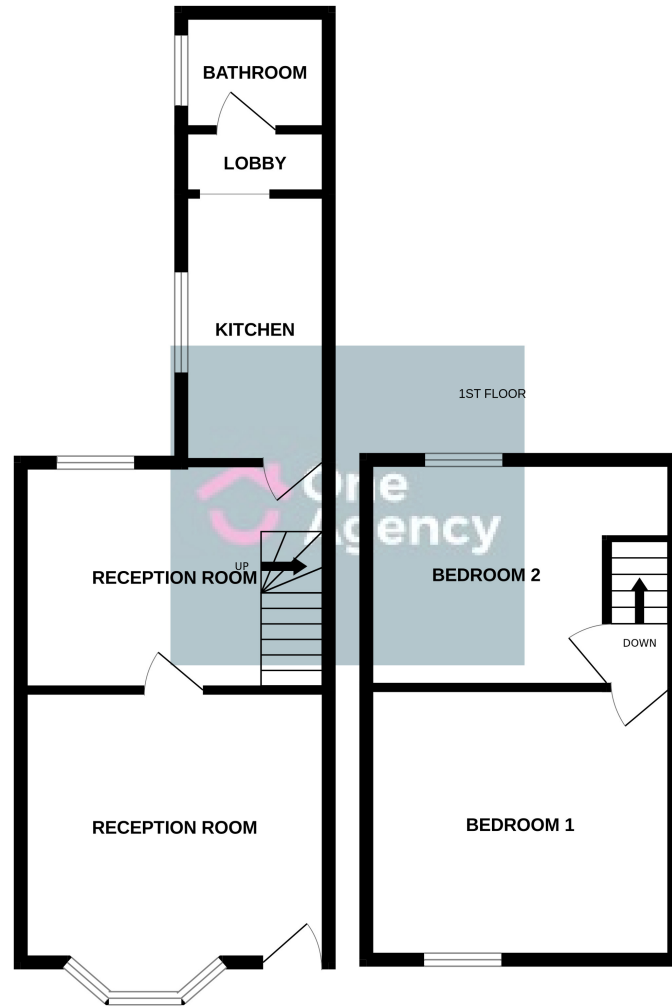

Whilst every attempt has been made to ensure the accuracy of the floorplan contained here, measurements of doors, windows, rooms and any other items are approximate and no responsibility is taken for any error, omission or mis-statement. This plan is for illustrative purposes only and should be used as such by any prospective purchaser. The services, systems and appliances shown have not been tested and no guarantee as to their operability or efficiency can be given.  
Made with Metropix ©2024

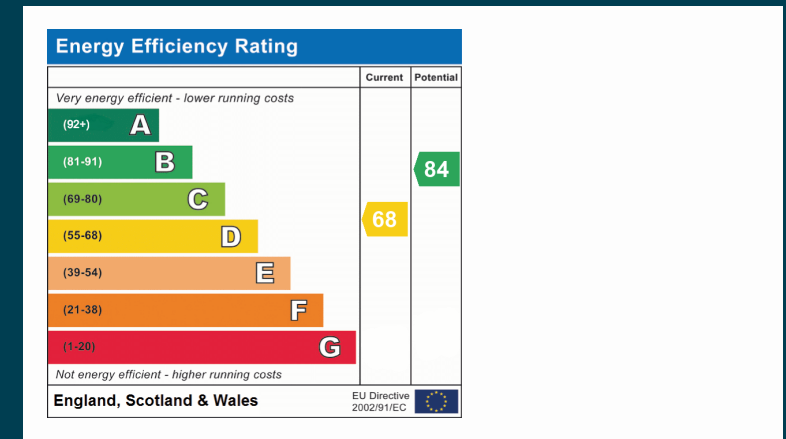

OneAgency, 9 & 10 Ridge House Drive, Festival Park, Stoke-on-Trent, ST1 5SJ

01782 970222

hello@oneagencygroup.co.uk

Every attempt has been made to ensure accuracy, however, all measurements are approximate and for illustrative purposes only. **Not to scale.**

In accordance with The Consumer Protection from Unfair Trading Regulations 2008 the following particulars have been prepared in good faith and they are not intended to constitute part of an offer or contract. We have not carried out a structural survey and the services, appliances and specific fittings have not been tested. All photographs, measurements, floor plans and distances referred to are given as a guide only and should not be relied upon for the purchase of carpets or any other fixtures and fittings. Lease details, service charges and ground rent (where applicable) are given as a guide only and should be checked and confirmed by your Solicitor prior to exchange of contracts.