



18 Dereham Road, Pudding Norton
Guide Price £180,000

BELTON DUFFEY

18 DEREHAM ROAD, PUDDING NORTON, NORFOLK, NR21 7NA

Requiring refurbishment, a 3 bedroom semi detached house with a good sized south westerly facing rear garden. No onward chain.

DESCRIPTION

18 Dereham Road is a rare renovation opportunity situated on the outskirts of the rural village of Pudding Norton and less than a 15 minute walk to the centre of the nearby market town of Fakenham. The property does now require a complete programme of refurbishment with accommodation comprising an entrance lobby, sitting room, kitchen/diner with a walk-in pantry and a rear porch. Upstairs, there are 3 bedrooms and a bathroom.

Further benefits include countryside views to the rear, original pine 4 panel internal doors and period fireplaces. Outside, there is a lawned front garden with a good sized south westerly facing rear garden with a brick built outbuilding and WC. On street parking is available outside the property on Dereham Road.

Offered for sale with no onward chain, once refurbished 18 Dereham Road would make an ideal home for a single person, couple or a small family in a pleasant rural location yet close to all of the amenities on offer in Fakenham.



SITUATION

The village of Pudding Norton borders the river Wensum and is within 1 1/2 miles of the market town of Fakenham to the north. Pudding Norton comprises some 1,400 acres of predominantly farmland and includes Fakenham Racecourse.

Fakenham is often referred to as the “gateway” to North Norfolk being only a short drive to the beautiful North Norfolk coastline some 11 miles away. Once renowned for its successful printing industry, Fakenham is now better known for Norfolk’s only National Hunt racecourse and its popular weekly markets. Fakenham boasts several supermarkets, library, doctors’ and dentists’ surgeries, a good selection of restaurants, bowling alley, cinema and infants’, junior and high school with 6th form college. Surrounding areas are all well serviced by bus routes with direct rail links to Cambridge and London from King’s Lynn and Norwich.

ENTRANCE LOBBY

A partly glazed composite door with a storm porch over leads from the garden to the front of the property into the entrance lobby with a staircase leading up to the first floor landing. Door leading into:

SITTING ROOM

4.90m x 3.70m (16' 1" x 12' 2")

Original corner fireplace, understairs storage cupboard, 2 windows overlooking the front garden and a door leading into:

KITCHEN/DINER

4.42m x 2.82m (14' 6" x 9' 3")

Range of fitted base and wall units with laminate worktops incorporating a stainless steel sink unit. Tiled fireplace with a fitted cupboard to the side, hot water cylinder, window overlooking the rear garden and a door to the rear porch. Door leading into:

PANTRY

2.84m x 1.28m (9' 4" x 4' 2")

Walk-in pantry cupboard with a window to the side.

REAR PORCH

1.67m x 0.83m (5' 6" x 2' 9")

Timber built rear porch with 2 windows and a timber door leading outside to the rear garden.

FIRST FLOOR LANDING

Window to the side, loft hatch and doors to the 3 bedrooms and bathroom.



BEDROOM 1

4.40m x 2.82m (14' 5" x 9' 3")

Original corner fireplace and a window overlooking the rear garden and countryside beyond.

BEDROOM 2

3.75m x 2.60m (12' 4" x 8' 6")

Original corner fireplace and a window to the front.

BEDROOM 3

2.79m x 2.21m (9' 2" x 7' 3")

Built-in storage cupboard and a window to the front.

BATHROOM

2.84m x 1.29m (9' 4" x 4' 3")

A white suite comprising a bath, wall mounted wash basin and WC. Window to the rear.

OUTSIDE

Number 18 is set back from Dereham Road behind a lawned front garden with well stocked shrub borders and a concrete pathway leading to the front entrance door. On street parking is available outside the property.

A gravelled pathway to the side of property leads to a tall metal pedestrian gate opening onto the rear garden. The garden is south westerly facing and is of a good size but is in an overgrown state. Access to the brick built outbuilding and outside WC.

OUTBUILDING

2.14m x 1.50m (7' 0" x 4' 11")

Brick built outbuilding attached to the rear of the house.

OUTSIDE WC

1.53m x 0.76m (5' 0" x 2' 6")

WC

DIRECTIONS

Leave Fakenham on the B1146 heading south east towards Dereham. Enter the village of Pudding Norton where you will see the property a little further up on the right-hand side, as indicated by the Belton Duffey 'For Sale' board.

OTHER INFORMATION

Mains water, mains drainage and mains electricity. Please note that this property does not have any central heating installed. EPC Rating Band G.

North Norfolk District Council, Holt Road, Cromer, Norfolk, NR27 9EN. Council Tax Band B.

TENURE

This property is for sale Freehold.

VIEWING

Strictly by appointment with the agent.



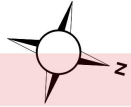

Ground Floor

Approx. 45.9 sq. metres (494.2 sq. feet)

First Floor

Approx. 38.4 sq. metres (413.3 sq. feet)

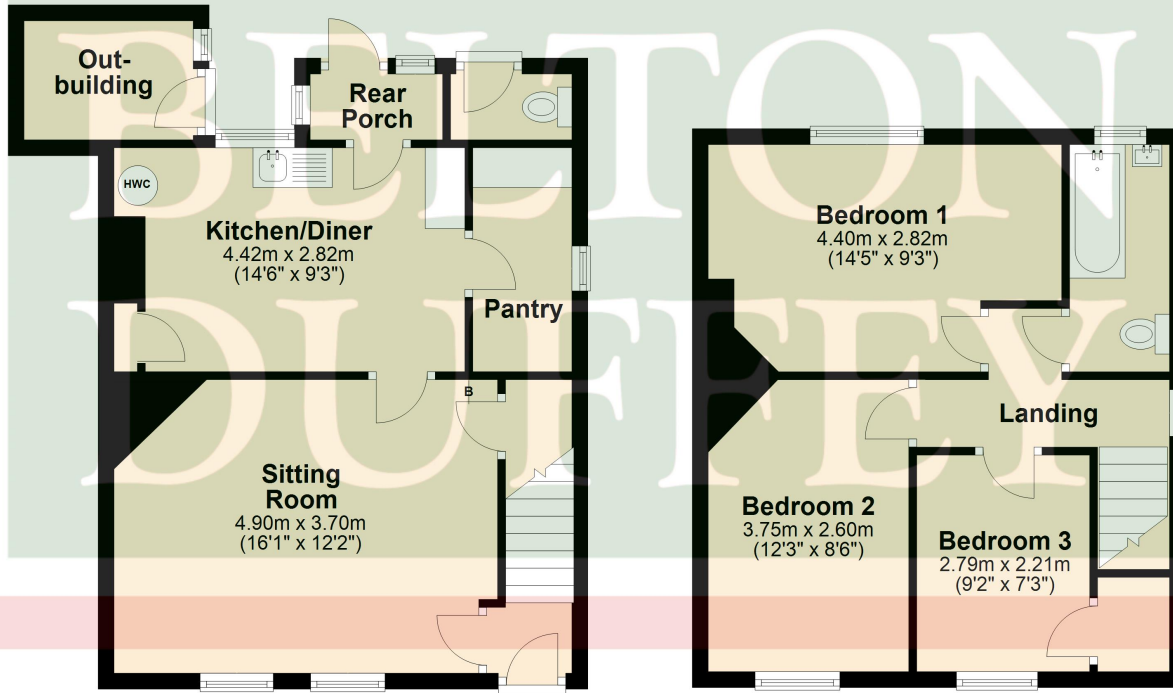

Total area: approx. 84.3 sq. metres (907.5 sq. feet)





BELTON DUFFEY

12-16 Blackfriars Street,
King's Lynn,
Norfolk, PE30 1NN.
T: 01553 770055
E: info@beltonduffey.com

3 Market Place,
Fakenham,
Norfolk, NR21 9AS.
T: 01328 855899
E: fakenham@beltonduffey.com

26 Staithe Street,
Wells-next-the-Sea,
Norfolk, NR23 1AF.
T: 01328 710666
E: wells@beltonduffey.com

www.beltonduffey.com

IMPORTANT NOTICES: 1. Whilst these particulars have been prepared in good faith to give a fair description of the property, these do not form any part of any offer or contract nor may they be regarded as statements of representation of fact. 2. Belton Duffey have not carried out a detailed survey, nor tested the services, appliances and specific fittings. All measurements or distances given are approximate only. 3. No person in the employment of Belton Duffey has the authority to make or give representation or warranty in respect of this property. Any interested parties must satisfy themselves by inspection or otherwise as to the correctness of any information given.

