



Parr's Way, London, W6 9LH

Cow & Co
LONDON



This contemporary apartment is set on the first floor of Brunswick House, part of the riverside Fulham Reach development close to the amenities of Hammersmith.

The development is brilliantly situated within a short walk of Hammersmith (Circle, District, Piccadilly, and Hammersmith & City lines) Underground station, which is very well connected to most parts of the capital. The development offers residents access to 24-hour security, residents' gym, swimming pool, spa, golf simulator, snooker room, Cineplex, and a wine cellar.



- Available now
- Two bathrooms (one en-suite)
- Sleek contemporary style kitchen open plan to lovely living area with ample space to dine and entertain
- Bright and spacious accommodation throughout
- Fourth floor apartment
- Two well proportioned double bedrooms
- Excellent cotemporary style fixtures and fittings.
- Close to a wealth of amenities and transport links

Brunswick House, Parr's Way, London, W6

Approximate Area = 974 sq ft / 90.5 sq m

For identification only - Not to scale

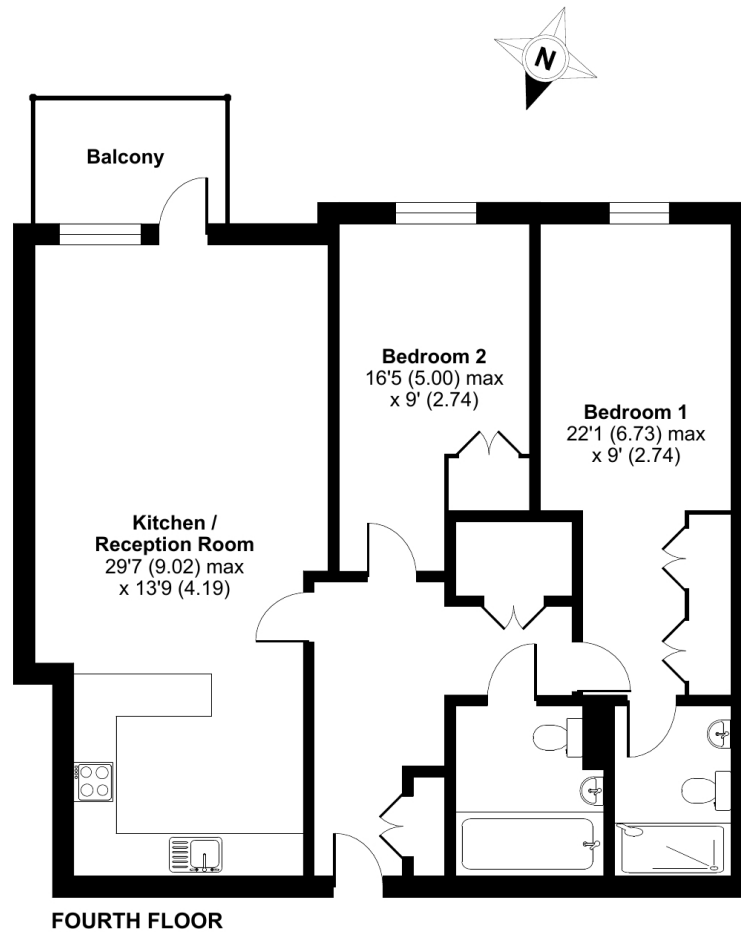

Floor plan produced in accordance with RICS Property Measurement Standards incorporating International Property Measurement Standards (IPMS2 Residential). © nchecon 2023. Produced for Cow & Co Properties Ltd. REF: 1025328

Tel: 0208 065 0010
Email: thehub@cowandco-london.com
Web: cowandco-london.com

Agents note: All measurements are approximate and whilst every attempt has been made to ensure accuracy they are for general guidance only and must not be relied on. The fixture and fittings referred to have not been tested and therefore no guarantee can be given that they are in working order. Internal photographs are reproduced for general information and it must not be inferred that any item shown is included with the property.

Cow & Co
LONDON