



16 Grange Place, Laleham Village, Staines-Upon-Thames, Surrey. TW18 1RY.
3 Bedroom Terraced House - £450,000 Freehold

16 Grange Place, Laleham Village, Staines- Upon-Thames, Surrey. TW18 1RY.

01784 451458

3 Bedroom Terraced House - £450,000 Freehold

WELL PRESENTED AND SPACIOUS THREE BEDROOM PROPERTY SITUATED ALONG SOUGHT AFTER CLOSE IN THE HEART OF LALEHAM VILLAGE ENJOYING VIEWS OVER OPEN FIELDS. The property benefits from a spacious lounge, modern kitchen/diner, downstairs W.C, three well-proportioned bedrooms, modern white bathroom suite, secluded rear garden and garage. Viewings Highly Recommended!

Key Features

LOCATED IN HEART OF LALEHAM VILLAGE
VERY WELL PRESENTED THROUGHOUT
SPACIOUS ROOMS
DOWNSTAIRS W.C.
GARAGE
VIEWS OVER OPEN FIELDS
LUXURY KITCHEN & BATHROOM

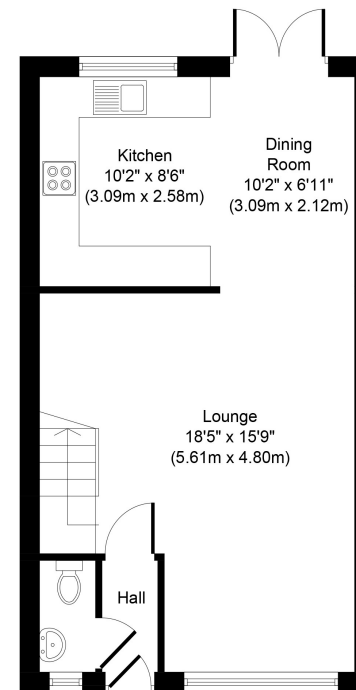

Ground Floor
Approximate Floor Area
455 Sq. ft.
(42.3 Sq. m.)

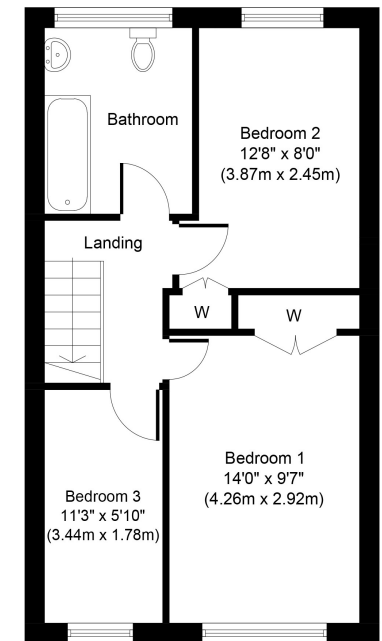

First Floor
Approximate Floor Area
455 Sq. ft.
(42.3 Sq. m.)



GREGORY BROWN
RESIDENTIAL SALES & LETTINGS





16 Grange Place, Laleham Village, Staines-Upon-Thames, Surrey. TW18 1RY.

gregory-brown.co.uk

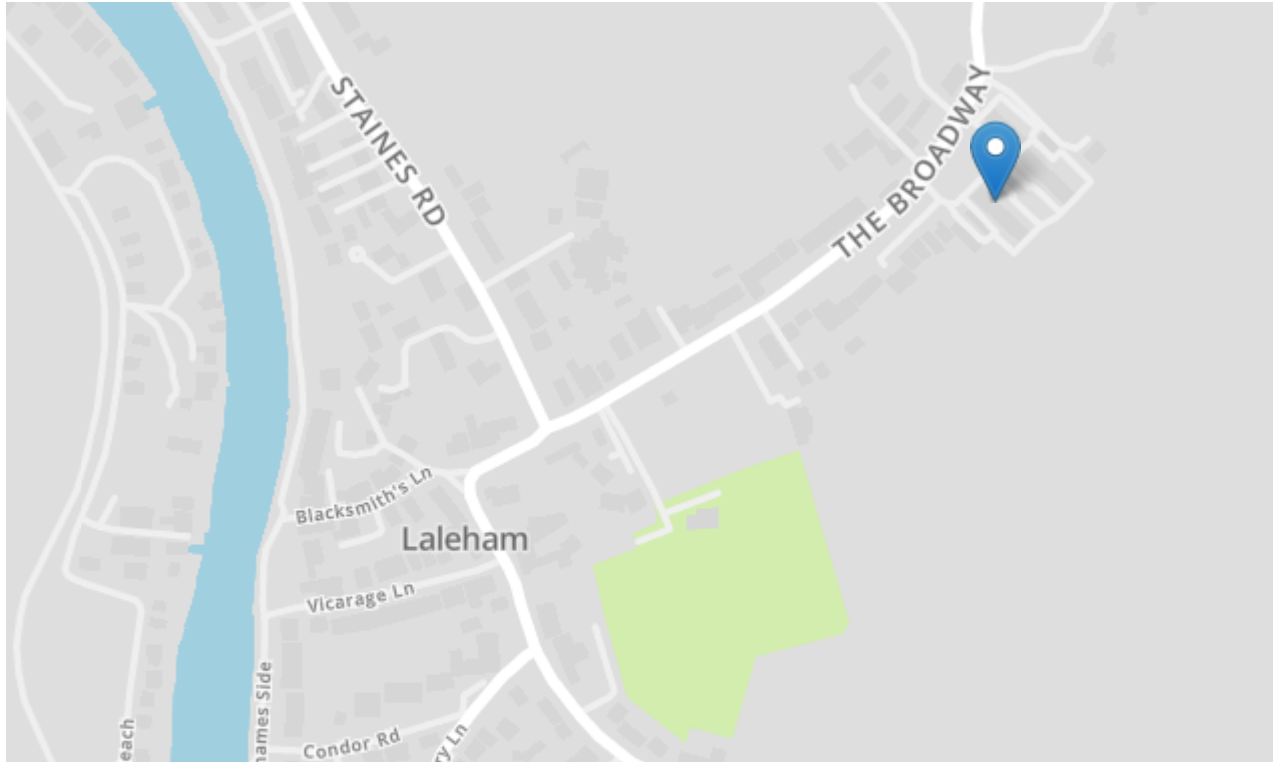

Tenure **Freehold**
Lease Term
Ground Rent
Service Charge
Local Authority
Council Tax

We have prepared these property particulars as a general guide to a broad description of the property. They are not intended to constitute part of an offer or contract. We have not carried out a structural survey and the services, appliances and specific fittings have not been tested. All photographs, measurements, floorplans and distances referred to are given as a guide only and should not be relied upon for the purchase of carpets or any other fixtures or fittings. Lease details, service charges and ground rents (where applicable) and council tax are given as a guide only and should be checked and confirmed by your solicitor prior to exchange of contracts. The copyright of all details, photographs and floorplans remain exclusive to Gregory Brown.

